

F.A.I. RTE.	SECTION	COUNTY	TOTAL SHEETS	SHEET NO.
94	94*	COOK	860	88
STA. 2200+00.00 TO STA. 2362+00.00				
FED. ROAD DIST. NO.		ILLINOIS	FED. AID PROJECT	
* (1516.1, 1717 & 1818) R-8		62694		

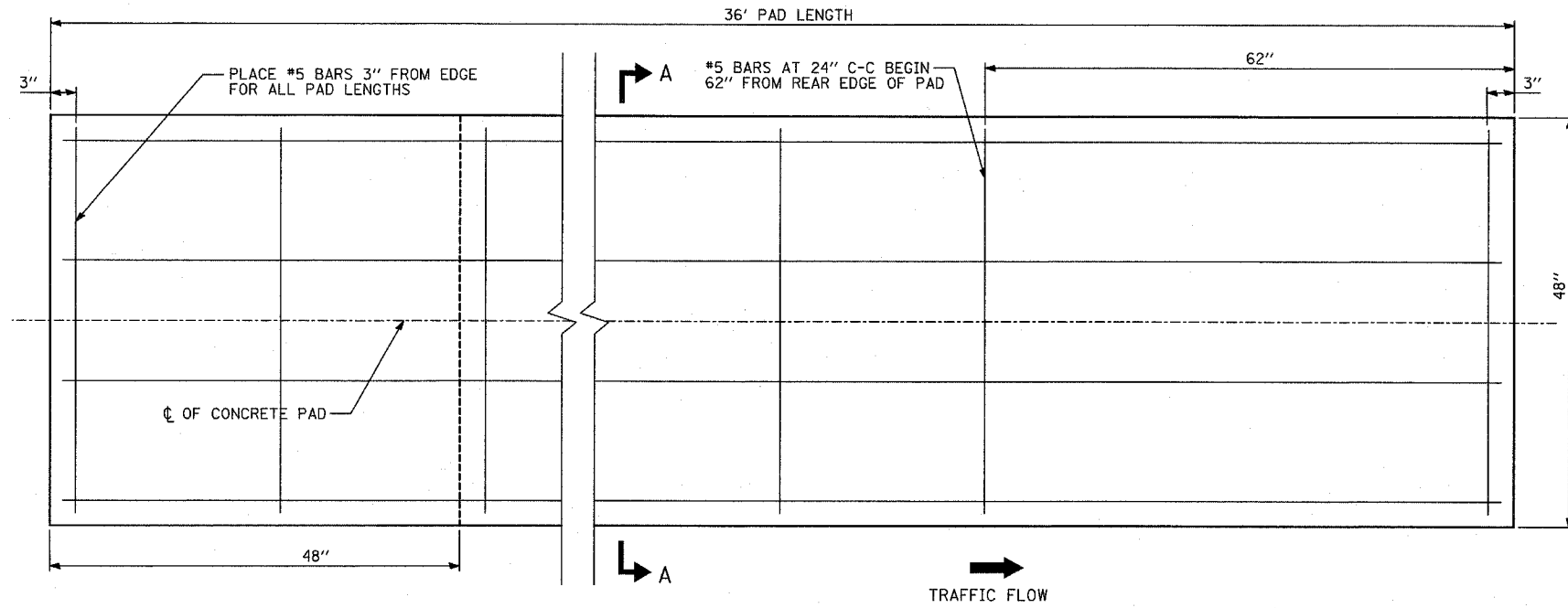

TYPICAL CONCRETE PAD PLAN VIEW

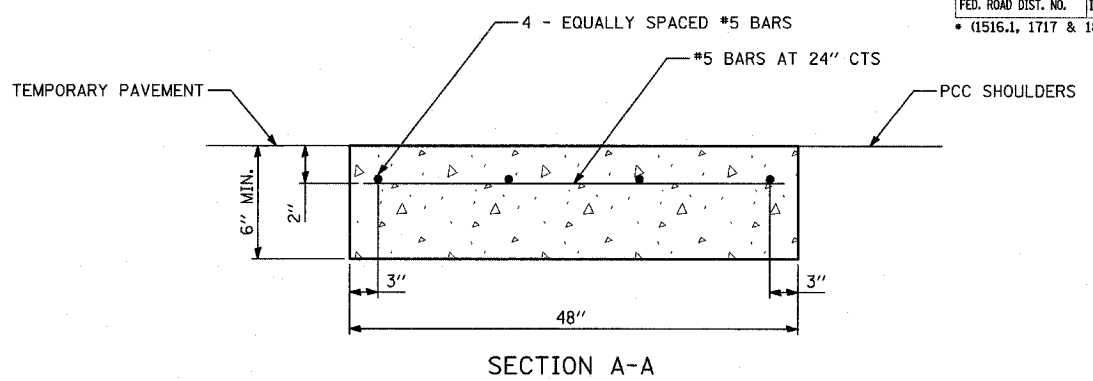

SECTION A-A

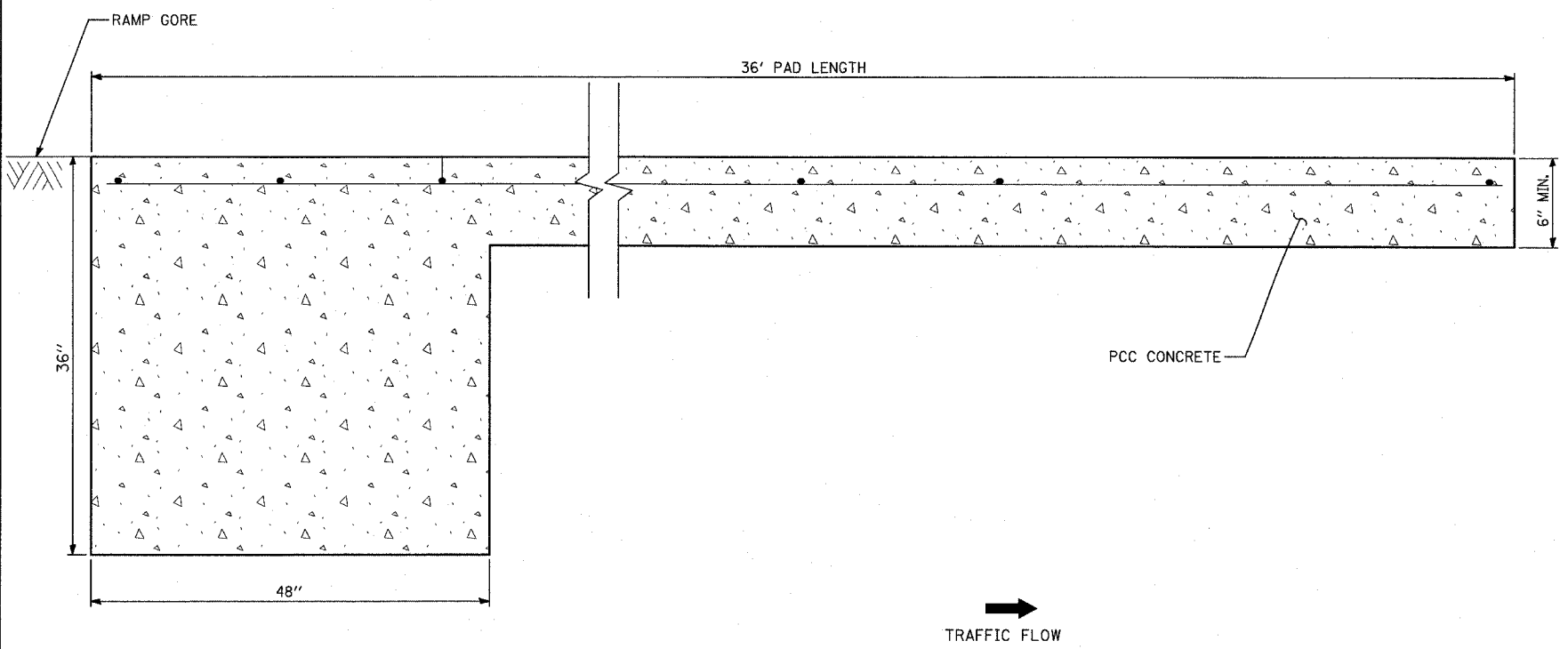

TYPICAL CONCRETE PAD ELEVATION VIEW

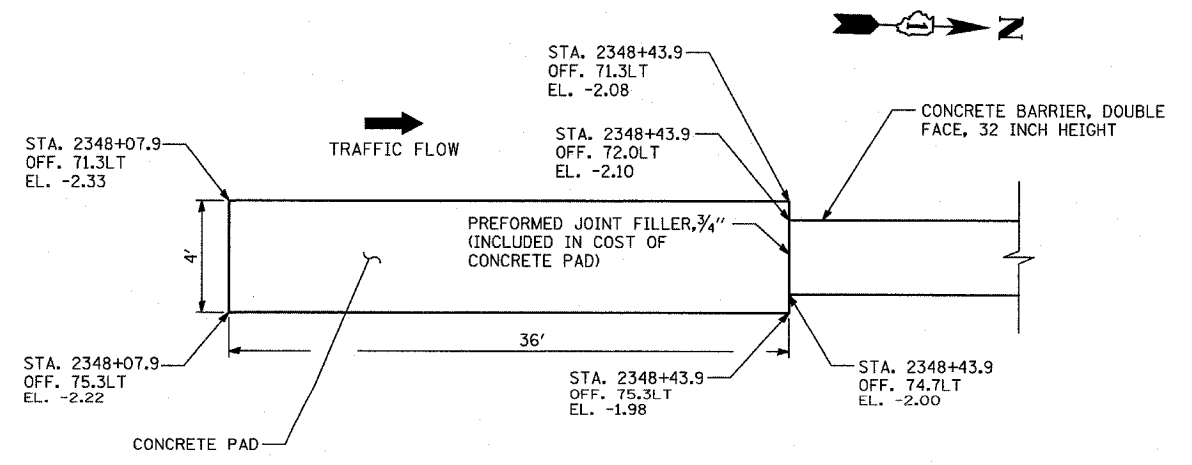

CONCRETE PAD NB I-94 @ 75th-71st ST C-D RAMP: PLAN VIEW

NOTE: CONCRETE PAD DRAWING INCLUDED FOR INFORMATIONAL PURPOSES ONLY. THE PAD FOR AN 11 BAY QUADGUARD ELITE SYSTEM IS DEPICTED. EXACT DIMENSIONS MUST COMPLY WITH THE MANUFACTURER'S REQUIREMENTS FOR SPECIFIED PAY ITEM: IMPACT ATTENUATOR (SEVERE USE, NARROW) TEST LEVEL 3

TYLIN INTERNATIONAL

REVISIONS	
NAME	DATE

ILLINOIS DEPARTMENT OF TRANSPORTATION
 F.A.I. 94 (DAN RYAN EXPRESSWAY)
 DETAIL OF CONCRETE PAD
 FOR IMPACT ATTENUATOR (SEVERE
 USE, NARROW) TEST LEVEL 3
 SCALE: NONE
 DATE: MARCH 18, 2005
 DRAWN BY: MB
 CHECKED BY: JPM

P:\02-31-3\road\11\main\11-02-30.dgn
 03/25/2005 10:44:07 AM