

F.A.I. RTE.	SECTION	COUNTY	TOTAL SHEETS	SHEET NO.
94		COOK	860	126
STA. 2200+00.00 TO STA. 2362+00.00				
FED. ROAD DIST. NO.	ILLINOIS	FED. AID PROJECT		
* (1516.1, 1717 & 1818) R-8		62694		

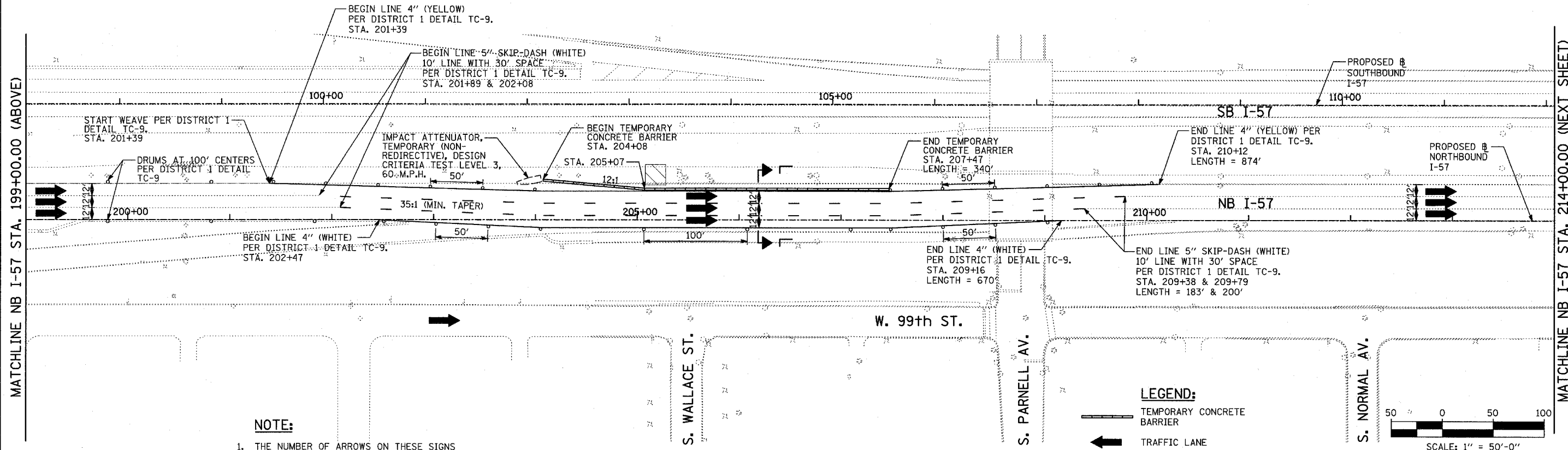
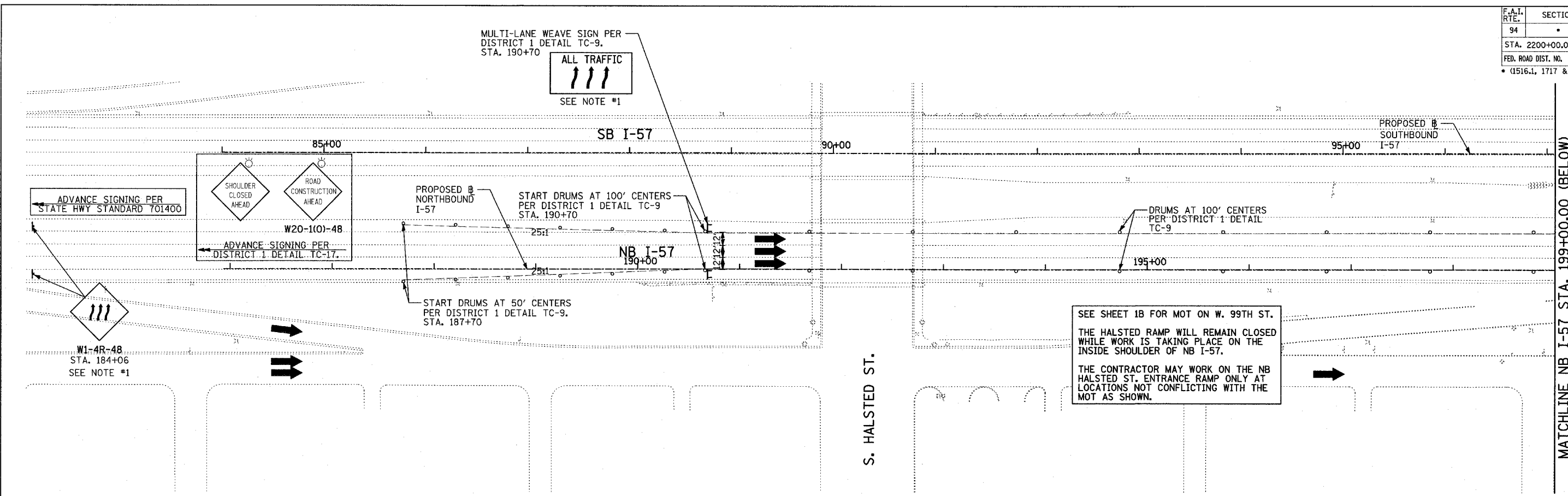

**NOTE:**

1. THE NUMBER OF ARROWS ON THESE SIGNS SHALL MATCH THE NUMBER OF LANES OPEN TO TRAFFIC.

- LEGEND:**
- TEMPORARY CONCRETE BARRIER
  - TRAFFIC LANE
  - WORK ZONE
  - BARRICADE, TYPE III
  - DRUM WITH MONO-DIRECTIONAL STEADY BURNING LIGHT
  - ARROW BOARD

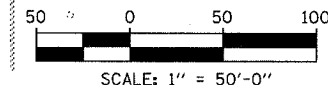

REVISIONS	
NAME	DATE

ILLINOIS DEPARTMENT OF TRANSPORTATION  
F.A.I. 94 (DAN RYAN EXPRESSWAY)  
MAINTENANCE OF TRAFFIC PLAN  
STAGE 1 - NB I-94  
NB I-57 STA. 184+00.00 TO 214+00.00  
SHEET 1A OF 11  
SCALE: 1"=50'-0"  
DATE: MARCH 18, 2005  
DRAWN BY: RTM  
CHECKED BY: JPA

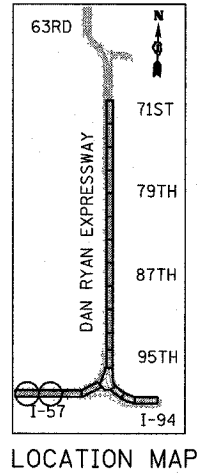

TYLIN INTERNATIONAL

03/25/2005 10:35:43 AM