

F.A.I. RTE.	SECTION	COUNTY	TOTAL SHEETS	SHEET NO.
94		COOK	860	142
STA. 2200+00.00 TO STA. 2362+00.00				
FED. ROAD DIST. NO. ILLINOIS		FED. AID PROJECT		
* (1516.1, 1717 & 1818) R-8		62694		

MATCHLINE NB I-94 STA. 2280+00.00 (PREV. SHEET)

MATCHLINE NB I-94 STA. 2295+00.00 (BELOW)

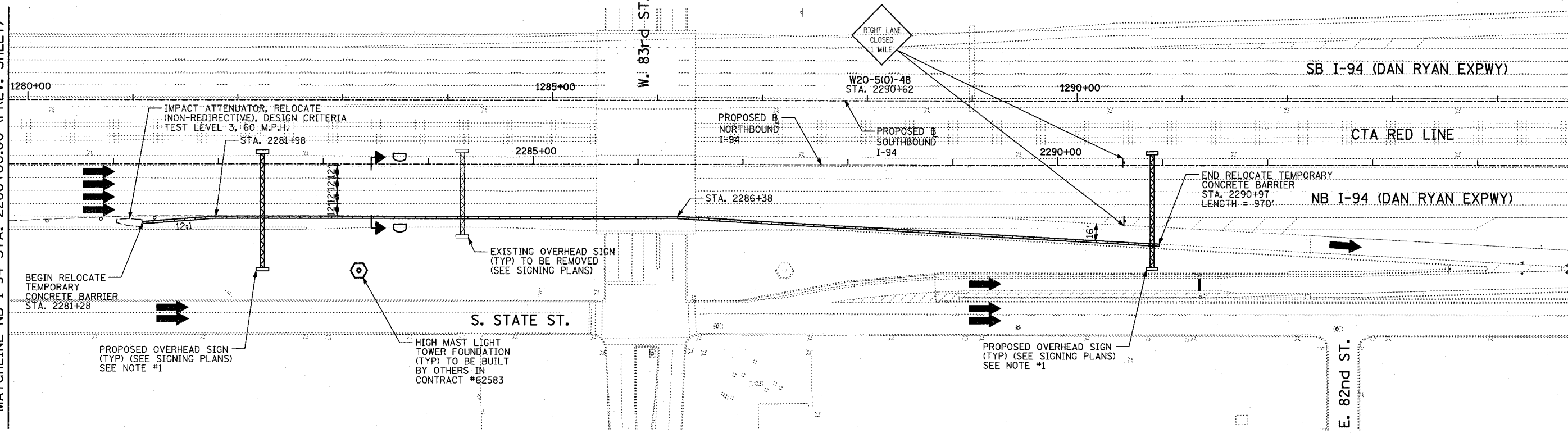

MATCHLINE NB I-94 STA. 2295+00.00 (ABOVE)

MATCHLINE NB I-94 STA. 2310+00.00 (NEXT SHEET)

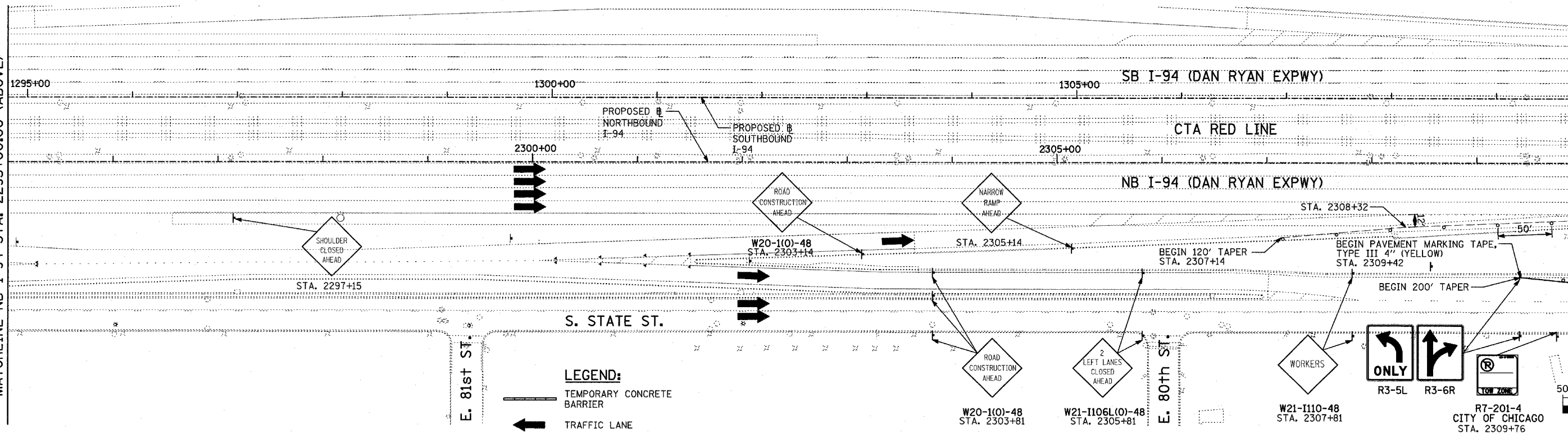

- LEGEND:**
- TEMPORARY CONCRETE BARRIER
 - TRAFFIC LANE
 - WORK ZONE
 - BARRICADE, TYPE III
 - DRUM WITH MONO-DIRECTIONAL STEADY BURNING LIGHT
 - ARROW BOARD

- NOTES:**
- SEE MOT DETAILS FOR LANE NARROWING REQUIRED TO ALLOW SIGN WORK WITHIN THE INSIDE SHOULDER.

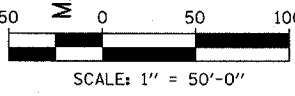
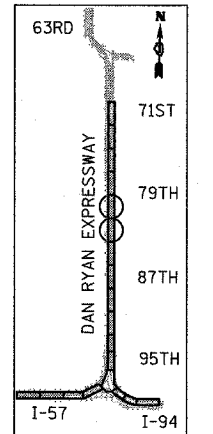

REVISIONS	
NAME	DATE

ILLINOIS DEPARTMENT OF TRANSPORTATION
 F.A.I. 94 (DAN RYAN EXPRESSWAY)
 MAINTENANCE OF TRAFFIC PLAN
 STAGE 2 - NB I-94
 NB I-94 STA. 2280+00.00 TO 2310+00.00
 SHEET 6 OF 8
 SCALE: 1"=50'-0"
 DATE: MARCH 18, 2005
 DRAWN BY: RTM
 CHECKED BY: JPA

TYLIN INTERNATIONAL

03/25/2005 11:49:16 AM