

F.A.I. RTE.	SECTION	COUNTY	TOTAL SHEETS	SHEET NO.
94	*	COOK	860	149
STA. 2200+00.00 TO STA. 2362+00.00				
FED. ROAD DIST. NO.		ILLINOIS	FED. AID PROJECT	
* (1516.L, 1717 & 1818) R-8		62694		

- NOTES:**
- SIGN TO BE REMOVED, SEE REMOVAL SIGNING SCHEDULE FOR QUANTITIES. EXISTING SIGN SHALL REMAIN IN PLACE UNTIL NEW CORRESPONDING SIGN OR SIGN INFORMATION IS FULLY INSTALLED. SEE PROPOSED SIGNING SHEETS.
 - SIGN PANEL OVERLAY USED ON EXISTING EXIT GUIDE SIGN SHALL CORRESPOND TO NEW OVERLAY ON PROPOSED SIGN. COST SHALL BE INCLUDED IN TRAFFIC CONTROL AND PROTECTION (EXPRESSWAYS) UNLESS OTHERWISE INDICATED.
 - SIGN PANEL OVERLAY ON EXIT GUIDE SIGNS TO BE REMOVED AFTER DESIGNATED RAMP HAS BEEN OPENED. COST SHALL BE INCLUDED IN TRAFFIC CONTROL AND PROTECTION (EXPRESSWAYS) UNLESS OTHERWISE INDICATED.
 - PROPOSED DETOUR TRAILBLAZER TO BE REMOVED AFTER APPROPRIATE ENTRANCE RAMP HAS BEEN OPENED. COST SHALL BE INCLUDED IN TEMPORARY INFORMATION SIGNING. SEE SHEET 1 OF STAGE 1 CONSTRUCTION SIGNING PLANS FOR TRAILBLAZER SIZE.
- "RAMP CLOSED" SIGN PANEL OVERLAYS SHALL BE ADJUSTED IF EXISTING SIGN PANELS ARE LESS THAN 10'.



SIGNING LEGEND:

- EXISTING GROUND MOUNTED SIGN
- EXISTING OVERHEAD TRUSS MOUNTED SIGN
- EXISTING OVERHEAD CANTILEVER MOUNTED SIGN
- PROPOSED GROUND MOUNTED SIGN
- PROPOSED OVERHEAD SIGN STRUCTURE - TRUSS
- PROPOSED OVERHEAD SIGN STRUCTURE - BRIDGE MOUNTED
- PROPOSED OVERHEAD SIGN STRUCTURE - CANTILEVER
- CONSTRUCTION ZONE-RAMP CLOSED
- CONSTRUCTION ZONE
- TEMPORARY TRAILBLAZER
- EXISTING SIGN
- EXISTING SIGN TO BE REMOVED
- PROPOSED SIGN

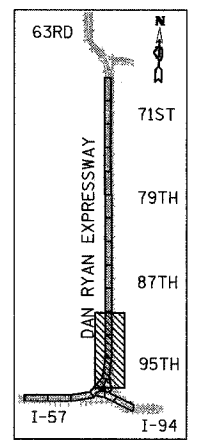

LOCATION MAP

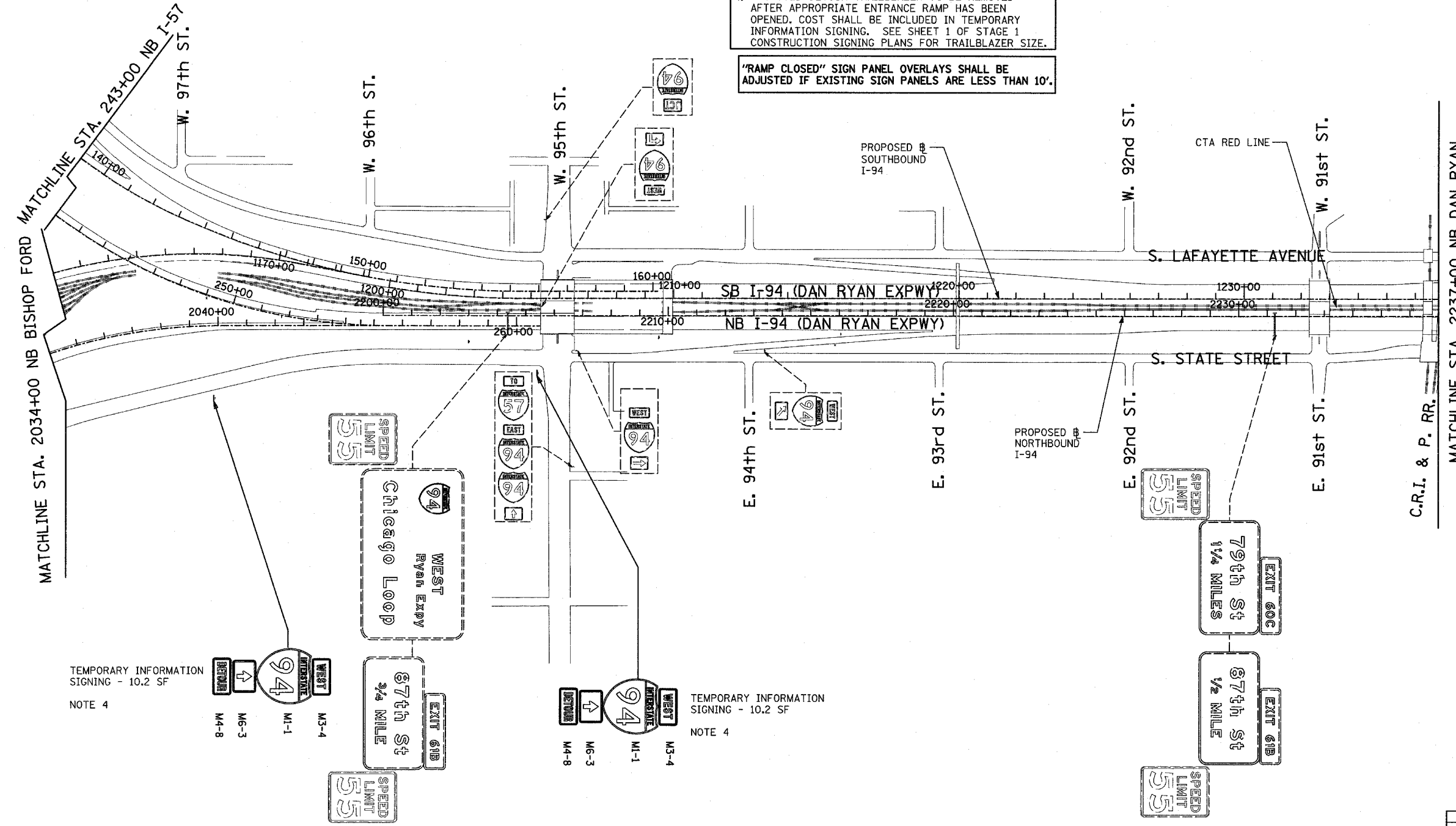

TEMPORARY INFORMATION SIGNING - 10.2 SF
NOTE 4

TEMPORARY INFORMATION SIGNING - 10.2 SF
NOTE 4

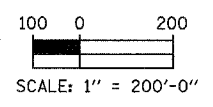

REVISIONS	
NAME	DATE

ILLINOIS DEPARTMENT OF TRANSPORTATION
F.A.I. 94 (DAN RYAN EXPRESSWAY)

CONSTRUCTION SIGNING-STAGE 1
STA. 2034+00 TO STA 2237+00
SHEET 3 OF 6

SCALE: 1" = 200'
DATE: MARCH 18, 2005

DRAWN BY: AMB
CHECKED BY: TGB