

F.A.I. RTE.	SECTION	COUNTY	TOTAL SHEETS	SHEET NO.
94		COOK	860	156
STA. 2200+00.00 TO STA. 2362+00.00				
FED. ROAD DIST. NO. ILLINOIS		FED. AID PROJECT		
		* (1516.1, 1717 & 1818) R-8		
				62694

- NOTES:**
- SIGN TO BE REMOVED, SEE REMOVAL SIGNING SCHEDULE FOR QUANTITIES. EXISTING SIGN SHALL REMAIN IN PLACE UNTIL NEW CORRESPONDING SIGN OR SIGN INFORMATION IS FULLY INSTALLED. SEE PROPOSED SIGNING SHEETS.
 - SIGN PANEL OVERLAY USED ON EXISTING EXIT GUIDE SIGN SHALL CORRESPOND TO NEW OVERLAY ON PROPOSED SIGN. COST SHALL BE INCLUDED IN TRAFFIC CONTROL AND PROTECTION (EXPRESSWAYS) UNLESS OTHERWISE INDICATED.
 - SIGN PANEL OVERLAY ON EXIT GUIDE SIGNS TO BE REMOVED AFTER DESIGNATED RAMP HAS BEEN OPENED. COST SHALL BE INCLUDED IN TRAFFIC CONTROL AND PROTECTION (EXPRESSWAYS) UNLESS OTHERWISE INDICATED.
 - PROPOSED DETOUR TRAILBLAZER TO BE REMOVED AFTER APPROPRIATE ENTRANCE RAMP HAS BEEN OPENED. COST SHALL BE INCLUDED IN TEMPORARY INFORMATION SIGNING. SEE SHEET 1 OF STAGE 1 CONSTRUCTION SIGNING PLANS FOR TRAILBLAZER SIZE.
- 'RAMP CLOSED' SIGN PANEL OVERLAYS SHALL BE ADJUSTED IF EXISTING SIGN PANELS ARE LESS THAN 10'.



SIGNING LEGEND:

- EXISTING GROUND MOUNTED SIGN
- EXISTING OVERHEAD TRUSS MOUNTED SIGN
- EXISTING OVERHEAD CANTILEVER MOUNTED SIGN
- PROPOSED GROUND MOUNTED SIGN
- PROPOSED OVERHEAD SIGN STRUCTURE - TRUSS
- PROPOSED OVERHEAD SIGN STRUCTURE - BRIDGE MOUNTED
- PROPOSED OVERHEAD SIGN STRUCTURE - CANTILEVER
- CONSTRUCTION ZONE-RAMP CLOSED
- CONSTRUCTION ZONE
- TEMPORARY TRAILBLAZER
- EXISTING SIGN
- EXISTING SIGN TO BE REMOVED
- PROPOSED SIGN

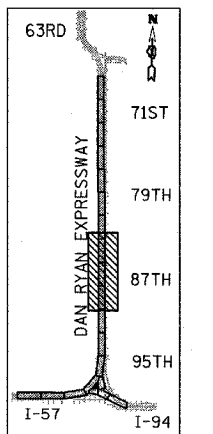

LOCATION MAP

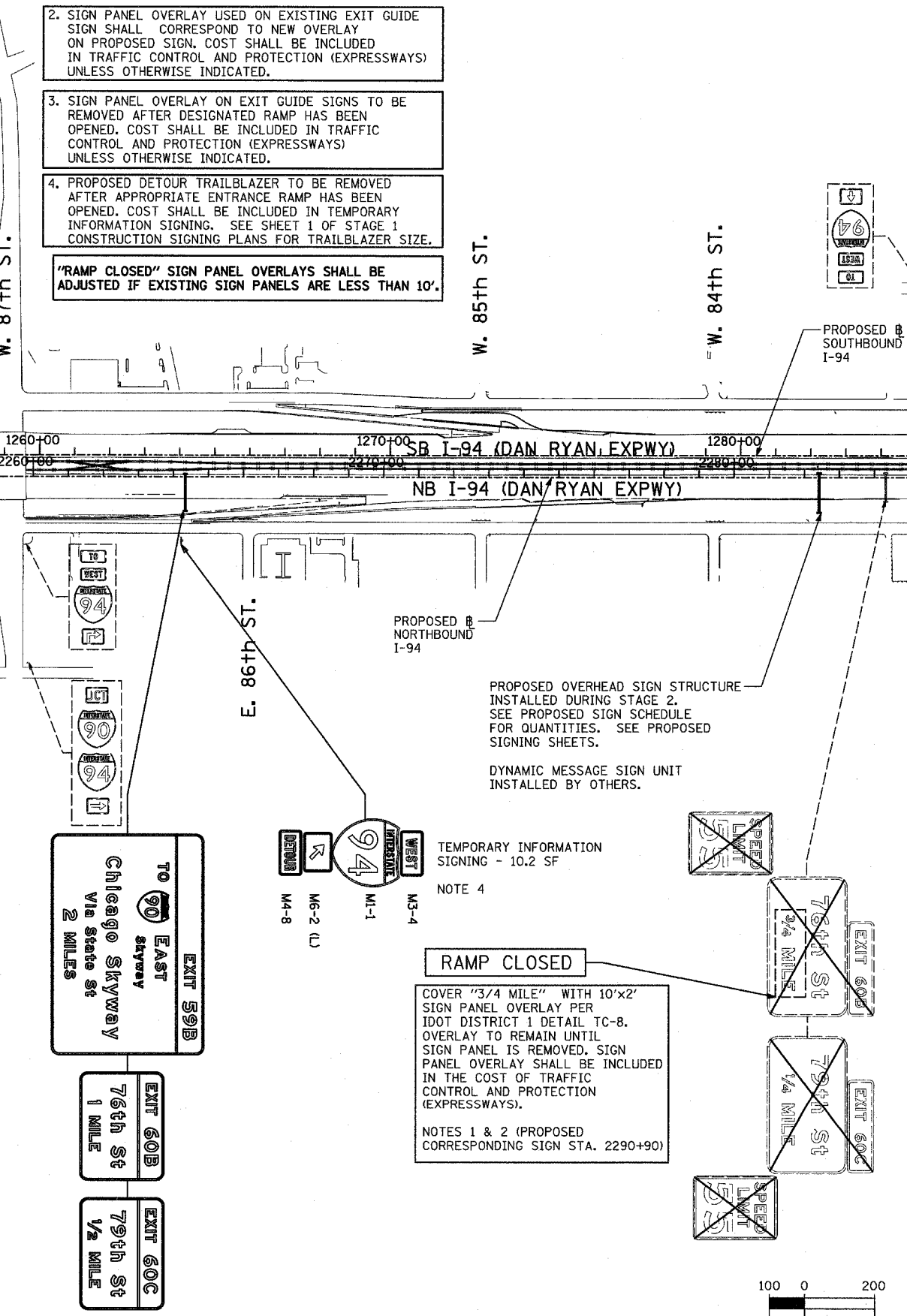
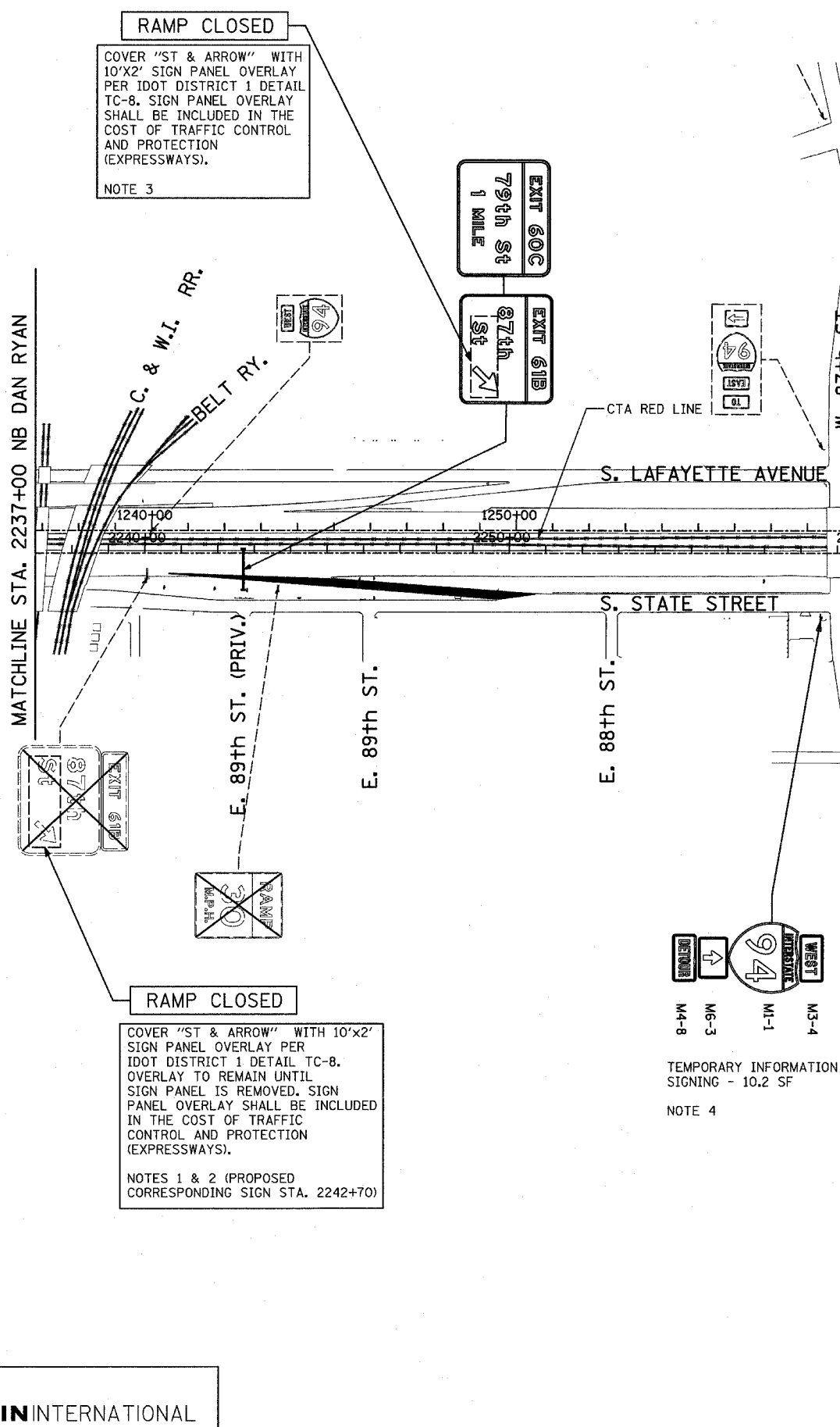

RAMP CLOSED

COVER "ST & ARROW" WITH 10'x2' SIGN PANEL OVERLAY PER IDOT DISTRICT 1 DETAIL TC-8. SIGN PANEL OVERLAY SHALL BE INCLUDED IN THE COST OF TRAFFIC CONTROL AND PROTECTION (EXPRESSWAYS).

NOTE 3

RAMP CLOSED

COVER "ST & ARROW" WITH 10'x2' SIGN PANEL OVERLAY PER IDOT DISTRICT 1 DETAIL TC-8. OVERLAY TO REMAIN UNTIL SIGN PANEL IS REMOVED. SIGN PANEL OVERLAY SHALL BE INCLUDED IN THE COST OF TRAFFIC CONTROL AND PROTECTION (EXPRESSWAYS).

NOTES 1 & 2 (PROPOSED CORRESPONDING SIGN STA. 2242+70)

TEMPORARY INFORMATION SIGNING - 10.2 SF

NOTE 4

TEMPORARY INFORMATION SIGNING - 10.2 SF

NOTE 4

RAMP CLOSED

COVER "3/4 MILE" WITH 10'x2' SIGN PANEL OVERLAY PER IDOT DISTRICT 1 DETAIL TC-8. OVERLAY TO REMAIN UNTIL SIGN PANEL IS REMOVED. SIGN PANEL OVERLAY SHALL BE INCLUDED IN THE COST OF TRAFFIC CONTROL AND PROTECTION (EXPRESSWAYS).

NOTES 1 & 2 (PROPOSED CORRESPONDING SIGN STA. 2290+90)

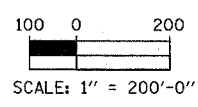

REVISIONS	
NAME	DATE

ILLINOIS DEPARTMENT OF TRANSPORTATION
F.A.I. 94 (DAN RYAN EXPRESSWAY)

CONSTRUCTION SIGNING-STAGE 2
 STA. 2237+00 TO STA 2287+00
 SHEET 4 OF 6

SCALE: 1" = 200'
 DATE: MARCH 18, 2005
 DRAWN BY: AMB
 CHECKED BY: TGB