

F.A.I. RTE.	SECTION	COUNTY	TOTAL SHEETS	SHEET NO.
94		COOK	860	171
STA. 2200+00.00		TO STA. 2362+00.00		
FED. ROAD DIST. NO.		ILLINOIS FED. AID PROJECT		
(1516.1, 1717 & 1818) R-8		62694		

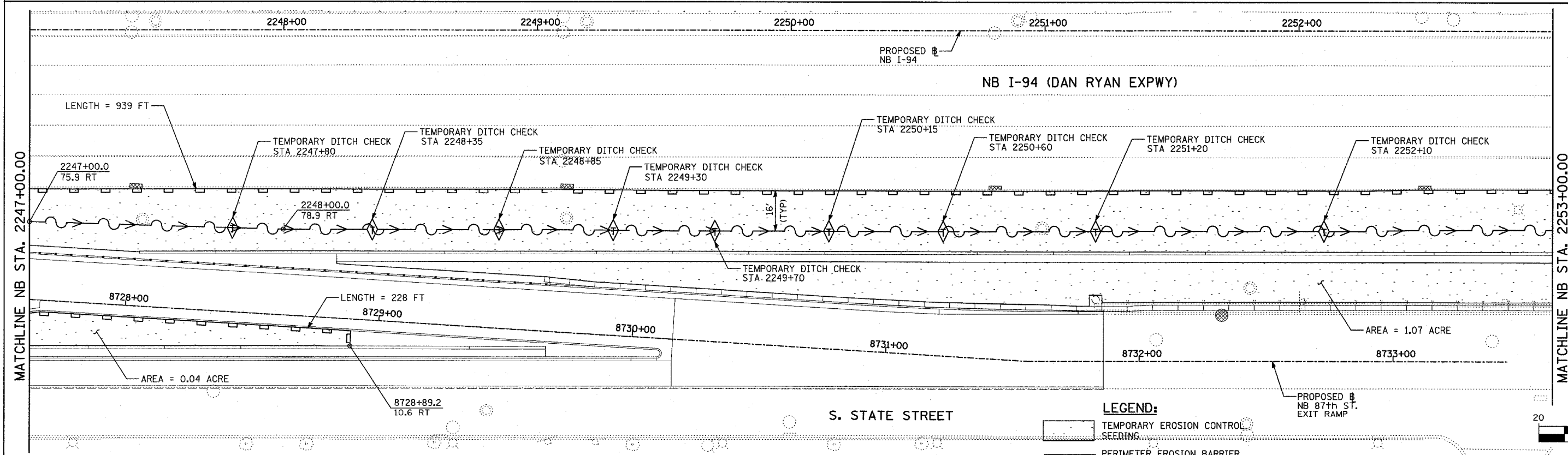

MATCHLINE NB STA. 2247+00.00

MATCHLINE NB STA. 2253+00.00

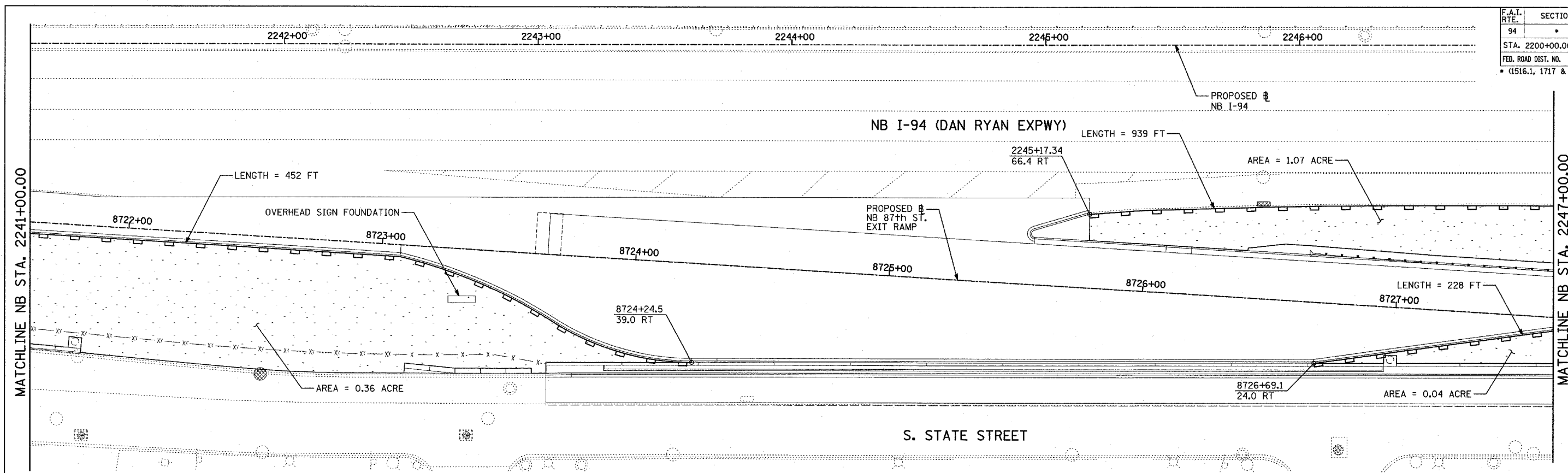
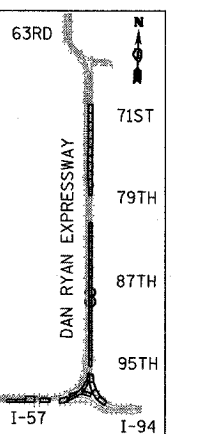

LOCATION MAP

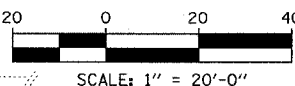

- LEGEND:**
- TEMPORARY EROSION CONTROL SEEDING
  - PERIMETER EROSION BARRIER
  - INLET FILTER, TO BE INSTALLED IN OFF PROJECT DRAINAGE STRUCTURES ACCEPTING STORMWATER RUNOFF
  - TEMPORARY FENCE
  - TEMPORARY DITCH
  - TEMPORARY DITCH CHECK
  - TEMPORARY FENCE FOR TREE PROTECTION (15 FEET PER SIDE = 60 FEET TOTAL)

REVISIONS	
NAME	DATE

ILLINOIS DEPARTMENT OF TRANSPORTATION  
**F.A.I. 94 (DAN RYAN EXPRESSWAY)**  
**EROSION CONTROL PLAN**  
**NB 87th STREET EXIT RAMP**  
**NB I-94 STA. 2241+00.00 TO 2253+00.00**

SCALE: 1"=20'  
DATE: MARCH 18, 2005

DRAWN BY: JJS  
CHECKED BY: JPM, MAG

**TYLIN INTERNATIONAL**