

F.A.I. RTE.	SECTION	COUNTY	TOTAL SHEETS	SHEET NO.
94		COOK	860	184
STA. 2200+00.00 TO STA. 2362+00.00				
FED. ROAD DIST. NO.	ILLINOIS	FED. AID PROJECT		
• (1516.1, 1717 & 1818) R-8				62694

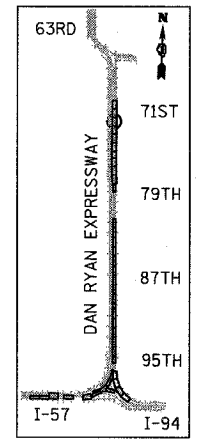

LOCATION MAP

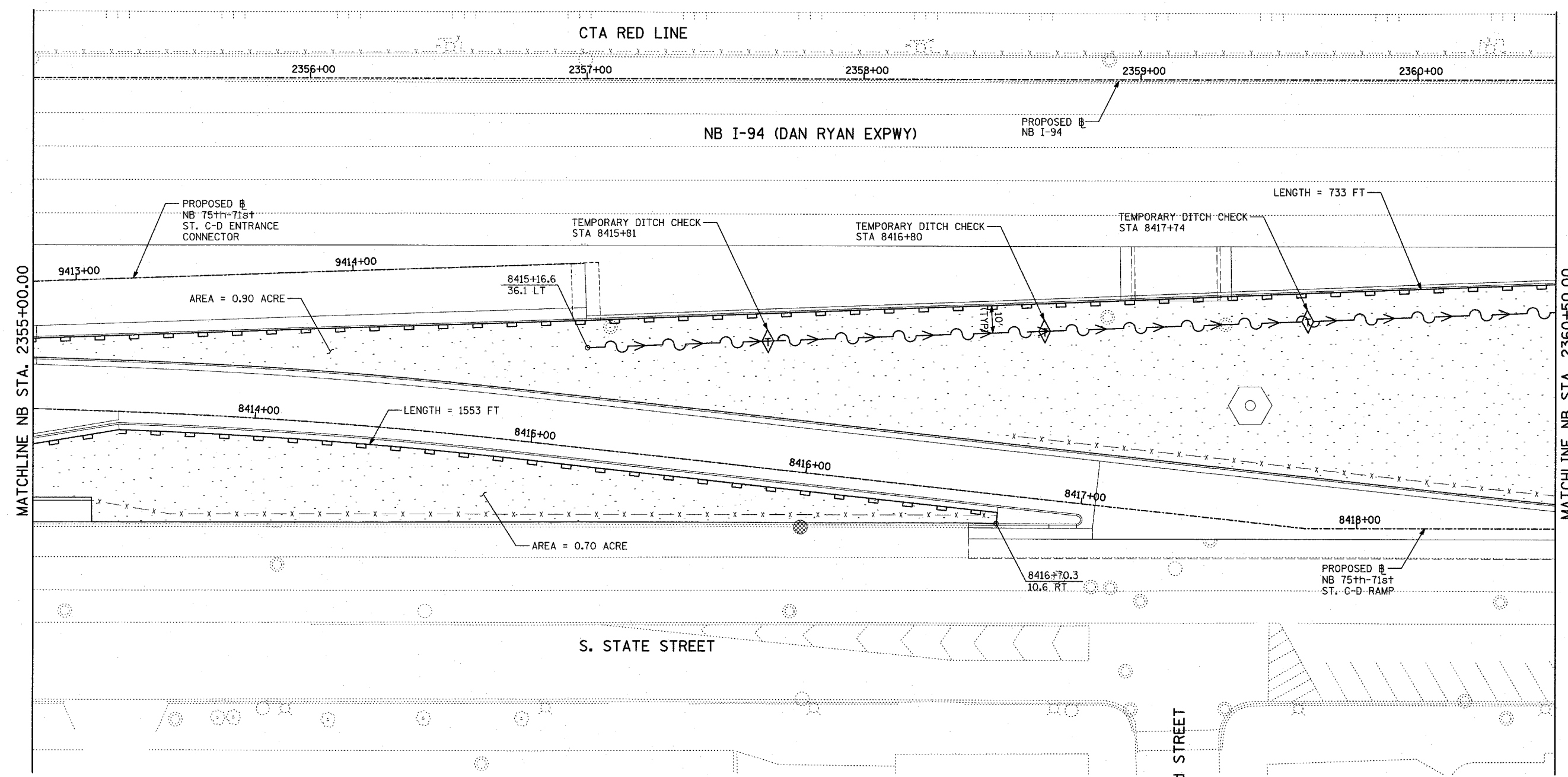
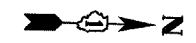
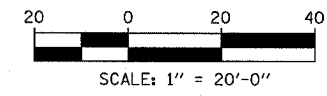

- LEGEND:**
- TEMPORARY EROSION CONTROL SEEDING
  - PERIMETER EROSION BARRIER
  - INLET FILTER, TO BE INSTALLED IN OFF PROJECT DRAINAGE STRUCTURES ACCEPTING STORMWATER RUNOFF
  - TEMPORARY FENCE
  - TEMPORARY DITCH
  - TEMPORARY DITCH CHECK
  - TEMPORARY FENCE FOR TREE PROTECTION (15 FEET PER SIDE = 60 FEET TOTAL)

REVISIONS	
NAME	DATE

ILLINOIS DEPARTMENT OF TRANSPORTATION  
 F.A.I. 94 (DAN RYAN EXPRESSWAY)  
 EROSION CONTROL PLAN  
 NB 75th TO 71st STREET C-D RAMP  
 NB I-94 STA. 2355+00.00 TO 2360+50.00

SCALE: 1"=20'  
 DATE: MARCH 18, 2005  
 DRAWN BY: JJS  
 CHECKED BY: JPM, MAG

**TYLIN** INTERNATIONAL

03/25/2005 09:33:59 PM