

F.A.I. RTE.	SECTION	COUNTY	TOTAL SHEETS	SHEET NO.
94		COOK	860	202
STA. 2200+00.00 TO STA. 2362+00.00				
FED. ROAD DIST. NO. ILLINOIS FED. AID PROJECT				
• (1516.I, 1717 & 1818) R-8 62694				

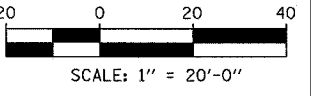
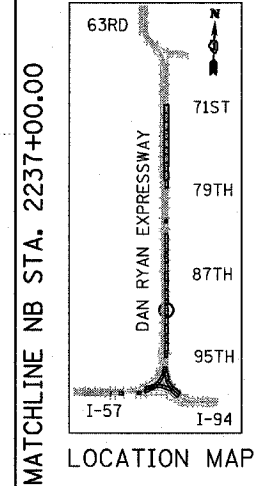
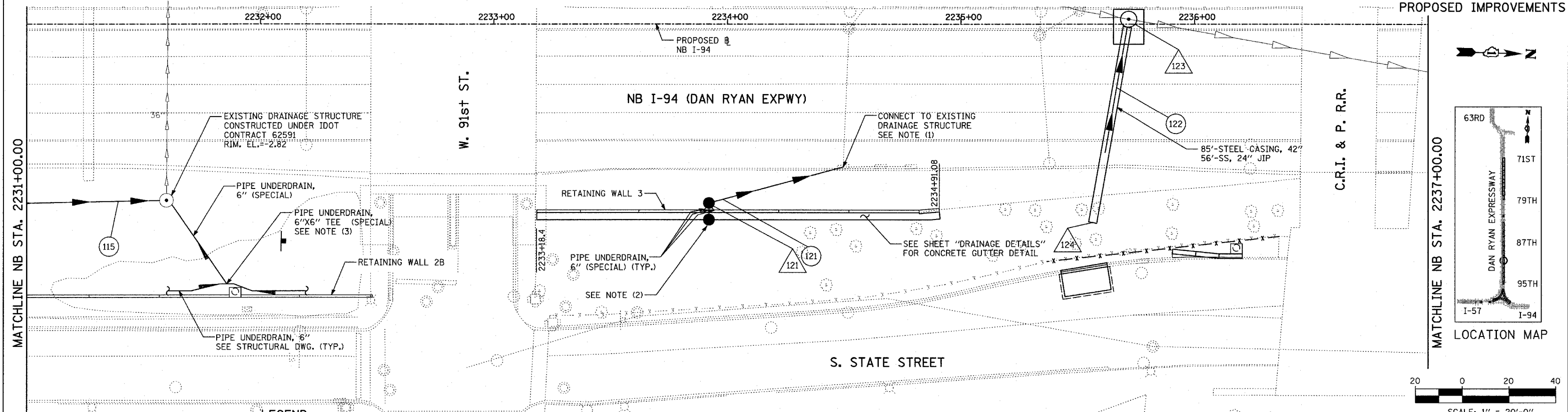
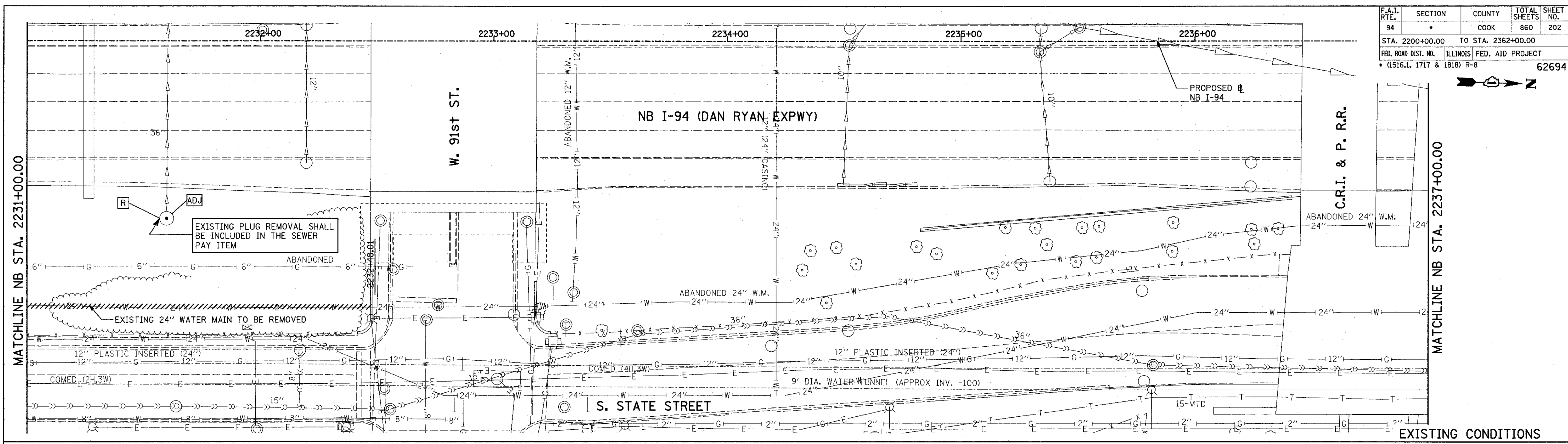

**LEGEND:**

- EXISTING COMBINED SEWER
- PROPOSED STORM SEWER NUMBER (X=SHEET NO., Y=PIPE NO.)
- PROPOSED STRUCTURE NUMBER (X=SHEET NO., Y=STRUCTURE NO.)
- PIPE STUBOUT TO BE PLUGGED
- UTILITY REMOVAL
- UTILITY REMOVAL PLUG
- HIGH MAST LIGHT TOWER FOUNDATION (BY OTHERS - SEE CONTRACT 62583)
- HIGH MAST LIGHT TOWER FOUNDATION, WALL MOUNTED
- HIGH MAST LIGHT TOWER FOUNDATION (BY OTHERS - SEE CONTRACT 62583)
- F.V. FIELD VERIFY

**NOTES:**

1. CORE DRILL AND CONNECT TO EXISTING DRAINAGE STRUCTURE. CONNECTION COST SHALL BE INCLUDED IN THE COST TO CONSTRUCT THE STORM SEWER.
2. INSTALL CONCRETE GUTTER OUTLET AS SHOWN ON THE "DRAINAGE DETAILS" SHEETS.
3. ALL TEES AND ELBOWS/BENDS FOR PUD, 6" (SPECIAL) SHALL BE INCLUDED IN COST OF PUD, 6" (SPECIAL).

REVISIONS	
NAME	DATE

ILLINOIS DEPARTMENT OF TRANSPORTATION  
 F.A.I. 94 (DAN RYAN EXPRESSWAY)  
 DRAINAGE AND UTILITY PLANS  
 NB 95th STREET ENTRANCE RAMP  
 NB I-94 STA. 2231+00.00 TO 2237+00.00  
 SCALE: 1"=20'  
 DATE: MARCH 18, 2005  
 DRAWN BY: MB  
 CHECKED BY: DA