

F.A.I. RTE. 94	SECTION	COUNTY COOK	TOTAL SHEETS 860	SHEET NO. 296
STA. 2200+00.00		TO STA. 2362+00.00		
FED. ROAD DIST. NO. (1516.1, 1717 & 1818) R-8		ILLINOIS FED. AID PROJECT		62694

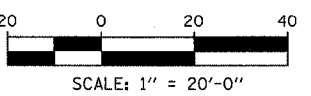
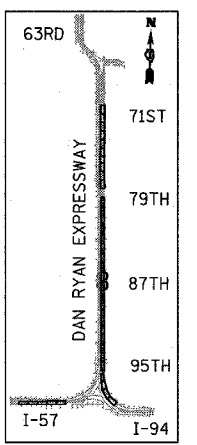
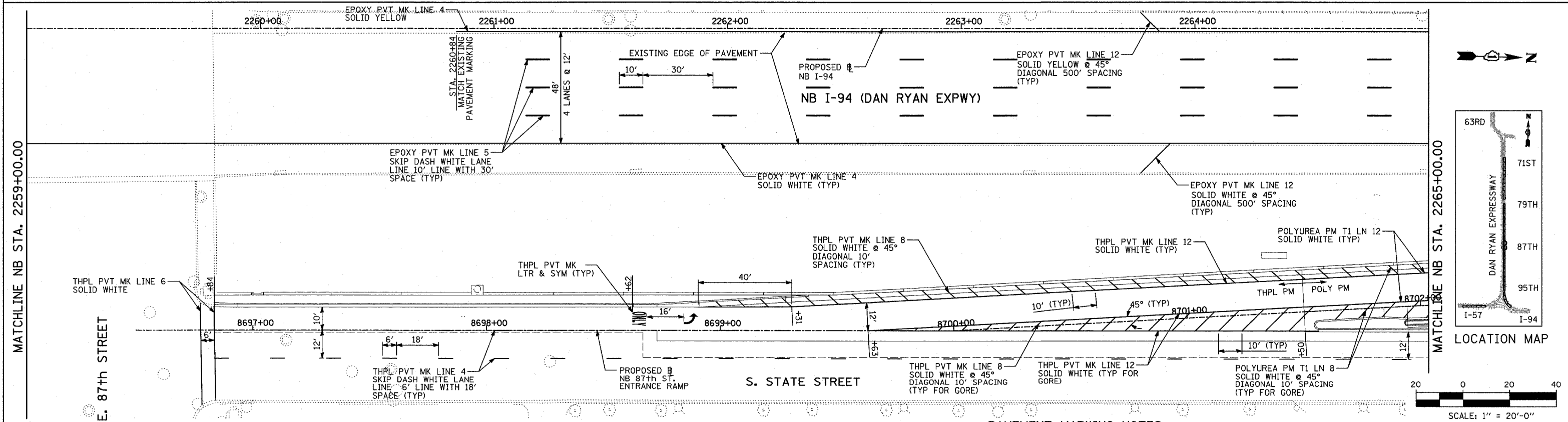
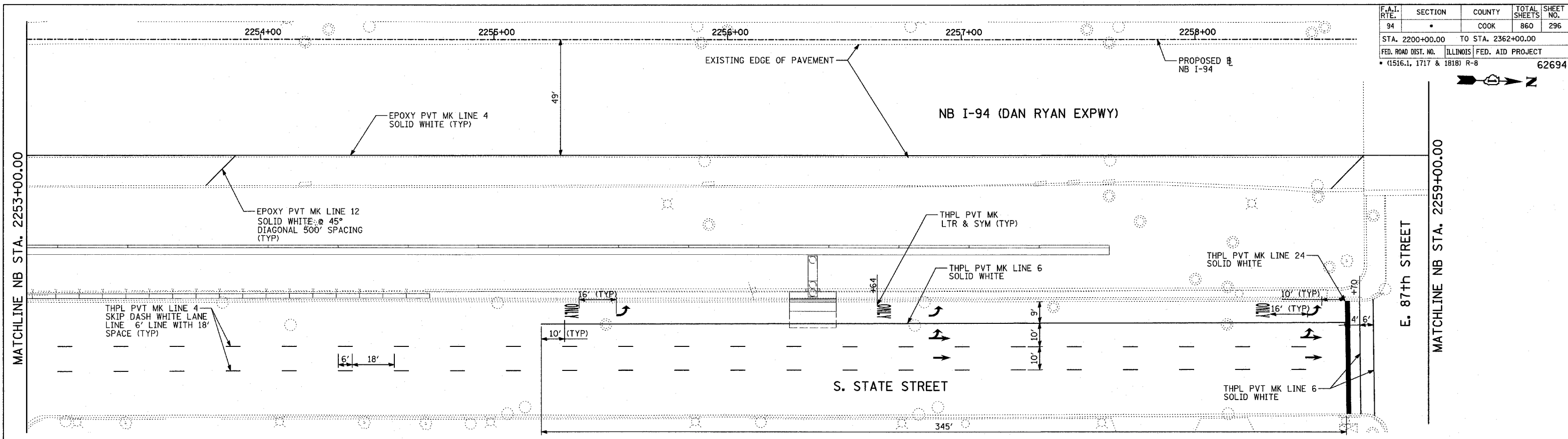

**PAVEMENT MARKING NOTES:**

- PAVEMENT MARKINGS SHALL BE IN ACCORDANCE WITH IDOT DISTRICT ONE STANDARD TC-12. RAISED PAVEMENT MARKERS SHALL NOT BE INSTALLED, EXCEPT AS SHOWN ON THE PLANS.
- THE RESIDENT ENGINEER SHALL CONTACT JULIA FOX (847) 705-4151, EXPRESSWAY TRAFFIC CONTROL SUPERVISOR, PRIOR TO PLACING ANY PAVEMENT MARKINGS.

REVISIONS	
NAME	DATE

ILLINOIS DEPARTMENT OF TRANSPORTATION  
 F.A.I. 94 (DAN RYAN EXPRESSWAY)  
**PAVEMENT MARKING**  
 NB 87th STREET ENTRANCE RAMP  
 NB I-94 STA. 2253+00.00 TO 2265+00.00

SCALE: 1"=20'  
 DATE: MARCH 18, 2005

DRAWN BY: TB  
 CHECKED BY: MPG

**TYLIN** INTERNATIONAL