

WALL DETAIL

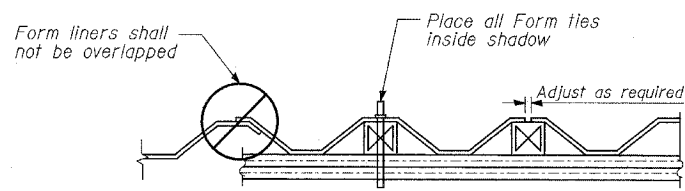

SUGGESTED FORMWORK DETAIL

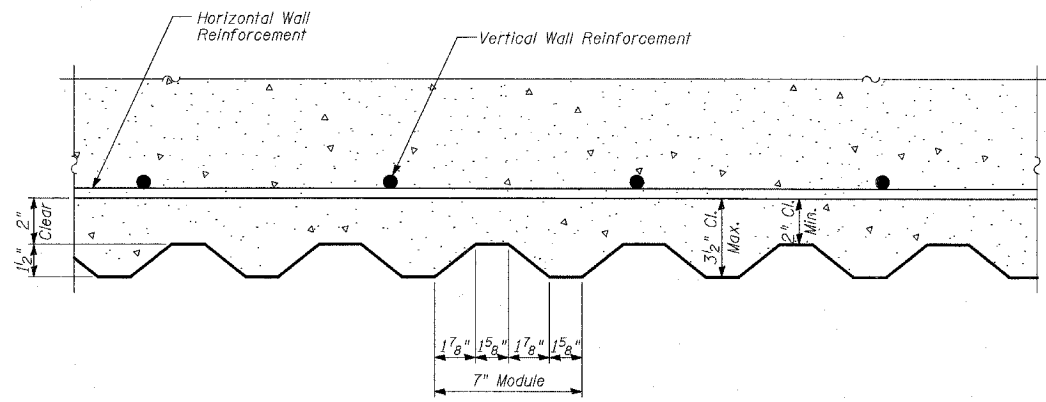

SECTION A-A

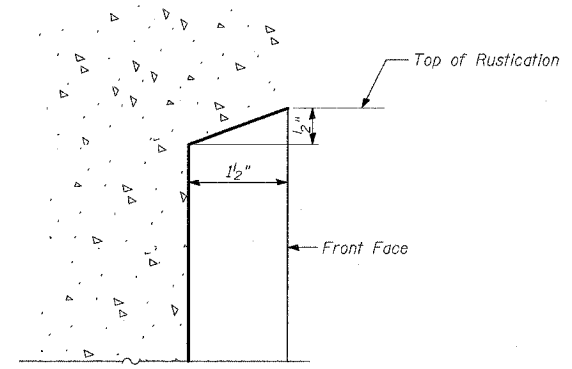

DETAIL A

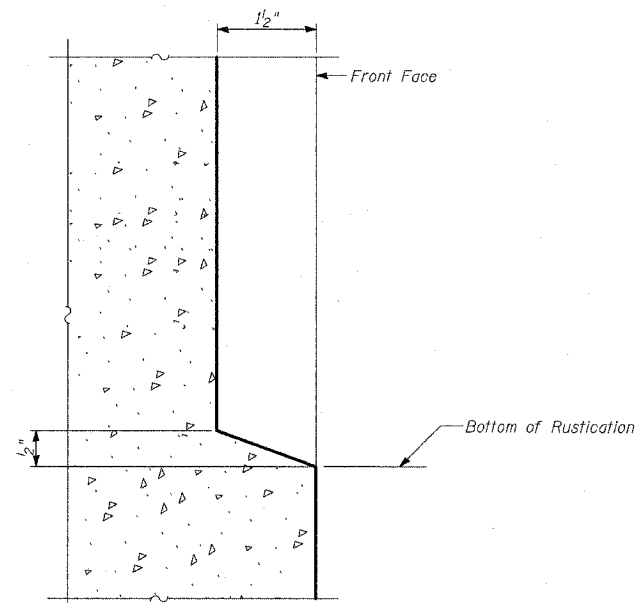

DETAIL B

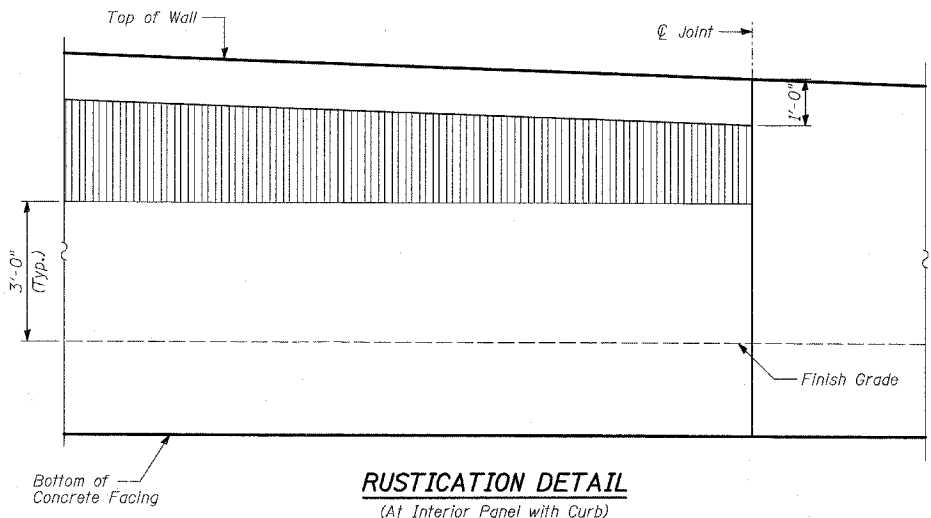

RUSTICATION DETAIL
(At Interior Panel with Curb)

NOTES:
1. See Sheet 6 of 11 for expansion and construction joint details.

BILL OF MATERIAL

ITEM	UNIT	TOTAL
Rustication Finish	SQ FT	680

REVISIONS	
NAME	DATE

ILLINOIS DEPARTMENT OF TRANSPORTATION
F.A.I. 94 (DAN RYAN EXPRESSWAY)
RETAINING WALL ALONG STATE ST.
ENTRANCE RAMP FROM 86TH ST. TO 85TH ST.
WALL 7
RUSTICATION DETAILS
 S.N. 016-W957 DESIGNED BY: MI, TB
 SCALE: N.T.S. DRAWN BY: TB, DJR
 DATE: MARCH 18, 2005 CHECKED BY: TD, MI