

NOTE BOOK
FILED CHECKED
BY: NOTED
INC. STRUCTURE NOTATIONS CHRD

F.A.I. RTE. 90/94	SECTION •	COUNTY COOK	TOTAL SHEETS 860	SHEET NO. 743
STA. 2200+00.00		TO STA. 2362+00.00		
FED. ROAD DIST. NO.		ILLINOIS		FED. AID PROJECT
• (1516.1, 1717 & 1818) R-8				62694

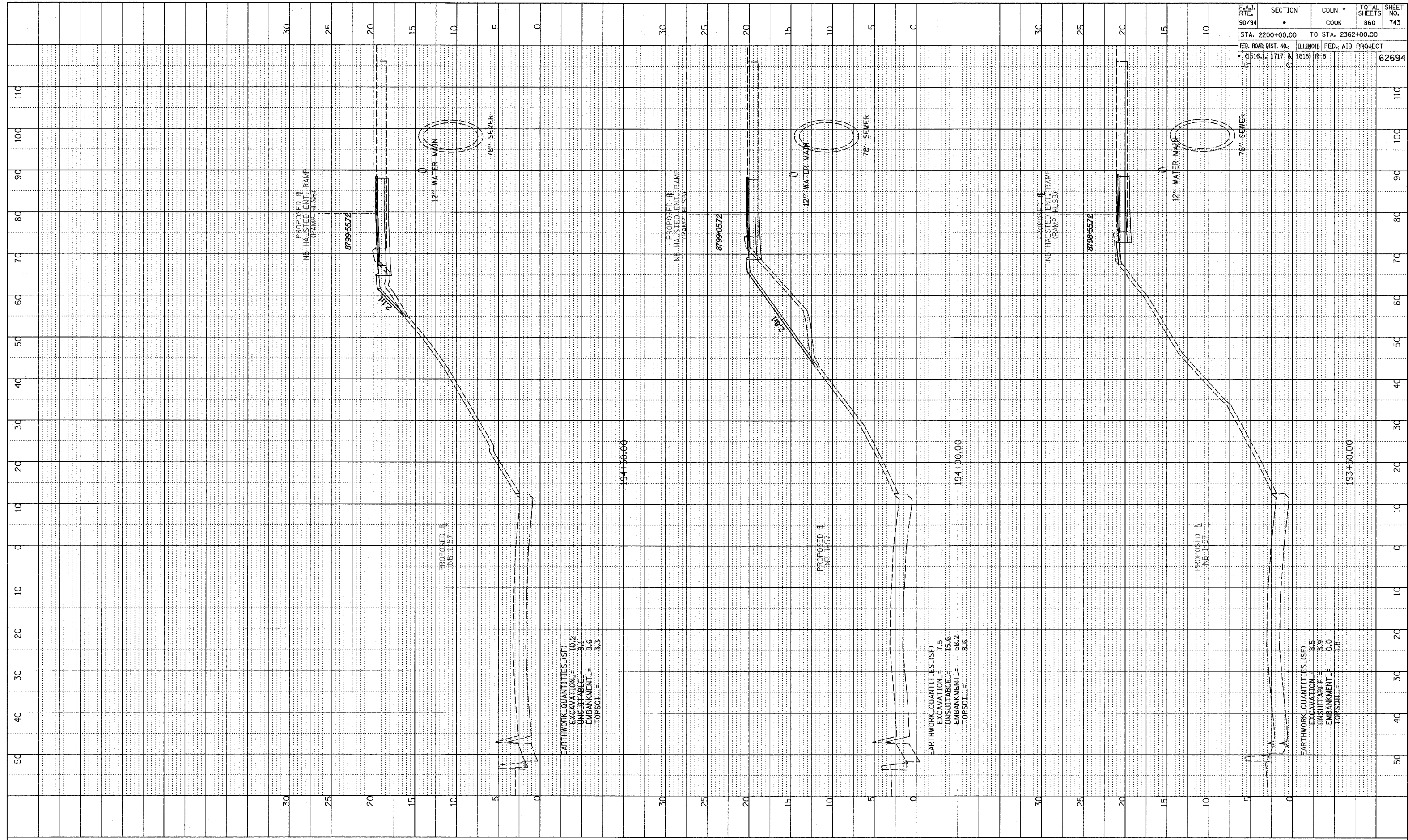

TYLIN INTERNATIONAL

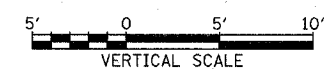
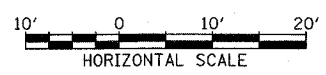

NB HALSTED ST. ENTRANCE RAMP
STA. 193+50 TO STA. 194+50

PA-02373\road\tr\gk\tr\ass\hisp_f.dgn