

PLOTTED
 GRADES CHECKED
 STRUCTURE NOTATION CHKD
 NO. _____

F.A.I. RTE.	SECTION	COUNTY	TOTAL SHEETS	SHEET NO.
90/94	*	COOK	860	744
STA. 2200+00.00 TO STA. 2362+00.00		ILLINOIS FED. AID PROJECT		
• (1516.1, 1717 & 1818) R-8		62694		

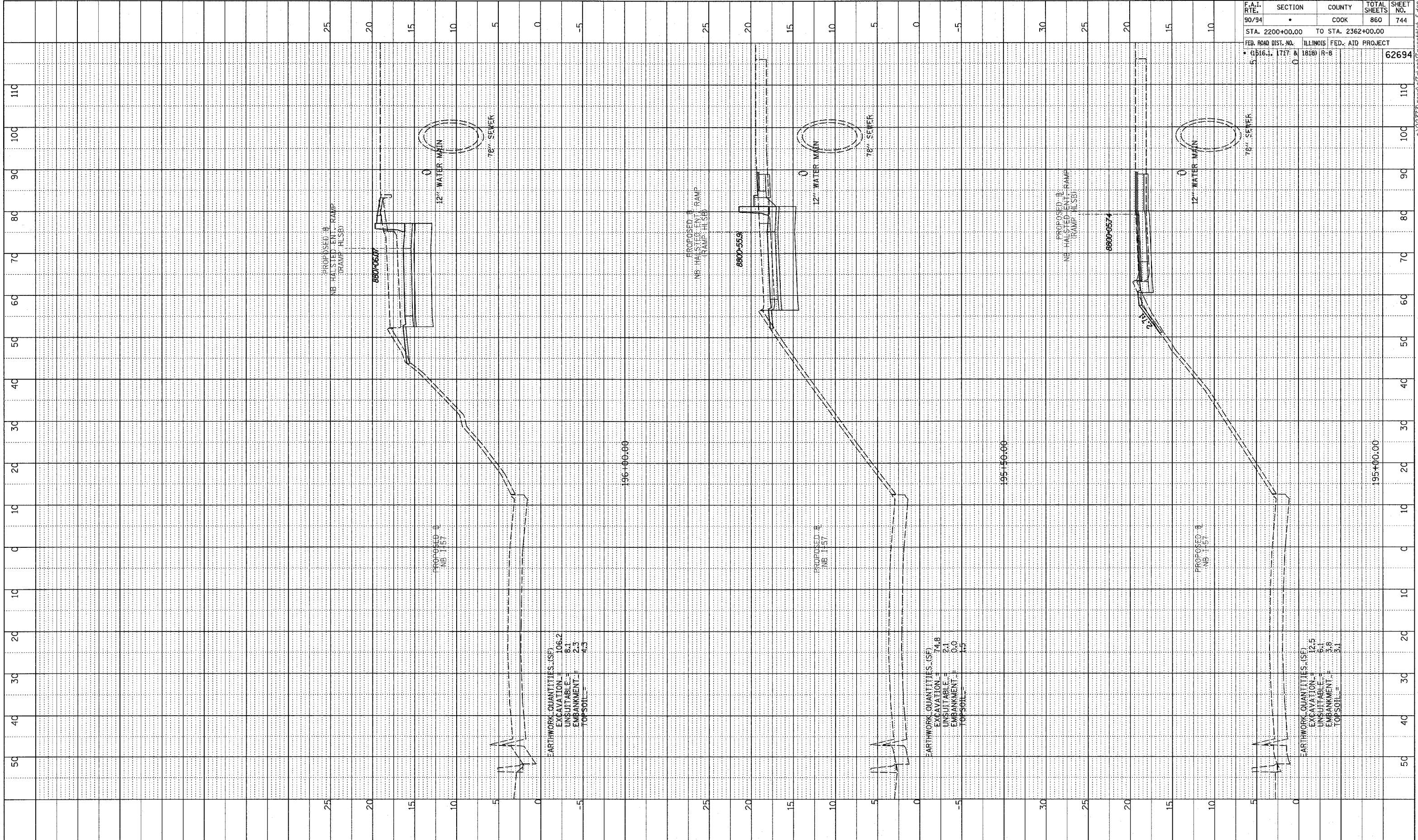

TYLIN INTERNATIONAL

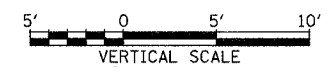
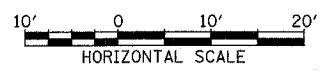

NB HALSTED ST. ENTRANCE RAMP
 STA. 195+00 TO STA. 196+00

P-02373 Roadway/Grades/Structure/Sheet.dgn