

F.A.I. RTE.	SECTION	COUNTY	TOTAL SHEETS	SHEET NO.
94	*	COOK	860	751
STA. 2200+00.00		TO STA. 2362+00.00		
FED. ROAD DIST. NO.	ILLINOIS	FED. AID PROJECT		
* (1516.1, 1717 & 1818) R-8			62694	
240	250	260	270	

DATE	
BY	
PROFILER	
SURVEYED	
GRADES CHECKED	
NOTE BOOK NO.	
STRUCTURE NOTATION	

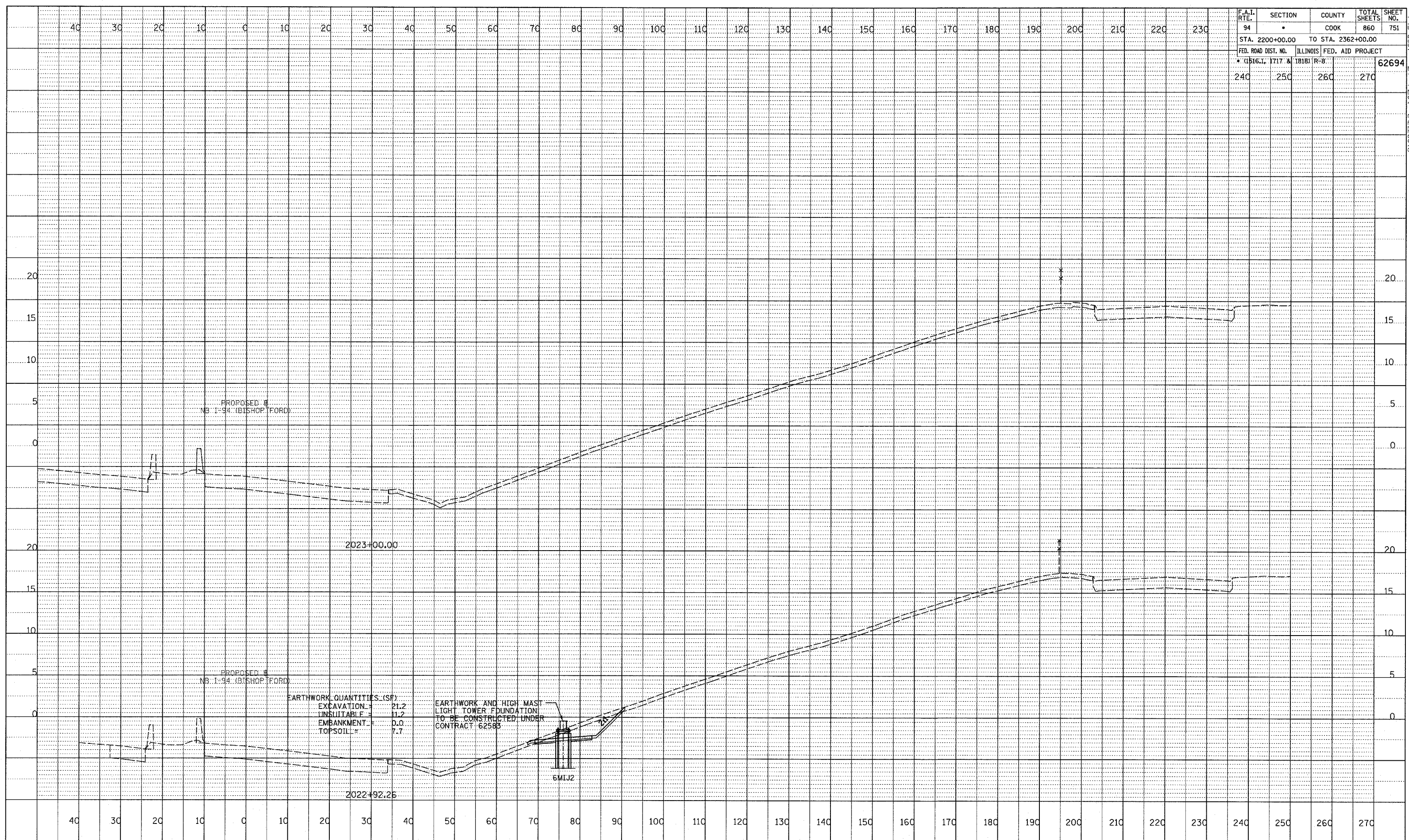

EARTHWORK QUANTITIES (SF)	
EXCAVATION	21.2
UNSUITABLE	11.2
EMBANKMENT	0.0
TOPSOIL	7.7

EARTHWORK AND HIGH MAST LIGHT TOWER FOUNDATION TO BE CONSTRUCTED UNDER CONTRACT 62583

TYLIN INTERNATIONAL

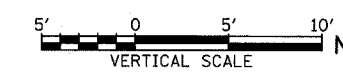
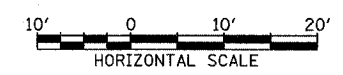

NB MICHIGAN AVE, ENTRANCE RAMP
STA. 2022+92 TO STA. 2023+00