

NOTE BOOK
 PLANNED, CHECKED
 NO. _____
 STRUCTURE NOTATIONS CHNO

F.A.I. RTE. 90/94	SECTION	COUNTY	TOTAL SHEETS	SHEET NO.
STA. 2200+00.00 TO STA. 2362+00.00	COOK	ILLINOIS	860	765
FED. ROAD DIST. NO. (1516.1, 1717 & 1818) R-8	ILLINOIS FED. AID PROJECT		62694	

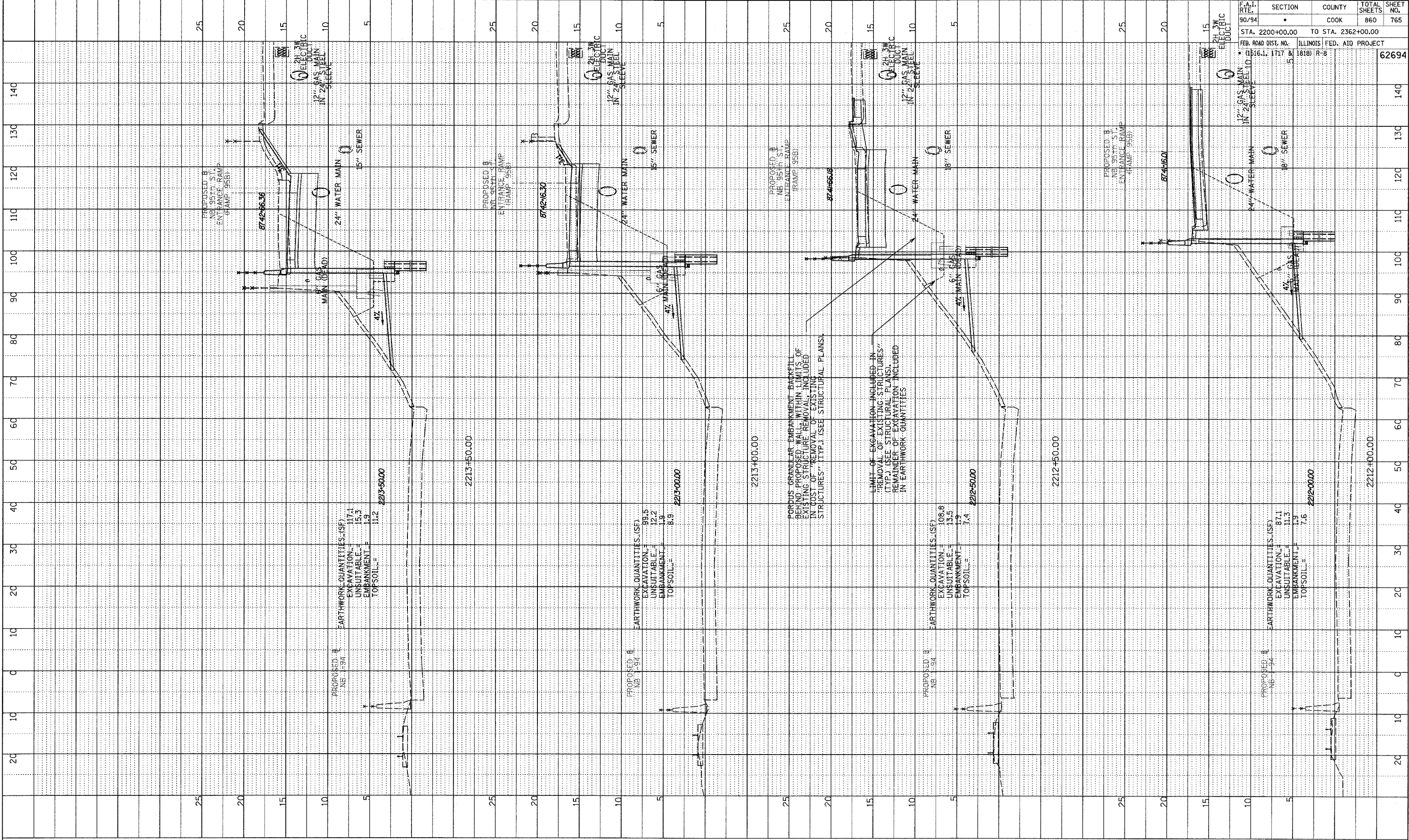

PROPOSED B NB 95th ST. ENTRANCE RAMP (RAMP 955B)
 EARTHWORK QUANTITIES (SF)
 EXCAVATION = 17.1
 UNSUITABLE = 15.3
 EMBANKMENT = 1.9
 TOPSOIL = 11.2
 2213+50.00

PROPOSED B NB 95th ST. ENTRANCE RAMP (RAMP 955B)
 EARTHWORK QUANTITIES (SF)
 EXCAVATION = 89.5
 UNSUITABLE = 12.2
 EMBANKMENT = 1.9
 TOPSOIL = 8.9
 2213+00.00

PROPOSED B NB 95th ST. ENTRANCE RAMP (RAMP 955B)
 EARTHWORK QUANTITIES (SF)
 EXCAVATION = 108.8
 UNSUITABLE = 13.5
 EMBANKMENT = 1.9
 TOPSOIL = 7.4
 2212+50.00

PROPOSED B NB 95th ST. ENTRANCE RAMP (RAMP 955B)
 EARTHWORK QUANTITIES (SF)
 EXCAVATION = 87.1
 UNSUITABLE = 11.3
 EMBANKMENT = 1.9
 TOPSOIL = 7.6
 2212+00.00

POROUS GRANULAR EMBANKMENT BACKFILL BEHIND PROPOSED WALLS WITHIN LIMITS OF EXISTING STRUCTURE REMOVAL, INCLUDED IN COST OF "REMOVAL OF EXISTING STRUCTURES" (TYP.) (SEE STRUCTURAL PLANS).
 LIMIT OF EXCAVATION INCLUDED IN "REMOVAL OF EXISTING STRUCTURES" (TYP.) (SEE STRUCTURAL PLANS). REMAINDER OF EXCAVATION INCLUDED IN "EARTHWORK QUANTITIES".

