

NOTE BOOK
 PLOTTED, REVERSED
 DIMENSIONS
 NO. _____
 STRUCTURE NOTATION CHRG

F.A.I. RTE. NO. 90/94	SECTION	COUNTY	TOTAL SHEETS	SHEET NO.
STA. 2200+00.00 TO STA. 2362+00.00		COOK	860	766
FED. ROAD DIST. NO. ILLINOIS FED. AID PROJECT				
• (1516.1, 1717 & 1818) R-8				
				62694

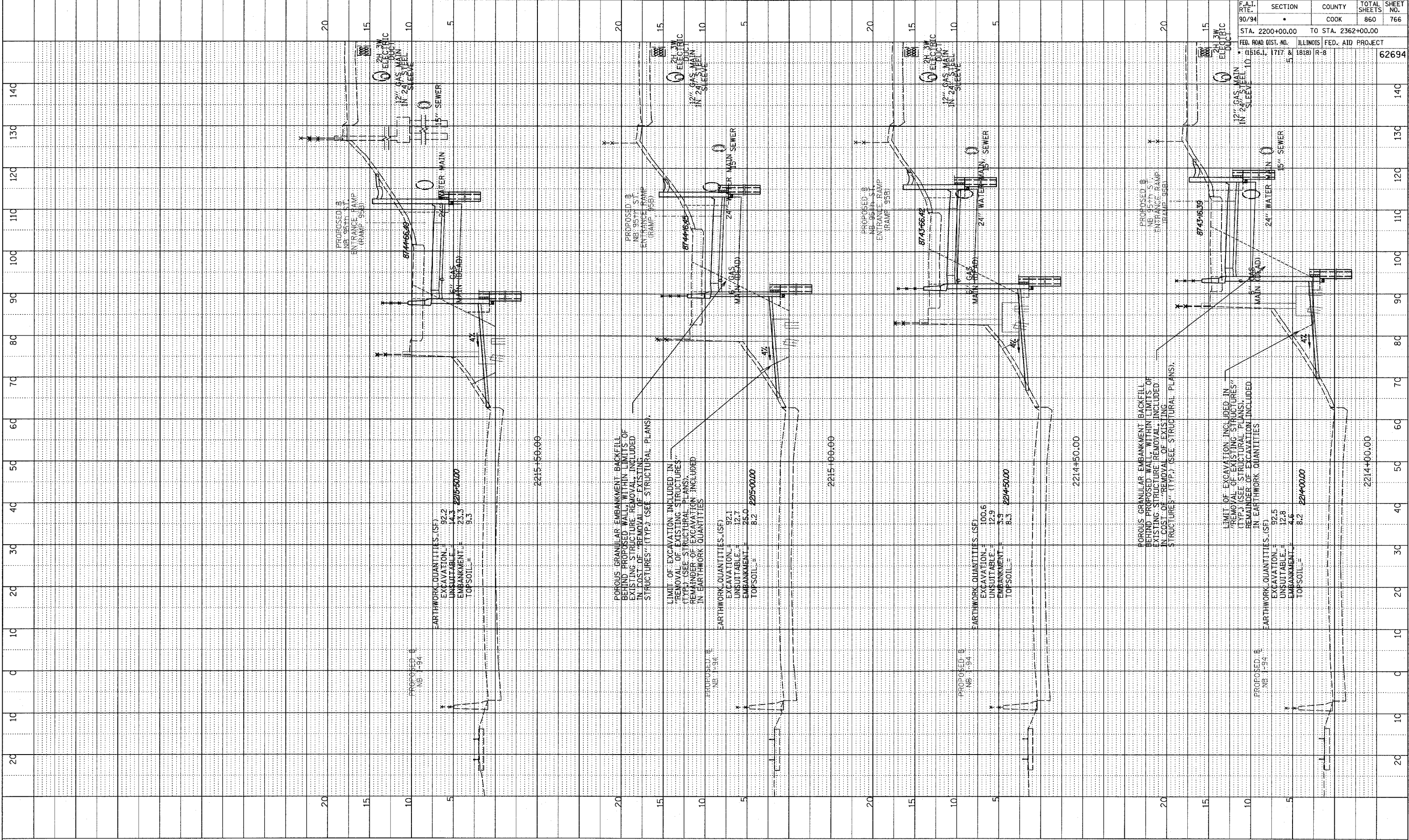

EARTHWORK QUANTITIES (SF)
 EXCAVATION = 92.2
 UNSUITABLE = 14.3
 EMBANKMENT = 23.3
 TOPSOIL = 9.3

POROUS GRANULAR EMBANKMENT BACKFILL BEHIND PROPOSED WALL, WITHIN LIMITS OF EXISTING STRUCTURE REMOVAL, INCLUDED IN COST OF "REMOVAL OF EXISTING STRUCTURES" (TYP.) (SEE STRUCTURAL PLANS).

LIMIT OF EXCAVATION INCLUDED IN "REMOVAL OF EXISTING STRUCTURES" (TYP.) (SEE STRUCTURAL PLANS). REMAINDER OF EXCAVATION INCLUDED IN EARTHWORK QUANTITIES

EARTHWORK QUANTITIES (SF)
 EXCAVATION = 92.1
 UNSUITABLE = 12.7
 EMBANKMENT = 25.0
 TOPSOIL = 8.2

EARTHWORK QUANTITIES (SF)
 EXCAVATION = 100.6
 UNSUITABLE = 12.9
 EMBANKMENT = 3.3
 TOPSOIL = 8.3

LIMIT OF EXCAVATION INCLUDED IN "REMOVAL OF EXISTING STRUCTURES" (TYP.) (SEE STRUCTURAL PLANS). REMAINDER OF EXCAVATION INCLUDED IN EARTHWORK QUANTITIES

EARTHWORK QUANTITIES (SF)
 EXCAVATION = 92.5
 UNSUITABLE = 12.8
 EMBANKMENT = 4.6
 TOPSOIL = 8.2

TYLIN INTERNATIONAL

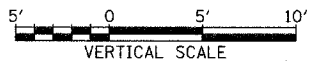

NB 95th ST. ENTRANCE RAMP
 STA. 2214+00 TO STA. 2215+50

PA02373roadatgpkITaxss95b_f.dgn