

PLOTTED
 DRAWING
 STRUCTURE NOTATION CHRD

F.A.I. RTE.	SECTION	COUNTY	TOTAL SHEETS	SHEET NO.
90/94	•	COOK	860	772
STA. 2200+00.00 TO STA. 2362+00.00				
FED. ROAD DIST. NO. ILLINOIS FED. AID PROJECT				
• (1516.1, 1717 & 1818) R-8				
				62694

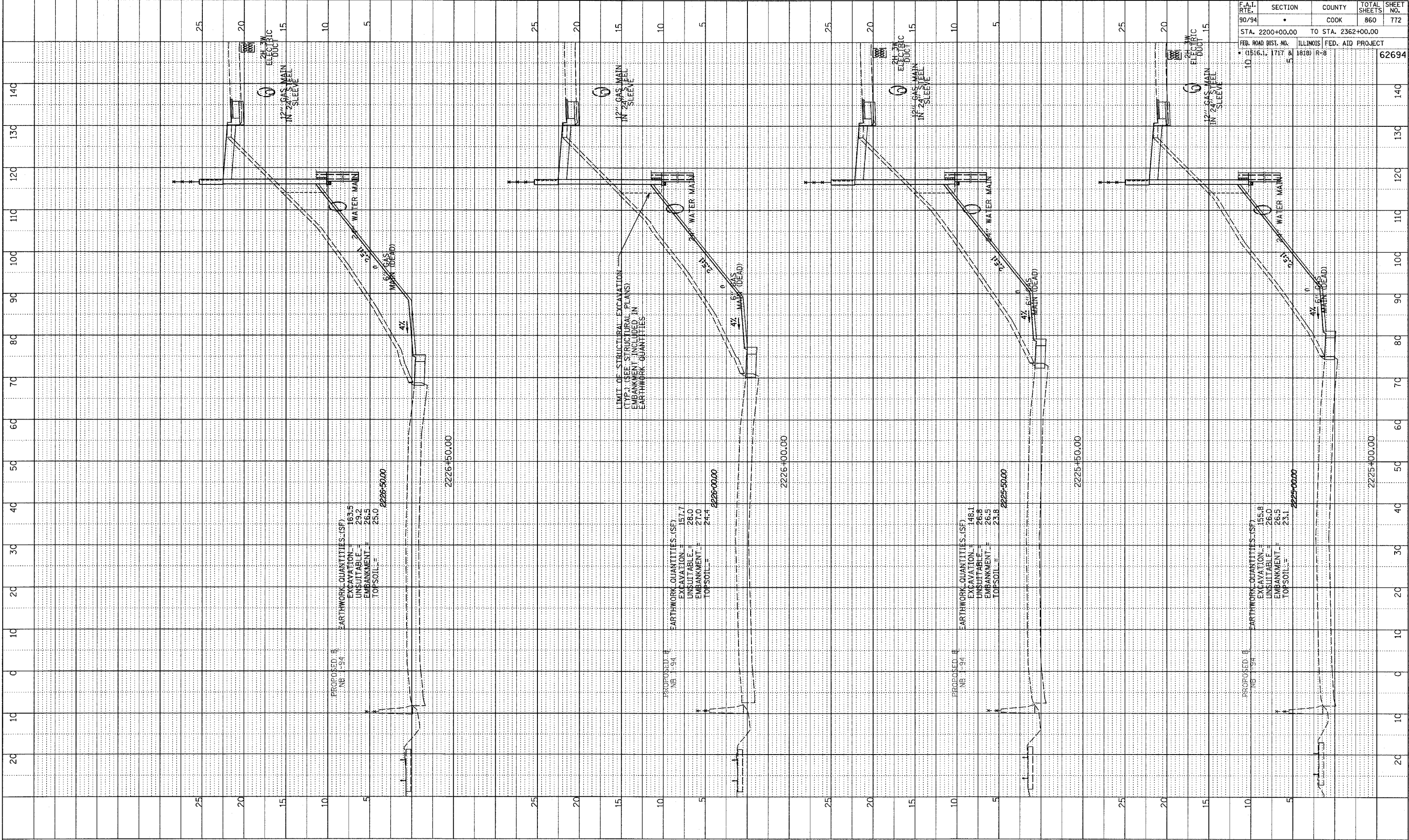

LIMIT OF STRUCTURAL EXCAVATION
 (TYP.) (SEE STRUCTURAL PLANS)
 EMBANKMENT INCLUDED IN
 EARTHWORK QUANTITIES

PROPOSED E
 NB 1-94
 EARTHWORK QUANTITIES (SF)
 EXCAVATION = 163.5
 UNSUITABLE = 29.2
 EMBANKMENT = 26.5
 TOPSOIL = 25.0
 2225+50.00
 2226+00.00

PROPOSED E
 NB 1-94
 EARTHWORK QUANTITIES (SF)
 EXCAVATION = 157.7
 UNSUITABLE = 28.0
 EMBANKMENT = 27.0
 TOPSOIL = 24.4
 2226+00.00

PROPOSED E
 NB 1-94
 EARTHWORK QUANTITIES (SF)
 EXCAVATION = 148.1
 UNSUITABLE = 26.8
 EMBANKMENT = 26.5
 TOPSOIL = 23.8
 2225+50.00
 2225+00.00

PROPOSED E
 NB 1-94
 EARTHWORK QUANTITIES (SF)
 EXCAVATION = 155.8
 UNSUITABLE = 26.0
 EMBANKMENT = 26.5
 TOPSOIL = 23.1
 2225+00.00
 2225+50.00

TYLIN INTERNATIONAL

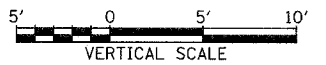

NB 95th ST. ENTRANCE RAMP
 STA. 2225+00 TO STA. 2226+50

PA-02313\road\c17\ogaki\Tosss185b-f.dgn