

NOTE BOOK NO. STRUCTURE NOTATIONS CHRD

F.A.I. RTE.	SECTION	COUNTY	TOTAL SHEETS	SHEET NO.
90/94	*	COOK	860	807
STA. 2200+00.00 TO STA. 2362+00.00		ILLINOIS FED. AID PROJECT		
FED. ROAD DIST. NO. 1516.1, 1717 & 1818		R-8		62694

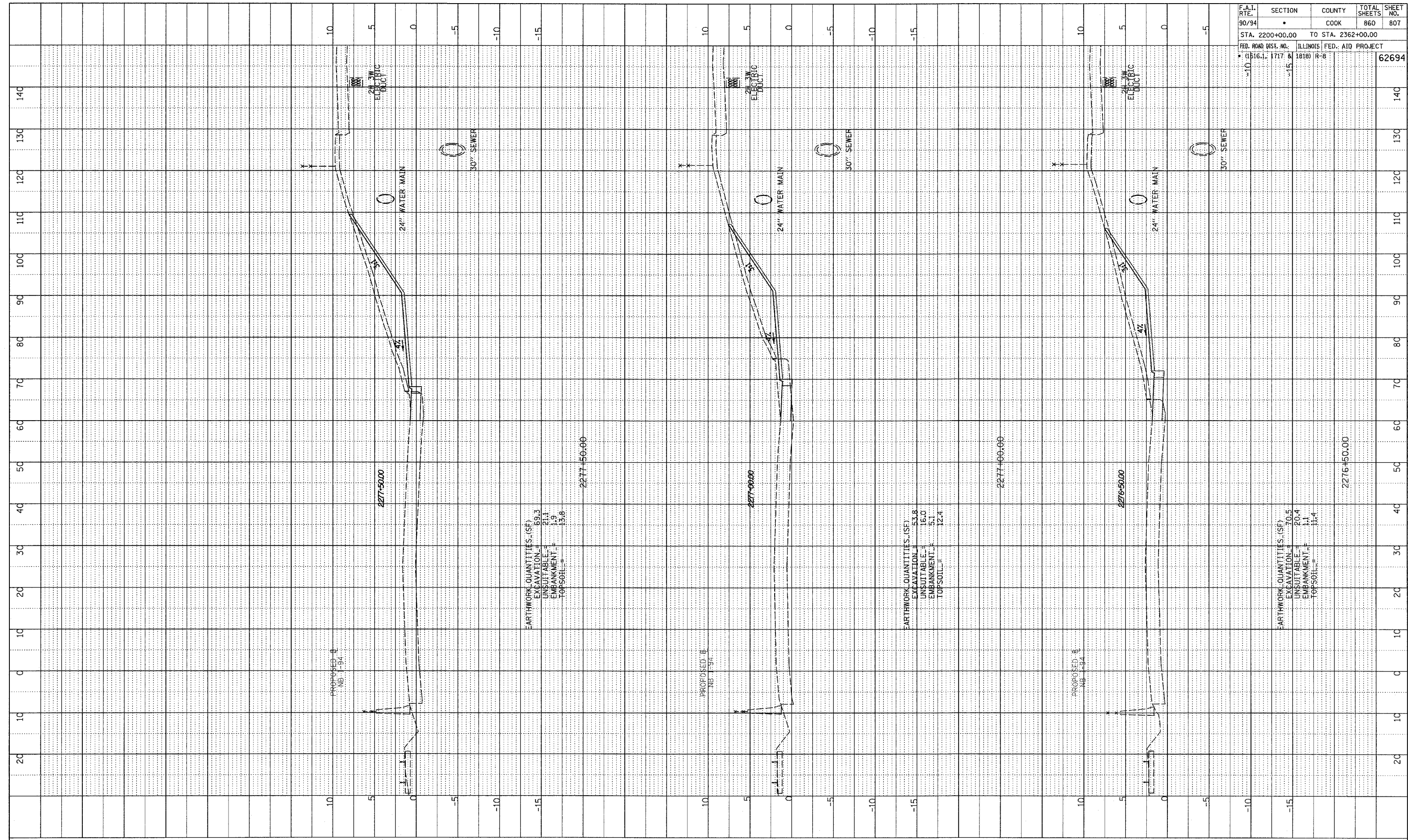

EARTHWORK QUANTITIES (SF)
 EXCAVATION = 69.3
 UNSUITABLE = 21.1
 EMBANKMENT = 1.9
 TOPSOIL = 13.8

EARTHWORK QUANTITIES (SF)
 EXCAVATION = 53.8
 UNSUITABLE = 16.0
 EMBANKMENT = 5.1
 TOPSOIL = 12.4

EARTHWORK QUANTITIES (SF)
 EXCAVATION = 70.5
 UNSUITABLE = 20.4
 EMBANKMENT = 1.1
 TOPSOIL = 11.4

TYLIN INTERNATIONAL

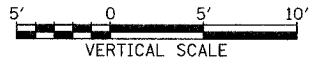

NB 87th ST. ENTRANCE RAMP
 STA. 2276+50 TO STA. 2277+50

PA02373vroad.ctb\\gpk\\f\\axss\\87b.f.dgn