

PROFILE DRAWING
 GRADES CHECKED
 DATE: 10/11/94
 BY: J. METZGER
 NO. 1

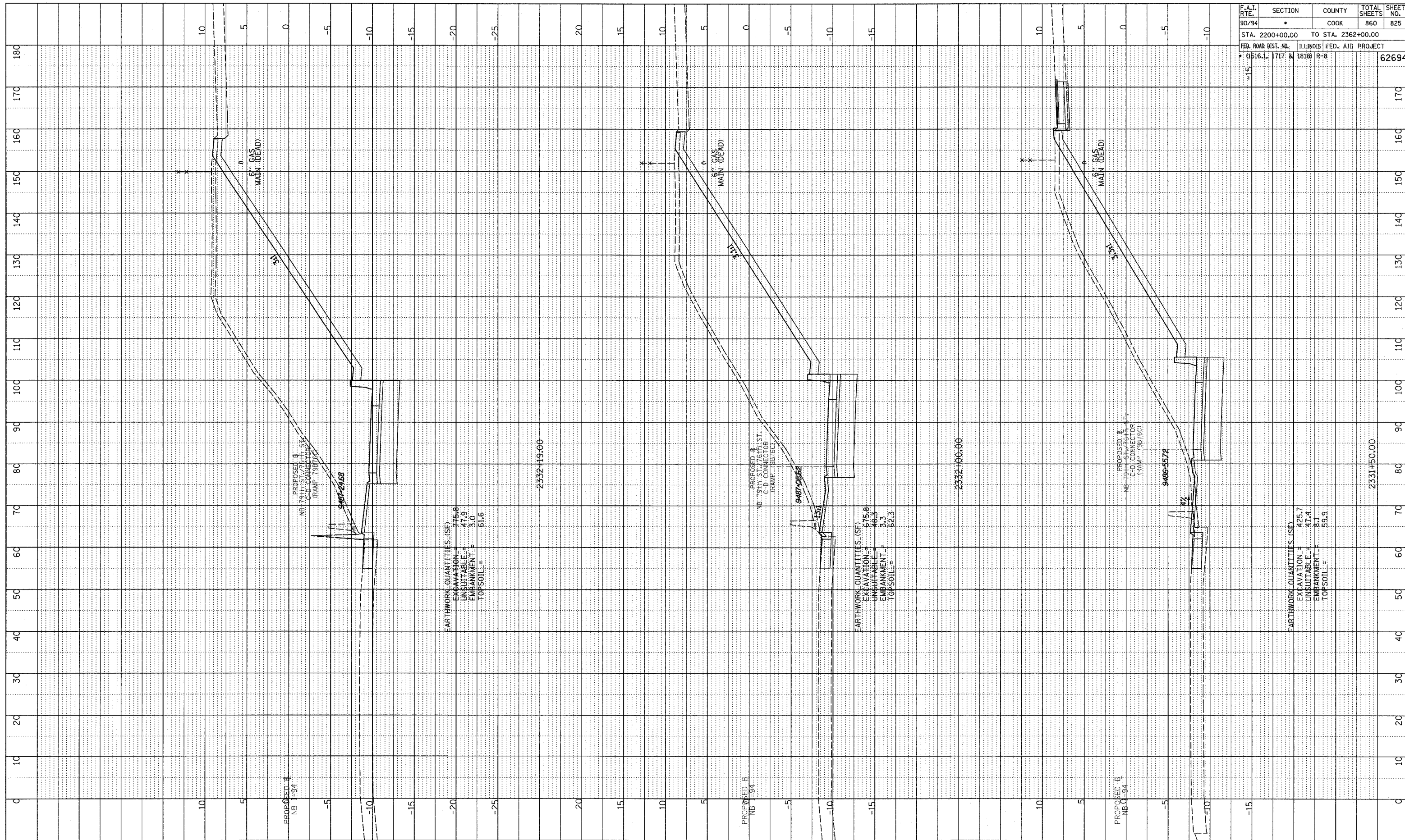

F.A.I. RTE.	SECTION	COUNTY	TOTAL SHEETS	SHEET NO.
90/94		COOK	860	825
STA. 2200+00.00 TO STA. 2362+00.00				
FED. ROAD DIST. NO.		ILLINOIS FED. AID PROJECT		
1516.1, 1717 & 1818		R-8	62694	

TYLIN INTERNATIONAL

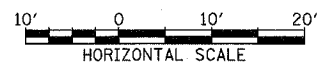

NB 79th TO 76th C-D RAMP
 STA. 2331+50 TO STA. 2332+19

P:\0231\road\94\940231\road\940231.dwg