

PROF. ILL. DRAWING
 NOTE BOOK GRADES CHECKED
 NO. DATE BY
 STRUCTURE NOTATION CHKD

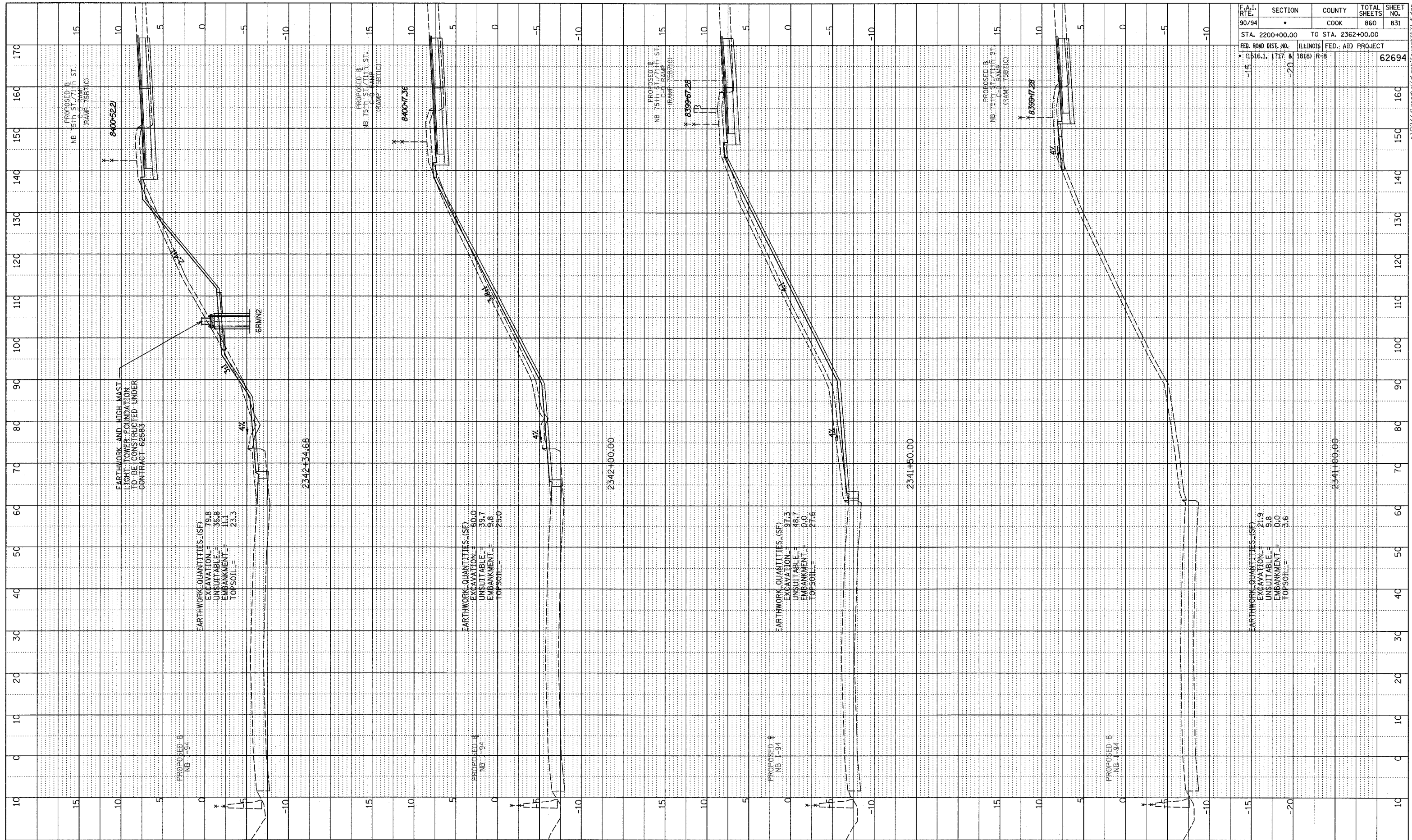

F.A.I. RTE.	SECTION	COUNTY	TOTAL SHEETS	SHEET NO.
90/94		COOK	860	831
STA. 2200+00.00 TO STA. 2362+00.00				
FED. ROAD DIST. NO.		ILLINOIS FED. AID PROJECT		
• (1516.1, 1717 & 1818) R-8				62694

TYLINT INTERNATIONAL

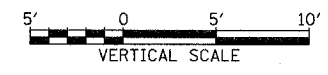
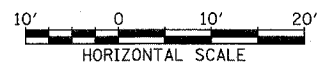

NB 75th TO 71st. C-D RAMP
 STA. 2341+50 TO STA. 2342+34

PA0237-3-road-01-dwg-01-ramp17-1.dgn