

PLOTTED, CHECKED, REVISIONS, DATE, STRUCTURE NOTATION, EIRNO
 NO.

| F.A.I. RTE. | SECTION | COUNTY | TOTAL SHEETS | SHEET NO. |
|---|---------|--------|--------------|-----------|
| 90/94 | * | COOK | 860 | 845 |
| STA. 2200+00.00 TO STA. 2362+00.00 | | | | |
| FED. ROAD DIST. NO. ILLINOIS FED. AID PROJECT | | | | |
| * (1516.1, 1717 & 1818) R-8 | | | | |
| | | | | 62694 |

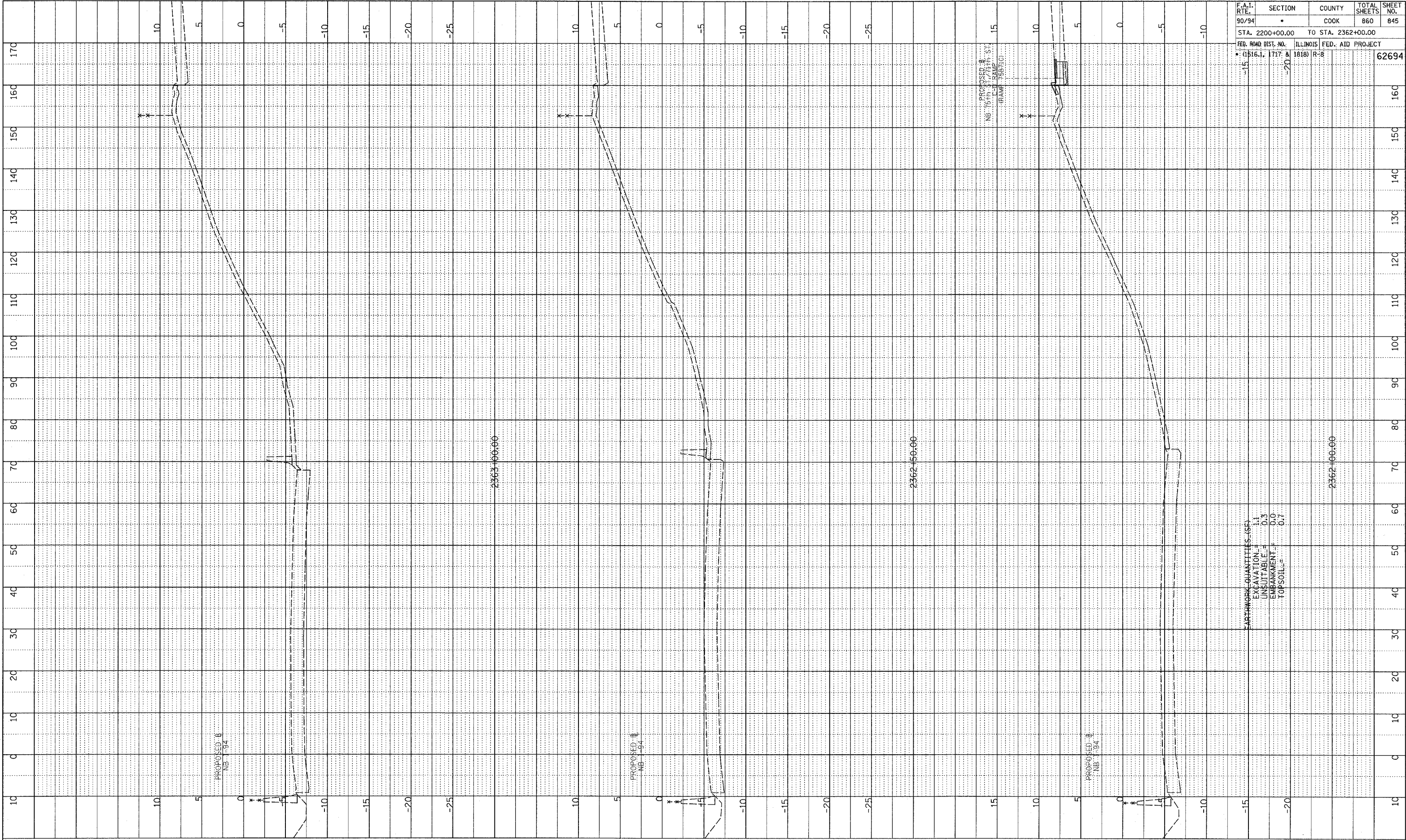

EARTHWORK QUANTITIES (SF)
 EXCAVATION = 1.1
 UNSUITABLE = 0.3
 EMBANKMENT = 0.0
 TOPSOIL = 0.7

TYLIN INTERNATIONAL

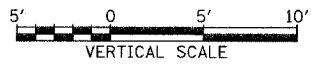

NB 75th TO 71st. C-D RAMP
 STA. 2362+00 TO STA. 2363+00

P:\02373\road\cfd\cfd.dgn