

F.A.I. RTE. 94	SECTION	COUNTY COOK	TOTAL SHEETS 907	SHEET NO. 61
STA. 1200+00.00		TO STA. 1365+00		
FED. ROAD DIST. NO.		ILLINOIS	FED. AID PROJECT	
		(1516.1, 1717 & 1818) R-9		62695

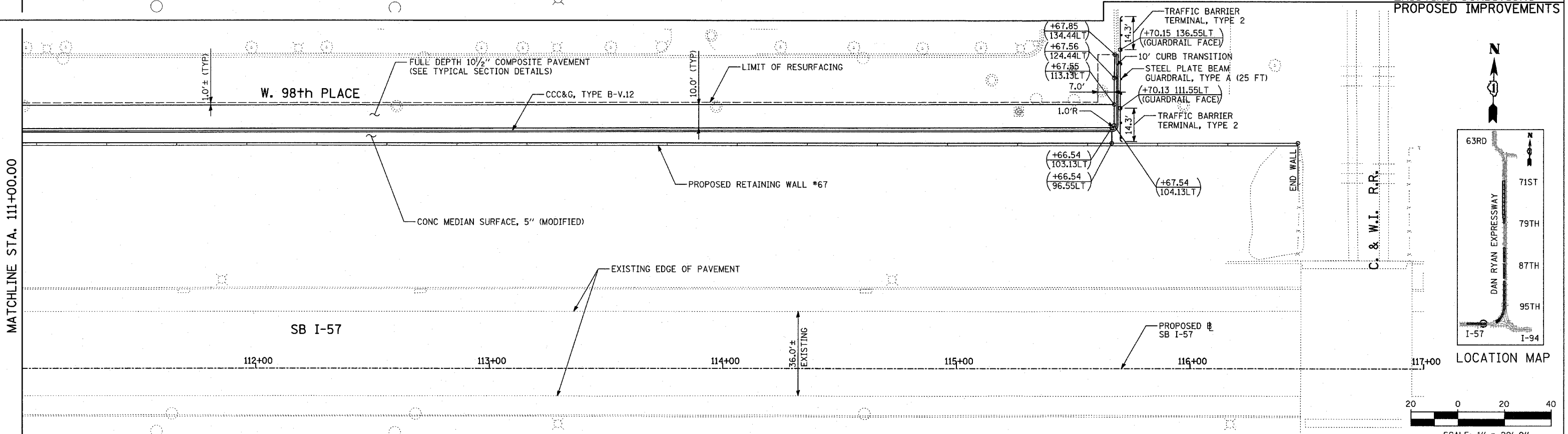

EXISTING CONDITIONS
PROPOSED IMPROVEMENTS

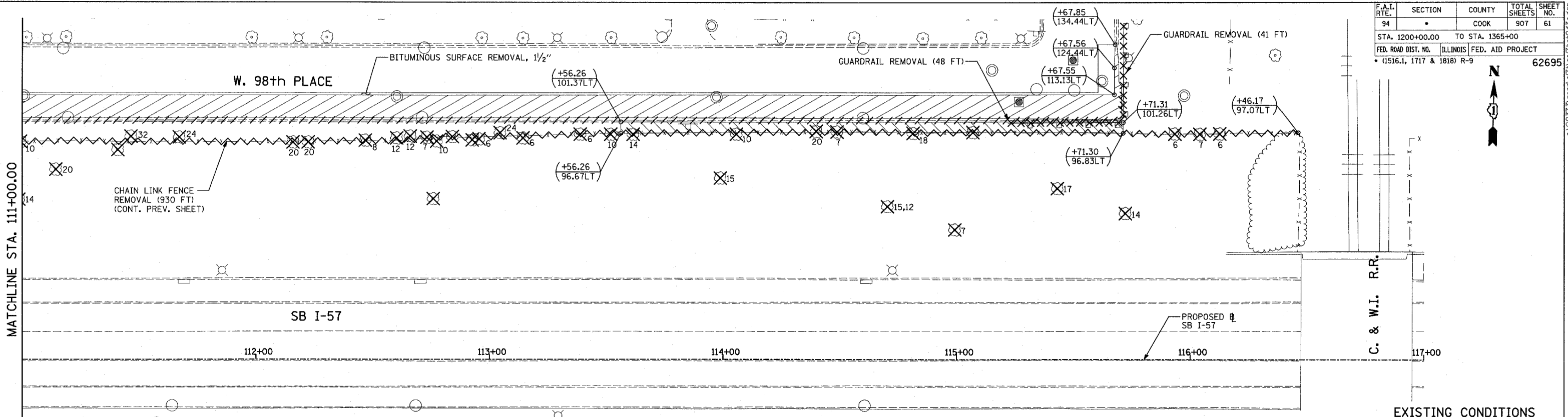
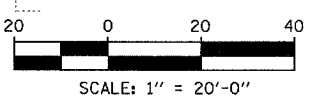
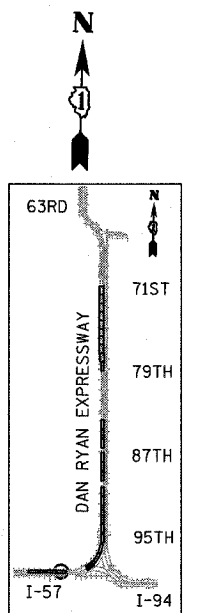

- LEGEND:**
- PAVEMENT REMOVAL
 - PAVED SHOULDER REMOVAL
 - PAVEMENT/SHOULDER REMOVAL, SPECIAL
 - COMB CONC CURB & GUTTER REMOVAL
 - CHAIN LINK FENCE REMOVAL
 - CONCRETE BARRIER/GUARDRAIL REMOVAL
 - TREE REMOVAL (UNITS) (NO UNIT SHOWN = <6)
 - SOIL BORING LOCATIONS
 - LIGHT POLE FOUNDATION REMOVAL (SEE EXISTING ELECTRICAL PLANS)
 - MAINLINE # STATION/OFFSET
 - RAMP # STATION/OFFSET
- NOTES:**
- ALL STATION/OFFSET/RADIUS CALLOUTS MEASURED TO EDGE OF PAVEMENT UNLESS OTHERWISE NOTED.
 - EXACT LOCATIONS OF EXISTING PIERS/ABUTMENTS TO BE FIELD VERIFIED

REVISIONS	
NAME	DATE

ILLINOIS DEPARTMENT OF TRANSPORTATION
F.A.I. 94 (DAN RYAN EXPRESSWAY)
EXISTING AND PROPOSED PLAN
RETAINING WALL #67
SB I-57 STA. 111+00.00 TO 116+46.17

SCALE: 1"=20'
DATE: MARCH 25, 2005

DRAWN BY: MPG
CHECKED BY: CL

TYLIN INTERNATIONAL

03/30/2005 11:11:25 AM