

F.A.I. RTE.	SECTION	COUNTY	TOTAL SHEETS	SHEET NO.
94		COOK	907	63
STA. 1200+00.00 TO STA. 1365+00				
FED. ROAD DIST. NO. ILLINOIS FED. AID PROJECT				
(1516.1, 1717 & 1818) R-9				

62695

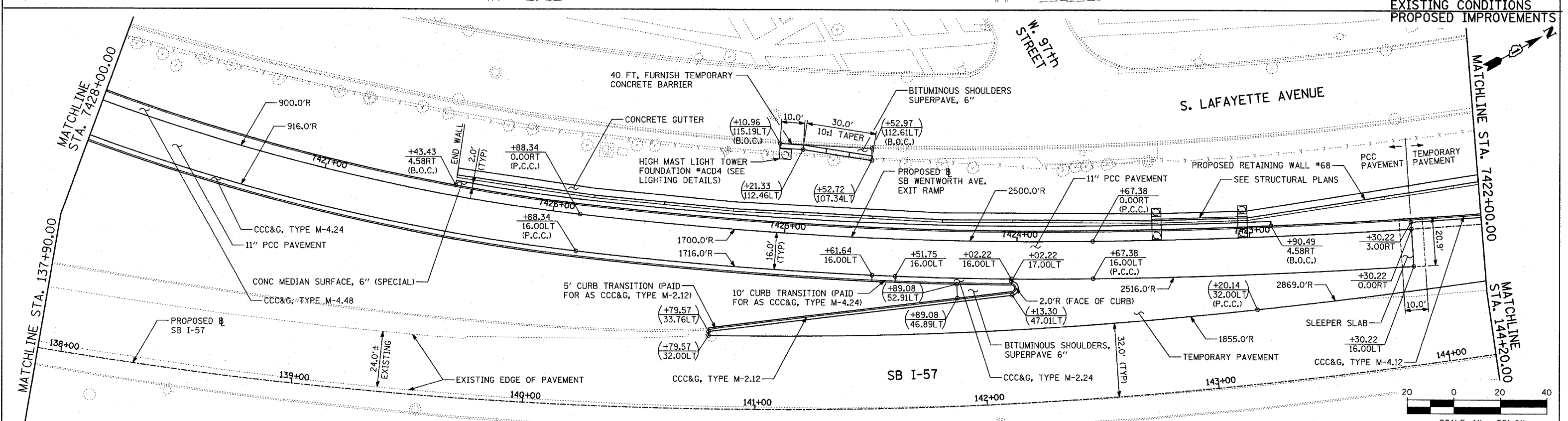
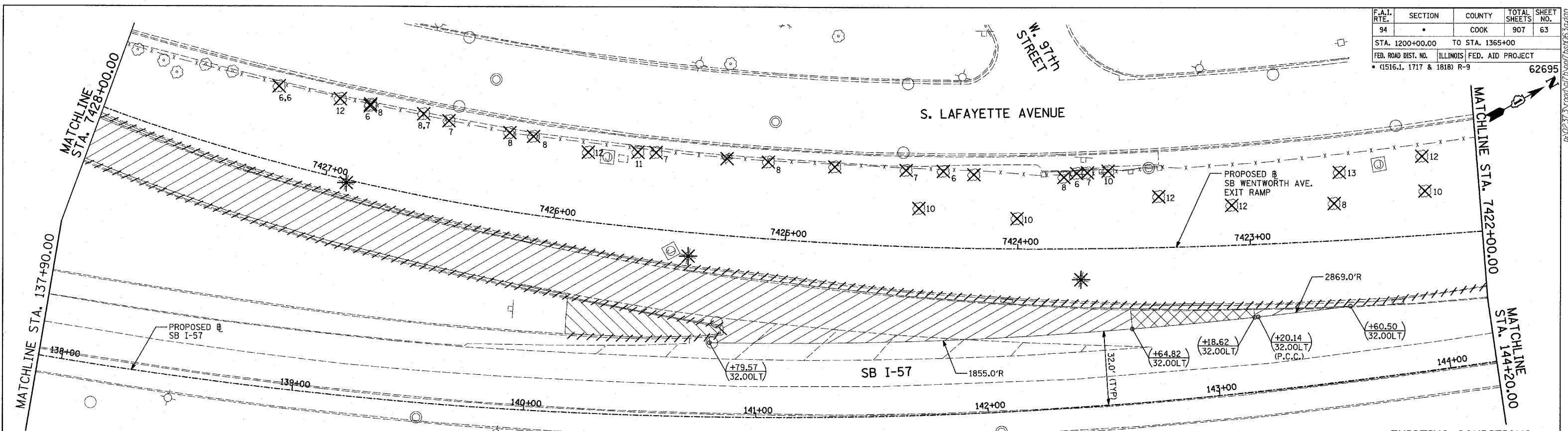

**TYLIN INTERNATIONAL**

**LEGEND:**

- |  |                                    |  |                                    |  |   |
|--|------------------------------------|--|------------------------------------|--|---|
|  | PAVEMENT REMOVAL                   |  | COMB CONC CURB & GUTTER REMOVAL    |  | MAINLINE # STATION/OFFSET                                     |
|  | PAVED SHOULDER REMOVAL             |  | CHAIN LINK FENCE REMOVAL           |  | RAMP # STATION/OFFSET   |
|  | PAVEMENT/SHOULDER REMOVAL, SPECIAL |  | CONCRETE BARRIER/GUARDRAIL REMOVAL |  | TREE REMOVAL (UNITS) (NO UNIT SHOWN = <6)                     |
|  |                                    |  |                                    |  | SOIL BORING LOCATIONS   |
|  |                                    |  |                                    |  | LIGHT POLE FOUNDATION REMOVAL (SEE EXISTING ELECTRICAL PLANS) |

- NOTES:**
- ALL STATION/OFFSET/RADIUS CALLOUTS MEASURED TO EDGE OF PAVEMENT UNLESS OTHERWISE NOTED.
  - EXACT LOCATIONS OF EXISTING PIERS/ABUTMENTS TO BE FIELD VERIFIED
  - CONCRETE GUTTER SLOPE VARIES BETWEEN SB I-94 STA. 142+55.00 TO 143+23.31 (SEE DRAINAGE PLANS)

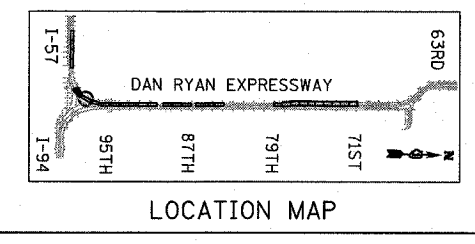

REVISIONS	
NAME	DATE

ILLINOIS DEPARTMENT OF TRANSPORTATION  
 F.A.I. 94 (DAN RYAN EXPRESSWAY)  
**EXISTING AND PROPOSED PLAN  
 SB WENTWORTH AVENUE EXIT RAMP  
 RAMP STA. 7422+00.00 TO STA. 7428+00.00**

SCALE: 1"=20'  
 DATE: MARCH 25, 2005  
 DRAWN BY: MPG  
 CHECKED BY: CL

04/14/2005 05:56:25 AM