

F.A.I. RTE.	SECTION	COUNTY	TOTAL SHEETS	SHEET NO.
94		COOK	907	92
STA. 1200+00.00		TO STA. 1365+00		
FED. ROAD DIST. NO.		ILLINOIS FED. AID PROJECT		
(1516.1, 1717 & 1818) R-9				62695

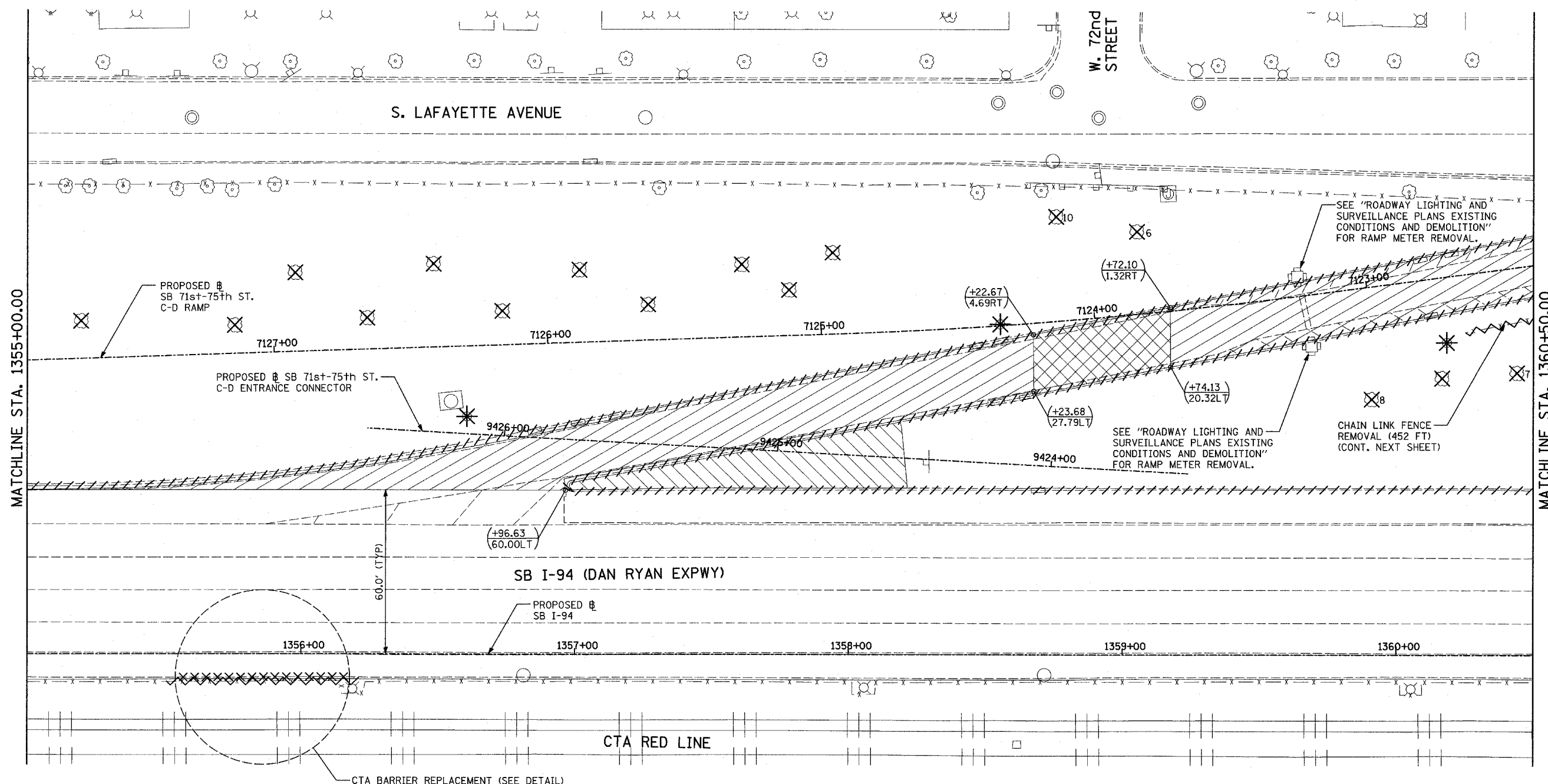

MATCHLINE STA. 1360+50.00

MATCHLINE STA. 1355+00.00

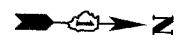
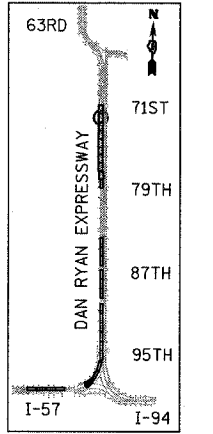

LOCATION MAP

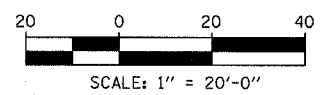

**LEGEND:**

	PAVEMENT REMOVAL		COMB CONC CURB & GUTTER REMOVAL		(+XX.XX) MAINLINE @ STATION/OFFSET
	PAVED SHOULDER REMOVAL		CHAIN LINK FENCE REMOVAL		(XX.XXRT) RAMP @ STATION/OFFSET
	PAVEMENT/SHOULDER REMOVAL, SPECIAL		CONCRETE BARRIER/GUARDRAIL REMOVAL		XX.XXRT
			TREE REMOVAL (UNITS) (NO UNIT SHOWN = <6)		
			SOIL BORING LOCATIONS		
			LIGHT POLE FOUNDATION REMOVAL (SEE EXISTING ELECTRICAL PLANS)		

**NOTES:**

- ALL STATION/OFFSET/RADIUS CALLOUTS MEASURED TO EDGE OF PAVEMENT UNLESS OTHERWISE NOTED.
- EXACT LOCATIONS OF EXISTING PIERS/ABUTMENTS TO BE FIELD VERIFIED

REVISIONS	
NAME	DATE

ILLINOIS DEPARTMENT OF TRANSPORTATION  
 F.A.I. 94 (DAN RYAN EXPRESSWAY)  
 EXISTING PLAN  
 SB 71st TO 75th STREET C-D RAMP  
 SB I-94 STA. 1355+00.00 TO 1360+50.00

SCALE: 1"=20'  
 DATE: MARCH 25, 2005

DRAWN BY: MPG  
 CHECKED BY: CL

TYLIN INTERNATIONAL

03/25/2005 11:27:37 AM