

F.A.I. RTE.	SECTION	COUNTY	TOTAL SHEETS	SHEET NO.
94		COOK	907	94
STA. 1200+00.00		TO STA. 1365+00		
FED. ROAD DIST. NO.		ILLINOIS FED. AID PROJECT		
(1516.1, 1717 & 1818) R-9				62695

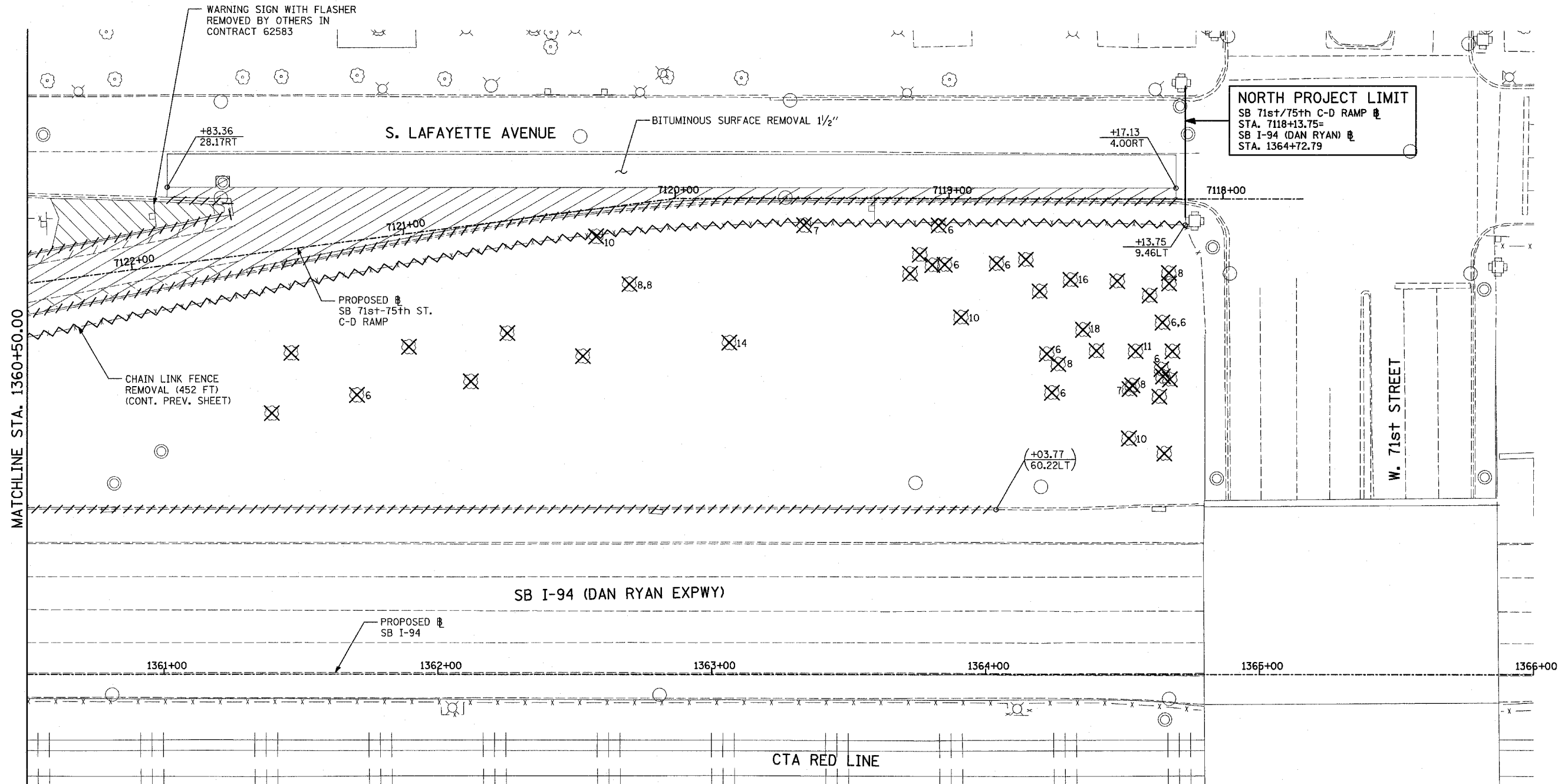

**NORTH PROJECT LIMIT**  
 SB 71st/75th C-D RAMP @  
 STA. 7118+13.75=  
 SB I-94 (DAN RYAN) @  
 STA. 1364+72.79

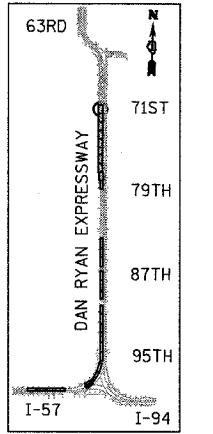

LOCATION MAP

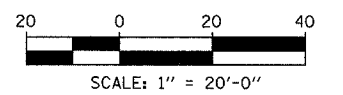

MATCHLINE STA. 1360+50.00

**LEGEND:**

- PAVEMENT REMOVAL
- PAVED SHOULDER REMOVAL
- PAVEMENT/SHOULDER REMOVAL, SPECIAL
- COMB CONC CURB & GUTTER REMOVAL
- CHAIN LINK FENCE REMOVAL
- CONCRETE BARRIER/GUARDRAIL REMOVAL
- TREE REMOVAL (UNITS) (NO UNIT SHOWN = <6)
- SOIL BORING LOCATIONS
- LIGHT POLE FOUNDATION REMOVAL (SEE EXISTING ELECTRICAL PLANS)

- (+XX.XX) MAINLINE @ STATION/OFFSET
- (XX.XXRT) STATION/OFFSET
- +XX.XX RAMP @
- XX.XXRT STATION/OFFSET

**NOTES:**

- ALL STATION/OFFSET/RADIUS CALLOUTS MEASURED TO EDGE OF PAVEMENT UNLESS OTHERWISE NOTED.
- EXACT LOCATIONS OF EXISTING PIERS/ABUTMENTS TO BE FIELD VERIFIED

**TYLIN** INTERNATIONAL

REVISIONS	
NAME	DATE

ILLINOIS DEPARTMENT OF TRANSPORTATION  
**F.A.I. 94 (DAN RYAN EXPRESSWAY)**  
 EXISTING PLAN  
 SB 71st TO 75th STREET C-D RAMP  
 SB I-94 STA. 1360+50.00 TO 1364+72.79

SCALE: 1"=20'  
 DATE: MARCH 25, 2005

DRAWN BY: MPG  
 CHECKED BY: CL

03/30/2005 11:28:30 AM