

F.A.I. RTE.	SECTION	COUNTY	TOTAL SHEETS	SHEET NO.
94		COOK	905	145
STA. 1200+00.00 TO STA. 1365+00		ILLINOIS FED. AID PROJECT		
FED. ROAD DIST. NO.		* (1516.1, 1717 & 1818) R-9		
				62695

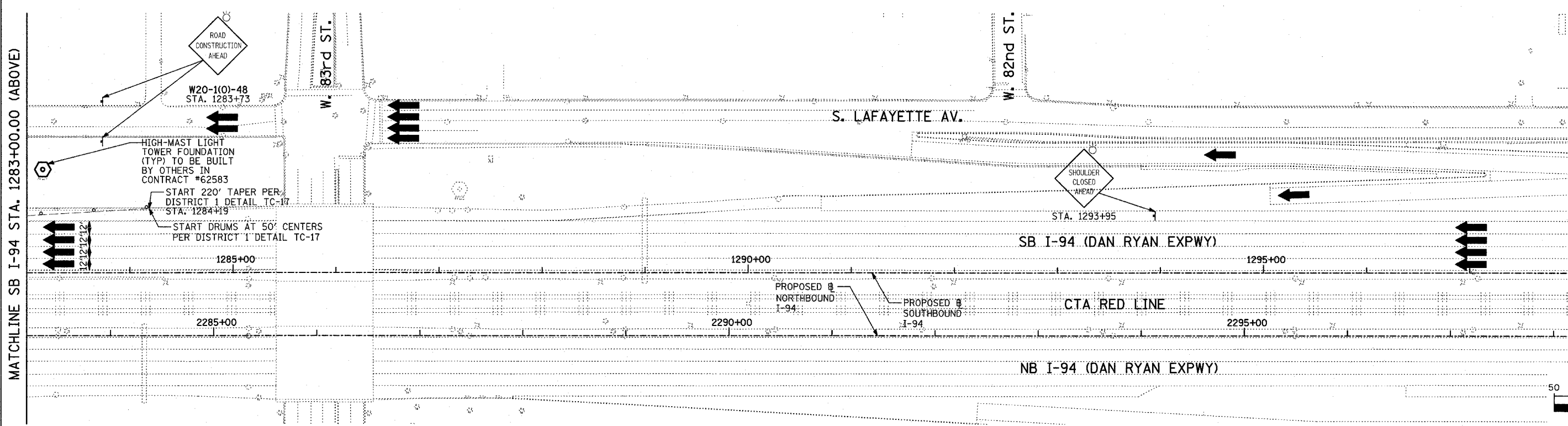
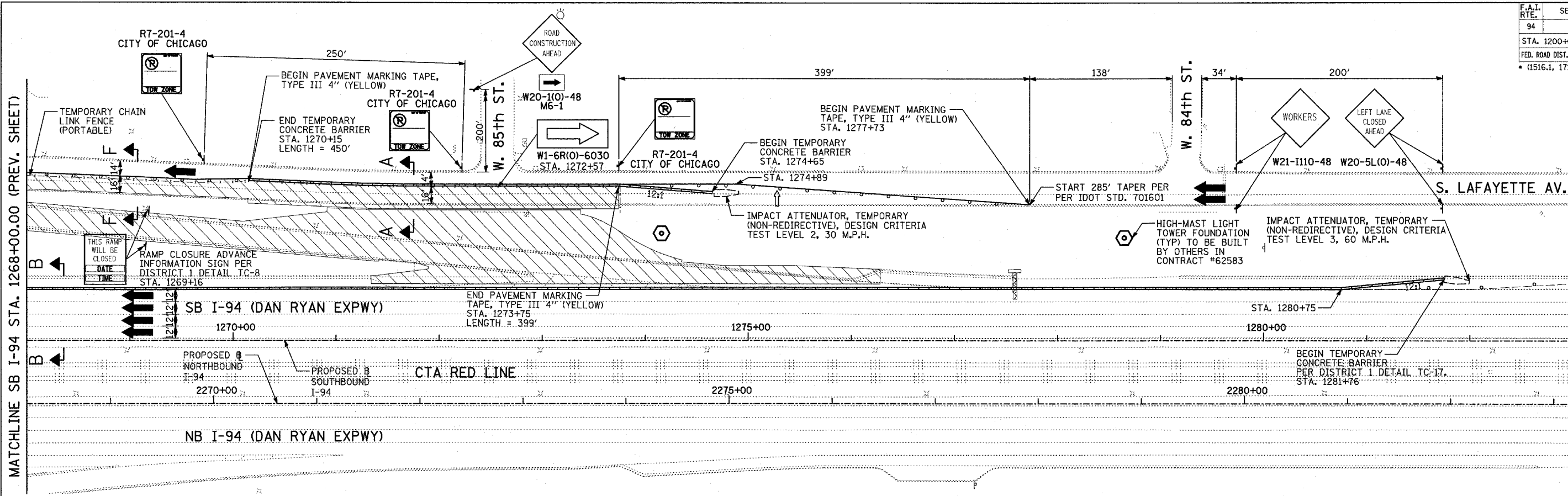

MATCHLINE SB I-94 STA. 1268+00.00 (PREV. SHEET)

MATCHLINE SB I-94 STA. 1283+00.00 (BELOW)

MATCHLINE SB I-94 STA. 1298+00.00 (NEXT SHEET)

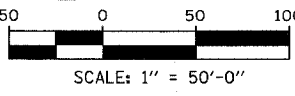
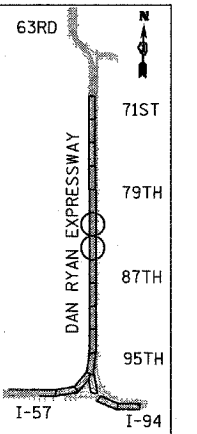

**LEGEND:**

- TEMPORARY CONCRETE BARRIER
- TRAFFIC LANE
- WORK ZONE
- BARRICADE, TYPE III
- DRUM WITH MONO-DIRECTIONAL STEADY BURNING LIGHT
- ARROW BOARD

REVISIONS	
NAME	DATE

ILLINOIS DEPARTMENT OF TRANSPORTATION  
 F.A.I. 94 (DAN RYAN EXPRESSWAY)  
 MAINTENANCE OF TRAFFIC PLAN  
 SB I-94 - STAGE 1  
 SB I-94 STA. 1268+00 TO 1298+00  
 SHEET 6 OF 9

SCALE: 1"=50'-0"  
 DATE: MARCH 25, 2005  
 DRAWN BY: JPA, RTM  
 CHECKED BY: MAG, JPM

**TYLIN** INTERNATIONAL