

F.A.I. RTE.	SECTION	COUNTY	TOTAL SHEETS	SHEET NO.
94	*	COOK	907	198
STA. 1200+00.00		TO STA. 1365+00		
FED. ROAD DIST. NO.	ILLINOIS	FED. AID PROJECT		
(1516.1, 1717 & 1818) R-9				62695

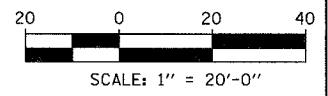
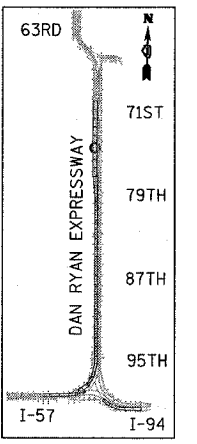
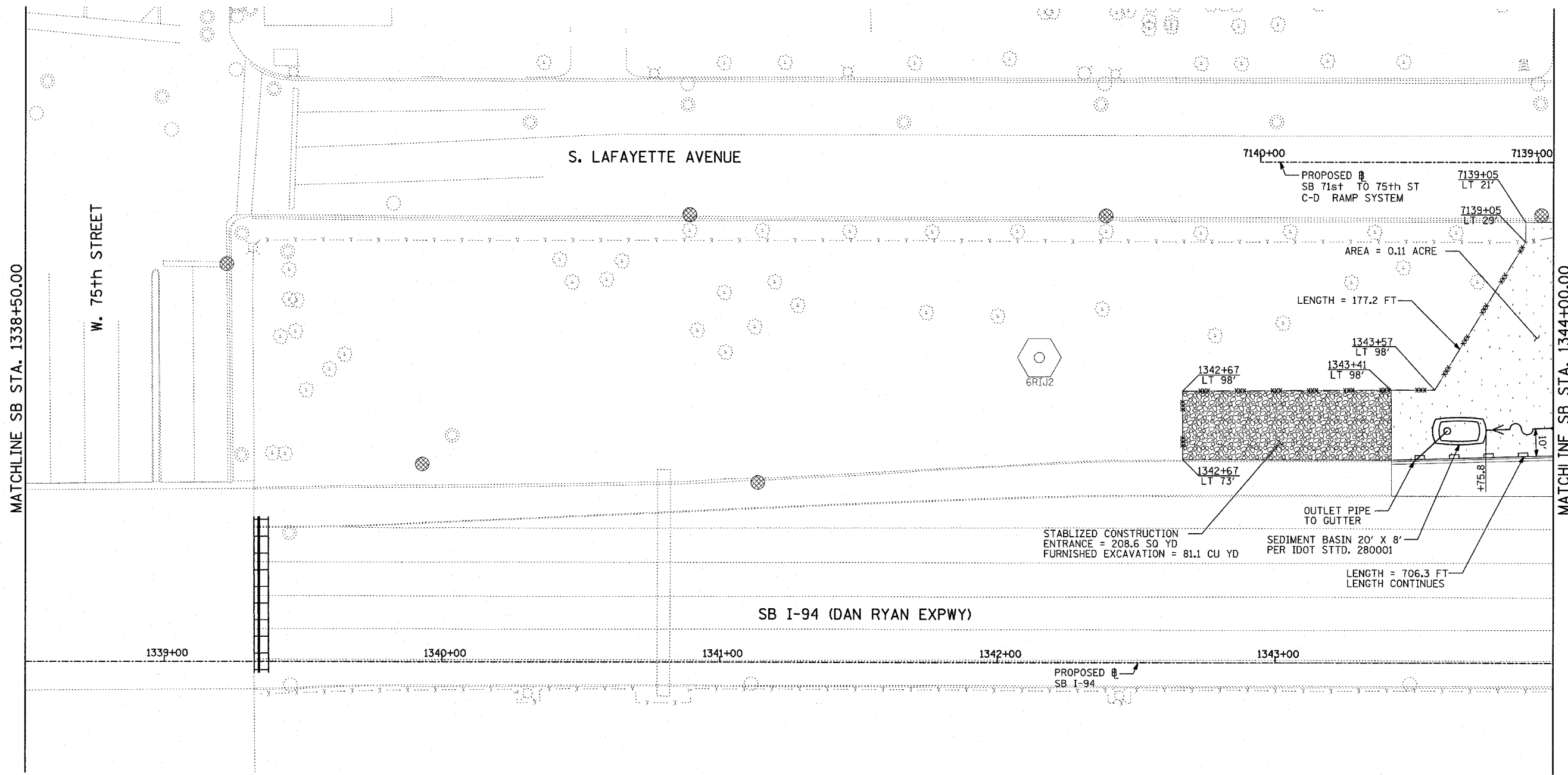

LEGEND:

- TEMPORARY EROSION CONTROL SEEDING
- PERIMETER EROSION BARRIER
- INLET FILTER, TO BE INSTALLED IN OFF PROJECT DRAINAGE STRUCTURES ACCEPTING STORMWATER RUNOFF
- TEMPORARY FENCE
- TEMPORARY DITCH
- TEMPORARY DITCH CHECK
- TEMPORARY FENCE FOR TREE PROTECTION (15 FEET PER SIDE = 60 FEET TOTAL)

REVISIONS	
NAME	DATE

ILLINOIS DEPARTMENT OF TRANSPORTATION
F.A.I. 94 (DAN RYAN EXPRESSWAY) EROSION CONTROL PLAN
SB 71st TO 75th ST C-D RAMP SYSTEM
SB I-94 STA. 1338+50.00 TO 1344+00.00
SHEET 22 OF 27

SCALE: 1"=20'
DATE: MARCH 25, 2005

DRAWN BY: JPA, AH
CHECKED BY: JPM, MAG

TYLIN INTERNATIONAL

03/30/2005 01:22:07 PM