

F.A.I. RTE.	SECTION	COUNTY	TOTAL SHEETS	SHEET NO.
94		COOK	907	210
STA. 1200+00.00 TO STA. 1365+00				
FED. ROAD DIST. NO. ILLINOIS		FED. AID PROJECT		
(1516.1, 1717 & 1818) R-9		62695		

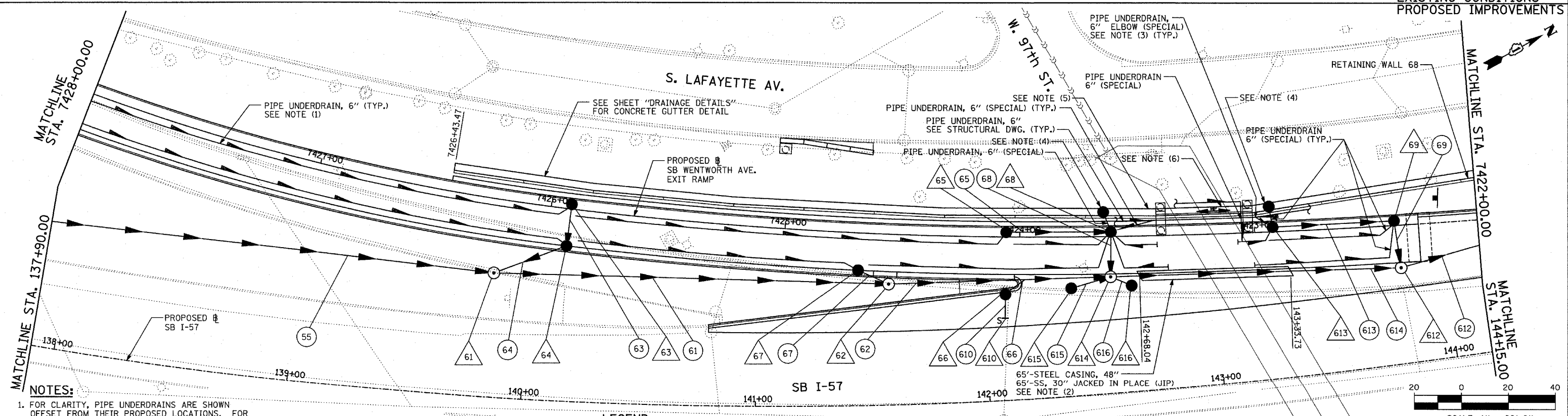
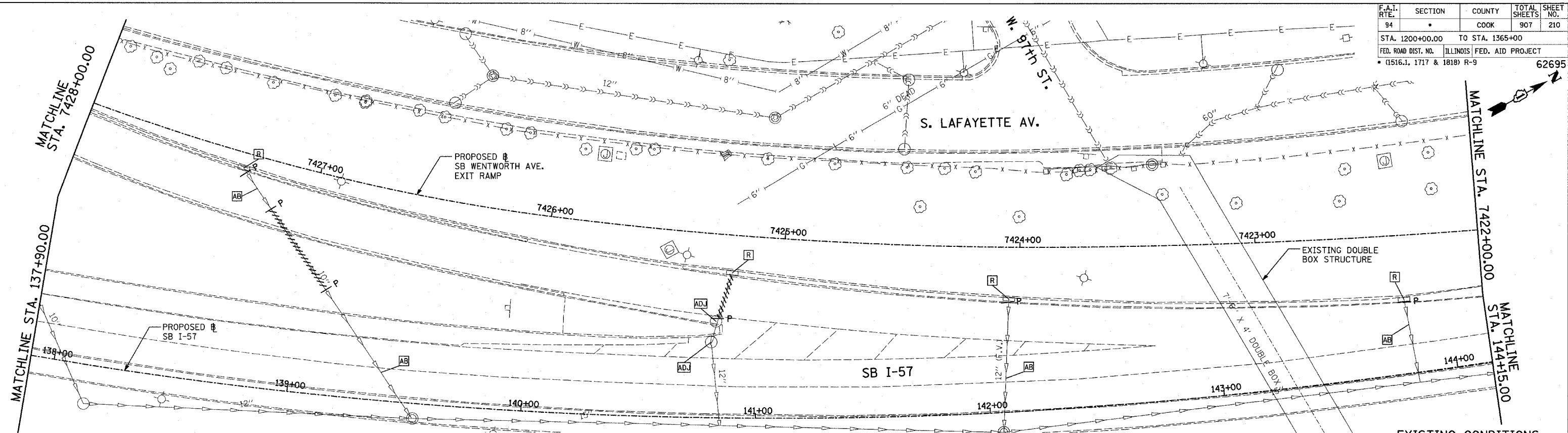

NOTES:

- FOR CLARITY, PIPE UNDERDRAINS ARE SHOWN OFFSET FROM THEIR PROPOSED LOCATIONS. FOR DETAILED PLACEMENT, SEE SHEET "PIPE UNDERDRAINS ALONG RAMPS DETAIL."
- CARE SHALL BE TAKEN NOT TO DAMAGE EXISTING CDDM COMBINED SEWER. EXISTING SEWER TO BE VIDEO TAPED BEFORE AND AFTER CONSTRUCTION. ALL WORK SHALL BE COORDINATED WITH THE CITY OF CHICAGO.
- ALL TEES AND ELBOWS/BENDS FOR PUD, 6" (SPECIAL) SHALL BE INCLUDED IN COST OF PUD, 6" (SPECIAL).
- INSTALL CONCRETE GUTTER OUTLET AS SHOWN ON THE "DRAINAGE DETAILS" SHEETS.
- GUTTER SLOPE = 2.00% BETWEEN STA 142+55.00 AND STA. 142+98.73 (© GRATE)
- GUTTER SLOPE = 3.70% BETWEEN STA 142+98.73 AND STA. 143+23.31 (© GRATE)

LEGEND:

- EXISTING COMBINED SEWER
- PROPOSED STORM SEWER NUMBER (X=SHEET NO., Y=PIPE NO.)
- PROPOSED STRUCTURE NUMBER (X=SHEET NO., Y=STRUCTURE NO.)
- PIPE STUBOUT TO BE PLUGGED
- UTILITY REMOVAL
- UTILITY REMOVAL PLUG
- HIGH MAST LIGHT TOWER FOUNDATION (BY OTHERS - SEE CONTRACT 62583)
- HIGH MAST LIGHT TOWER FOUNDATION, WALL MOUNTED
- HIGH MAST LIGHT TOWER FOUNDATION (BY OTHERS - SEE CONTRACT 62583)
- FIELD VERIFY

SHEET 6 OF 38

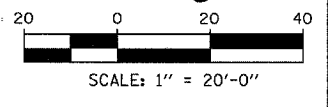

TYLIN INTERNATIONAL

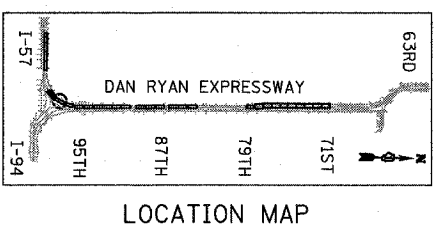

REVISIONS	
NAME	DATE
REVISION	04/15/05

ILLINOIS DEPARTMENT OF TRANSPORTATION
F.A.I. 94 (DAN RYAN EXPRESSWAY)
DRAINAGE AND UTILITY PLANS
SB WENTWORTH AVENUE EXIT RAMP
RAMP STA. 7422+00.00 TO STA. 7428+00.00

SCALE: 1"=20'
DATE: MARCH 25, 2005

DRAWN BY: MB
CHECKED BY: DA