

F.A.I. RTE.	SECTION	COUNTY	TOTAL SHEETS	SHEET NO.
94	*	COOK	907	243
STA.		TO STA.		
FED. ROAD DIST. NO.		ILLINOIS FED. AID PROJECT		
*(1516.1, 1717 & 1818) R-9		62695		

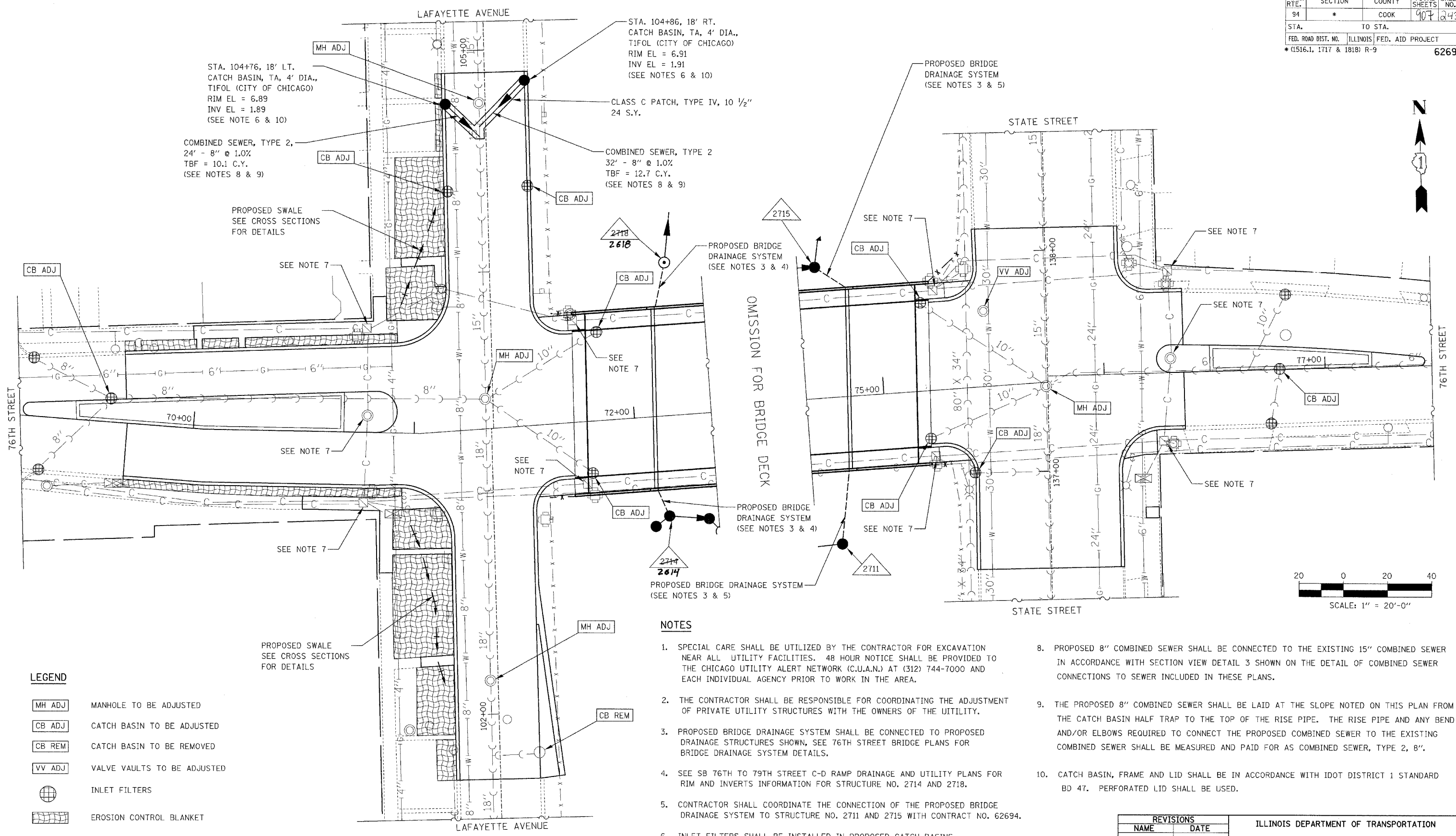

LEGEND

- MH ADJ MANHOLE TO BE ADJUSTED
- CB ADJ CATCH BASIN TO BE ADJUSTED
- CB REM CATCH BASIN TO BE REMOVED
- VV ADJ VALVE VAULTS TO BE ADJUSTED
- INLET FILTERS
- EROSION CONTROL BLANKET

NOTES

1. SPECIAL CARE SHALL BE UTILIZED BY THE CONTRACTOR FOR EXCAVATION NEAR ALL UTILITY FACILITIES. 48 HOUR NOTICE SHALL BE PROVIDED TO THE CHICAGO UTILITY ALERT NETWORK (C.U.A.N.) AT (312) 744-7000 AND EACH INDIVIDUAL AGENCY PRIOR TO WORK IN THE AREA.
2. THE CONTRACTOR SHALL BE RESPONSIBLE FOR COORDINATING THE ADJUSTMENT OF PRIVATE UTILITY STRUCTURES WITH THE OWNERS OF THE UTILITY.
3. PROPOSED BRIDGE DRAINAGE SYSTEM SHALL BE CONNECTED TO PROPOSED DRAINAGE STRUCTURES SHOWN, SEE 76TH STREET BRIDGE PLANS FOR BRIDGE DRAINAGE SYSTEM DETAILS.
4. SEE SB 76TH TO 79TH STREET C-D RAMP DRAINAGE AND UTILITY PLANS FOR RIM AND INVERTS INFORMATION FOR STRUCTURE NO. 2714 AND 2718.
5. CONTRACTOR SHALL COORDINATE THE CONNECTION OF THE PROPOSED BRIDGE DRAINAGE SYSTEM TO STRUCTURE NO. 2711 AND 2715 WITH CONTRACT NO. 62694.
6. INLET FILTERS SHALL BE INSTALLED IN PROPOSED CATCH BASINS.
7. SEE TRAFFIC SIGNAL PLANS FOR CITY ELECTRIC MANHOLE INFORMATION.
8. PROPOSED 8" COMBINED SEWER SHALL BE CONNECTED TO THE EXISTING 15" COMBINED SEWER IN ACCORDANCE WITH SECTION VIEW DETAIL 3 SHOWN ON THE DETAIL OF COMBINED SEWER CONNECTIONS TO SEWER INCLUDED IN THESE PLANS.
9. THE PROPOSED 8" COMBINED SEWER SHALL BE LAID AT THE SLOPE NOTED ON THIS PLAN FROM THE CATCH BASIN HALF TRAP TO THE TOP OF THE RISE PIPE. THE RISE PIPE AND ANY BEND AND/OR ELBOWS REQUIRED TO CONNECT THE PROPOSED COMBINED SEWER TO THE EXISTING COMBINED SEWER SHALL BE MEASURED AND PAID FOR AS COMBINED SEWER, TYPE 2, 8".
10. CATCH BASIN, FRAME AND LID SHALL BE IN ACCORDANCE WITH IDOT DISTRICT 1 STANDARD BD 47. PERFORATED LID SHALL BE USED.

REVISIONS	
NAME	DATE

ILLINOIS DEPARTMENT OF TRANSPORTATION
F.A.I. 94 (DAN RYAN EXPRESSWAY)
76TH STREET
DRAINAGE, EROSION CONTROL
AND UTILITY PLAN
 SCALE: AS SHOWN DRAWN BY: RTA
 DATE: MARCH 25, 2005 CHECKED BY: JCM



FILE: L:\62694\02_Corr\Utility\Drawings\Utility\76th\76th.dwg