

F.A.I. RTE.	SECTION	COUNTY	TOTAL SHEETS	SHEET NO.
94		COOK	907	353
STA. 1282+00.00		TO STA. 1295+00.00		
FED. ROAD DIST. NO.	ILLINOIS	FED. AID PROJECT		
(1516.1, 1717 & 1818) R-9		62695		

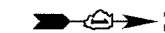

- NOTES:
- SEE DRAWINGS EI-100 AND EI-101 FOR ELECTRICAL SYMBOLS AND ABBREVIATIONS.

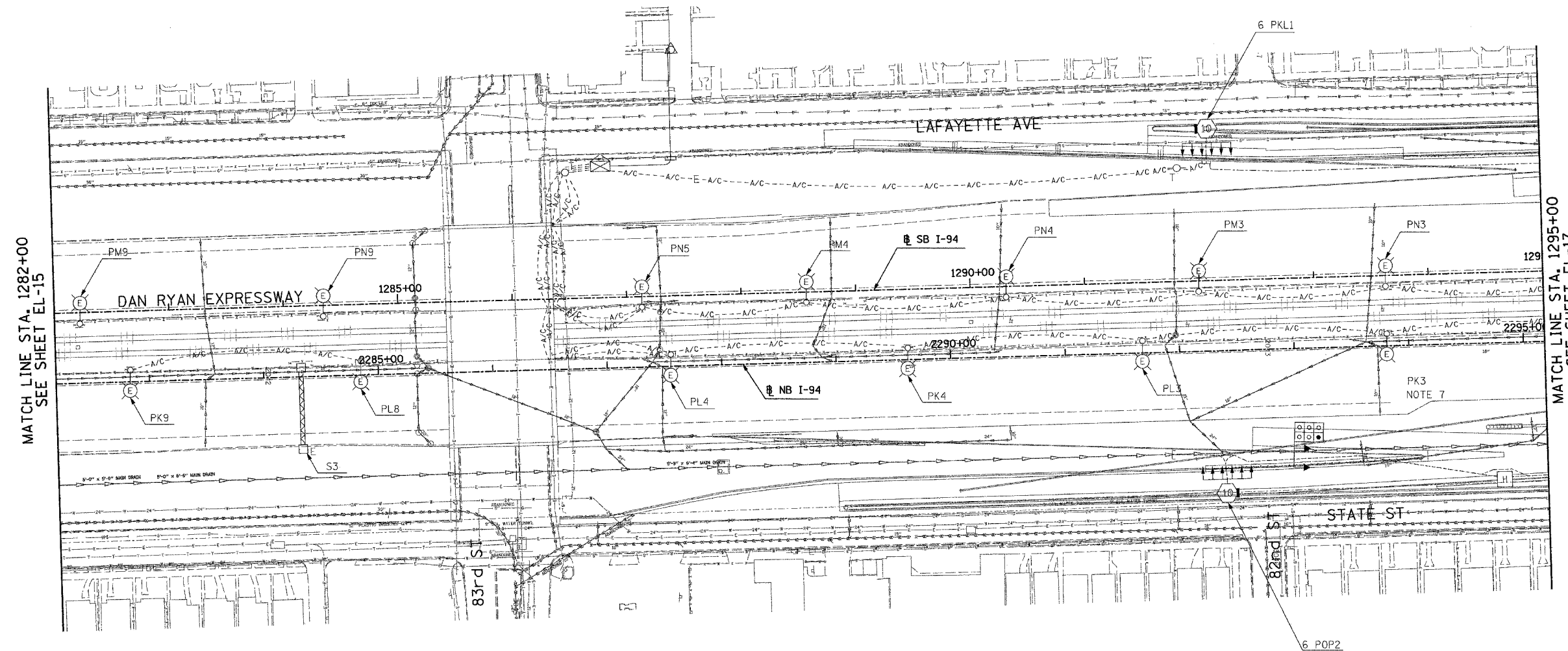

MATCH LINE STA. 1282+00
SEE SHEET EL-15

MATCH LINE STA. 1295+00
SEE SHEET EL-17



17B/EL-16

NO ELECTRICAL WORK ON THIS SHEET
FOR REFERENCE ONLY

SINGH 300 W. ADAMS ST.
CHICAGO, IL 60606
SINGH & ASSOCIATES, INC. TEL: (312) 629-0240
CONSULTING ENGINEERS FAX: (312) 629-8449

REVISIONS	
NAME	DATE
REVISED	5/06/05

ILLINOIS DEPARTMENT OF TRANSPORTATION
F.A.I. 94 (DAN RYAN EXPRESSWAY)
ROADWAY LIGHTING AND SURVEILLANCE PLANS
EXISTING CONDITIONS AND DEMOLITION
SCALE: 1"=50' DRAWN BY: VG
DATE: MARCH 25, 2005 CHECKED BY: TM

J:\175\dgn\1021753b.dwg 5/16/2005 10:52:59 AM