

F.A.I. RTE.	SECTION	COUNTY	TOTAL SHEETS	SHEET NO.
94		COOK	907	363

STA. 129+00.00 TO STA. 142+00.00
 FED. ROAD DIST. NO. ILLINOIS FED. AID PROJECT
 * (1516, 1, 1717 & 1818) R-9 62695

- NOTES:**
- SEE DRAWINGS EI-100 AND EI-101 FOR ELECTRICAL SYMBOLS AND ABBREVIATIONS.
 - COORDINATE ALL WORK WITH IDOT CONTRACTS 62583 AND 62694.
 - UNLESS NOTED OTHERWISE, ALL ITEMS AND WORK SHOWN IN HEAVY LINE WEIGHT ON THIS DRAWING ARE PROPOSED NEW ITEMS AND WORK.
 - REFER SHEET EI-102 AND ME-04 FOR DUCTBANK INSTALLATION DETAILS.
 - SEE STRUCTURAL DRAWINGS AND EI-104 FOR CONDUIT INSTALLATION DETAILS FOR LIGHT TOWER FOUNDATIONS MOUNTED ON WALL.
 - REFER TO SHEETS EI-106 AND EI-110 FOR DETAILS.
 - REFER TO SHEETS EI-103, EI-106 AND EI-110 FOR HANDHOLE DETAILS.

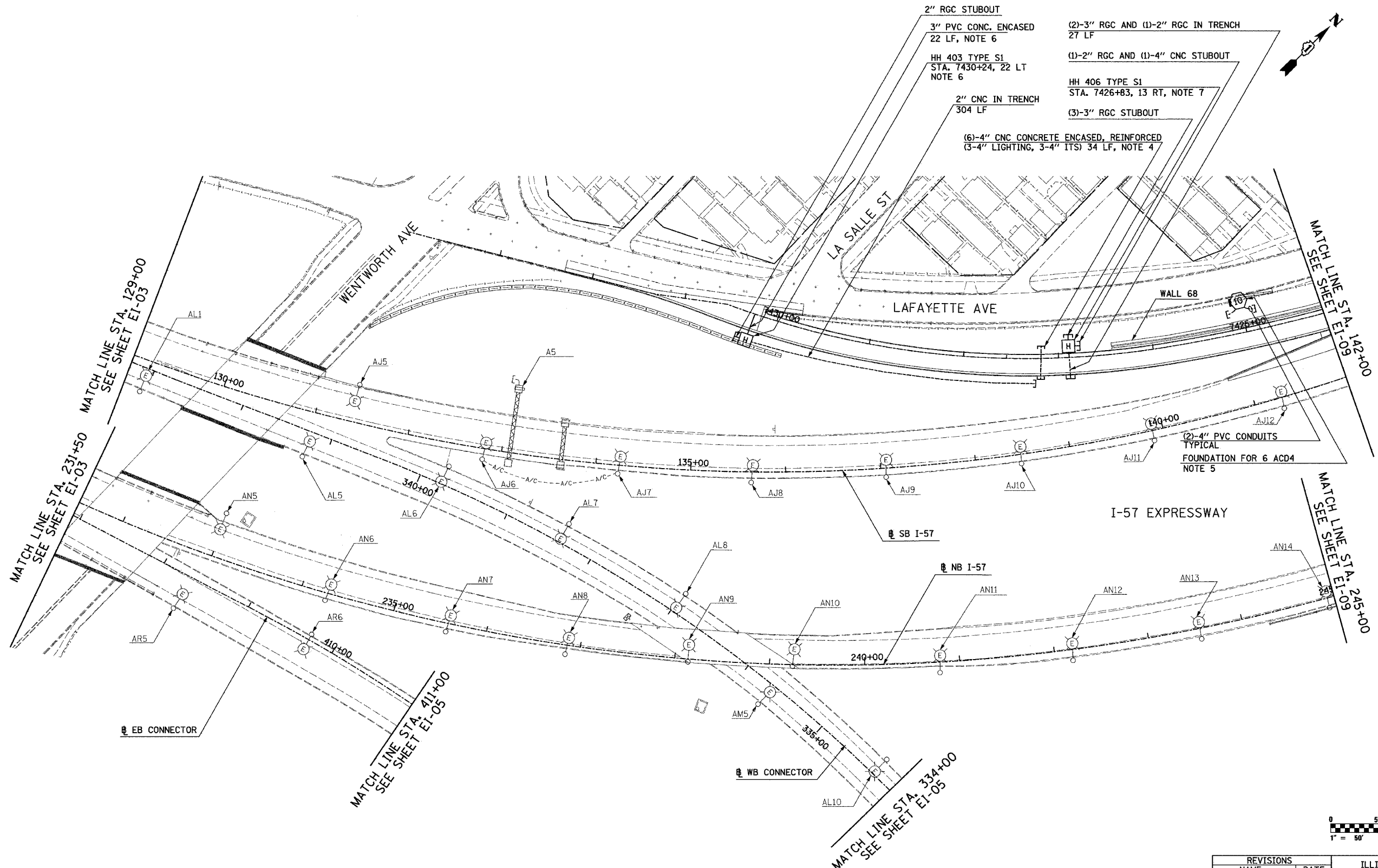

17B/EI-04

REVISIONS	
NAME	DATE
REVISED	5/06/05

ILLINOIS DEPARTMENT OF TRANSPORTATION
 F.A.I. 94 (DAN RYAN EXPRESSWAY)

ELECTRICAL INFRASTRUCTURE PLANS
 PROPOSED IMPROVEMENTS

SCALE: 1"=50' DRAWN BY: VG
 DATE: MARCH 25, 2005 CHECKED BY: TM

SINGH 300 W. ADAMS ST.
 CHICAGO, IL 60606
 SINGH & ASSOCIATES, INC. TEL: (312) 629-0240
 CONSULTING ENGINEERS FAX: (312) 629-8449

J:\175\ggn\10217536.ctb 04-07-05 10:02:42 AM