

F.A.I. RTE.	SECTION	COUNTY	TOTAL SHEETS	SHEET NO.
94	*	COOK	907	380
STA.		TO STA.		
FED. ROAD DIST. NO.		ILLINOIS FED. AID PROJECT		
(1516.1, 1717 & 1818) R-9		62695		

NOTES:

- SEE DRAWINGS EI-100 AND EI-101 FOR ELECTRICAL SYMBOLS AND ABBREVIATIONS.
- COORDINATE ALL WORK WITH IDOT CONTRACTS 62583 AND 62694.
- UNLESS NOTED OTHERWISE, ALL ITEMS AND WORK SHOWN IN HEAVY LINE WEIGHT ON THIS DRAWING ARE PROPOSED NEW ITEMS AND WORK.
- REFER TO SHEETS EI-106 AND EI-110 FOR DETAILS..
- REFER TO SHEET EI-107 FOR COMMUNICATIONS VAULT CI DETAILS
- REFER TO SHEETS EI-102 AND ME-04 FOR DUCTBANK INSTALLATION DETAILS.
- REFER TO SHEETS EI-103, EI-106 AND EI-110 FOR HANDHOLE DETAILS.
- SIGN STRUCTURE SHALL BE PROVIDED UNDER THIS CONTRACT. SIGN LUMINAIRES, DISCONNECT SWITCH, WIRING AND CONNECTIONS SHALL BE PROVIDED UNDER CONTRACT 62583.

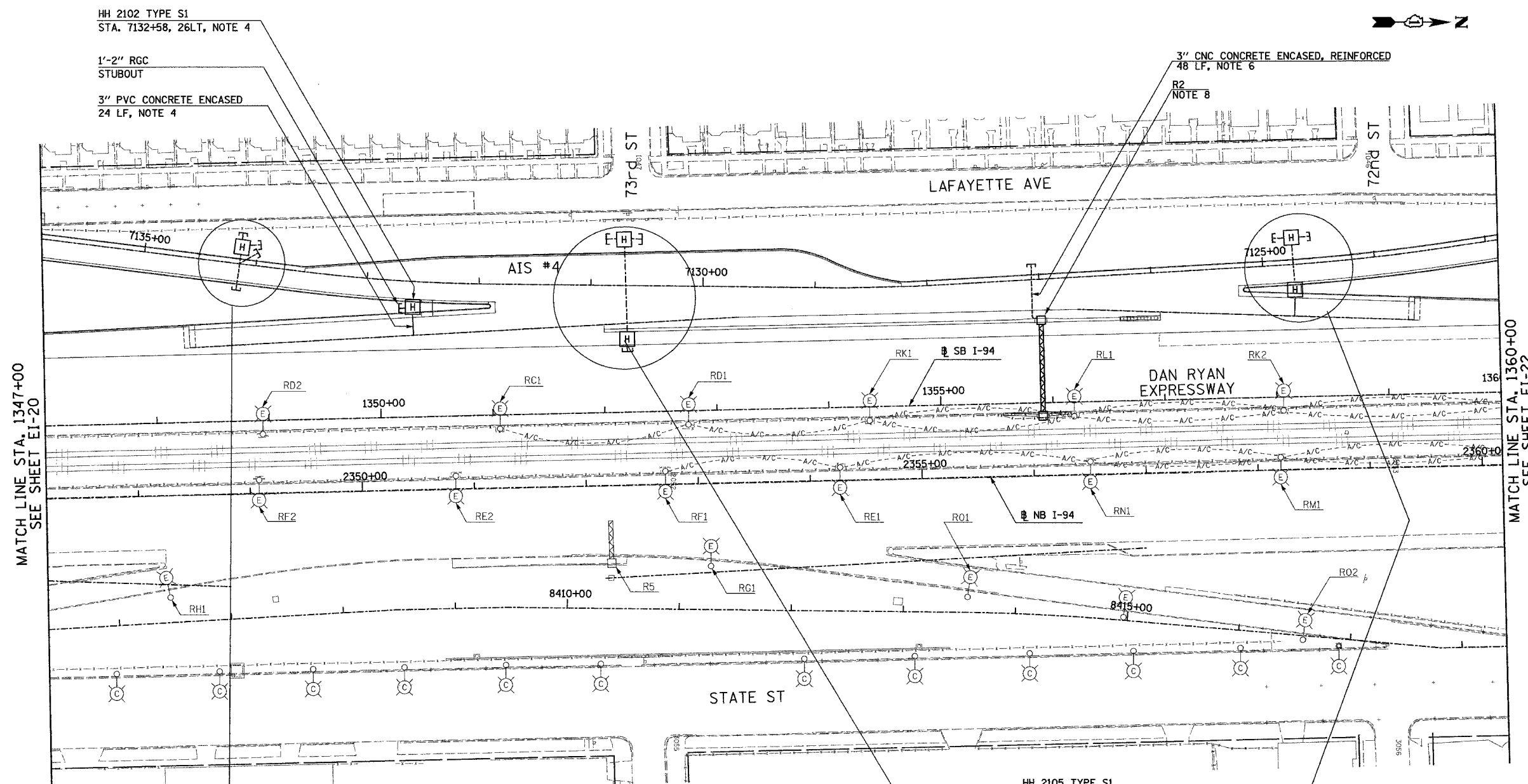

HH 2102 TYPE S1
STA. 7132+58, 26LT, NOTE 4

1'-2" RGC
STUBOUT

3" PVC CONCRETE ENCASED
24 LF, NOTE 4

3" CNC CONCRETE ENCASED, REINFORCED
48 LF, NOTE 6

R2
NOTE 8

MATCH LINE STA. 1347+00
SEE SHEET EI-20

MATCH LINE STA. 1360+00
SEE SHEET EI-22

3" RGC
STUBOUT

HH 2101 TYPE C1,
STA. 7134+14, 15RT, NOTE 5

(1)-2" RGC AND (1)-4" PVC
STUBOUTS

(4)-4" CNC CONCRETE ENCASED, REINFORCED
(2)-4" LIGHTING, 2-4" ITS, 40 LF, NOTE 6

(6)-4" CNC AND (2)-2" CNC CONCRETE ENCASED,
REINFORCED, 35 LF, NOTE 6

HH 2103 TYPE S1
STA. 7130+69, 32RT, NOTE 7

(3)-3" RGC STUBOUTS
TYPICAL

HH 2105 TYPE S1
STA. 7124+73, 24 RT, NOTE 7

2" RGC STUB-OUT
TYPICAL

2" RGC IN TRENCH, 62 LF

HH 2106 TYPE S1
STA. 7124+71, 24 LT, NOTE 7

2" RGC IN TRENCH, 77 LF

HH 2104 TYPE S1
STA. 7130+67, 48LT, NOTE 7

1'-2" RGC
STUBOUT

3" PVC CONCRETE ENCASED
24 LF, NOTE 4



17B/EI-21

REVISIONS		
NAME	DATE	
REVISED	5/06/05	

ILLINOIS DEPARTMENT OF TRANSPORTATION
F.A.I. 94 (DAN RYAN EXPRESSWAY)

ELECTRICAL INFRASTRUCTURE PLANS
PROPOSED IMPROVEMENTS

SCALE: 1"=50' DRAWN BY: VG
DATE: MARCH 25, 2005 CHECKED BY: TM

SINGH 300 W. ADAMS ST.
CHICAGO, IL 60606
SINGH & ASSOCIATES, INC. TEL: (312) 629-0240
CONSULTING ENGINEERS FAX: (312) 629-8449

5/16/2005 12:32:32 PM