

Benchmarks: BM 3549 Set "A" westerly flange bolt of hydrant at southwest intersection of 87th St. and Lafayette Ave.. El. 9.49

Existing Structure: None.

F.A.I. RTE.	SECTION	COUNTY	TOTAL SHEETS	SHEET NO.
94		COOK	907	554
STA. 1200+00.00 TO STA. 1365+00				
FED. ROAD DIST. NO.		ILLINOIS	FED. AID PROJECT	
(1516.1, 1717 & 1818) R-9		62695		

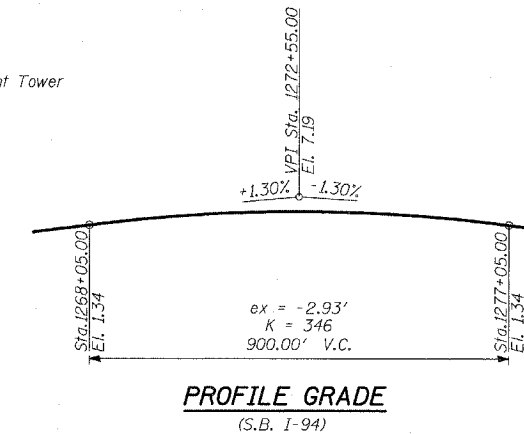
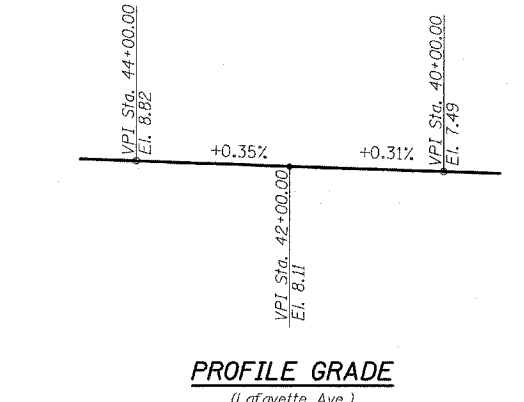
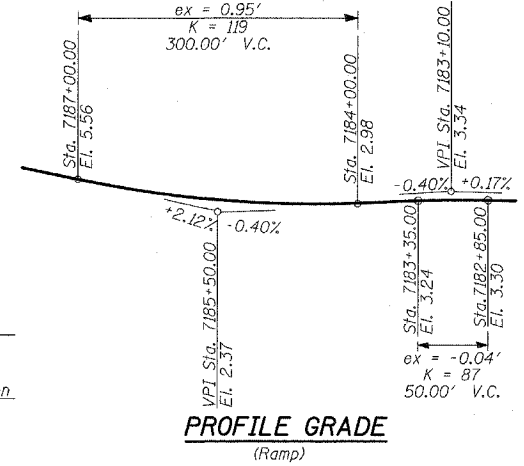
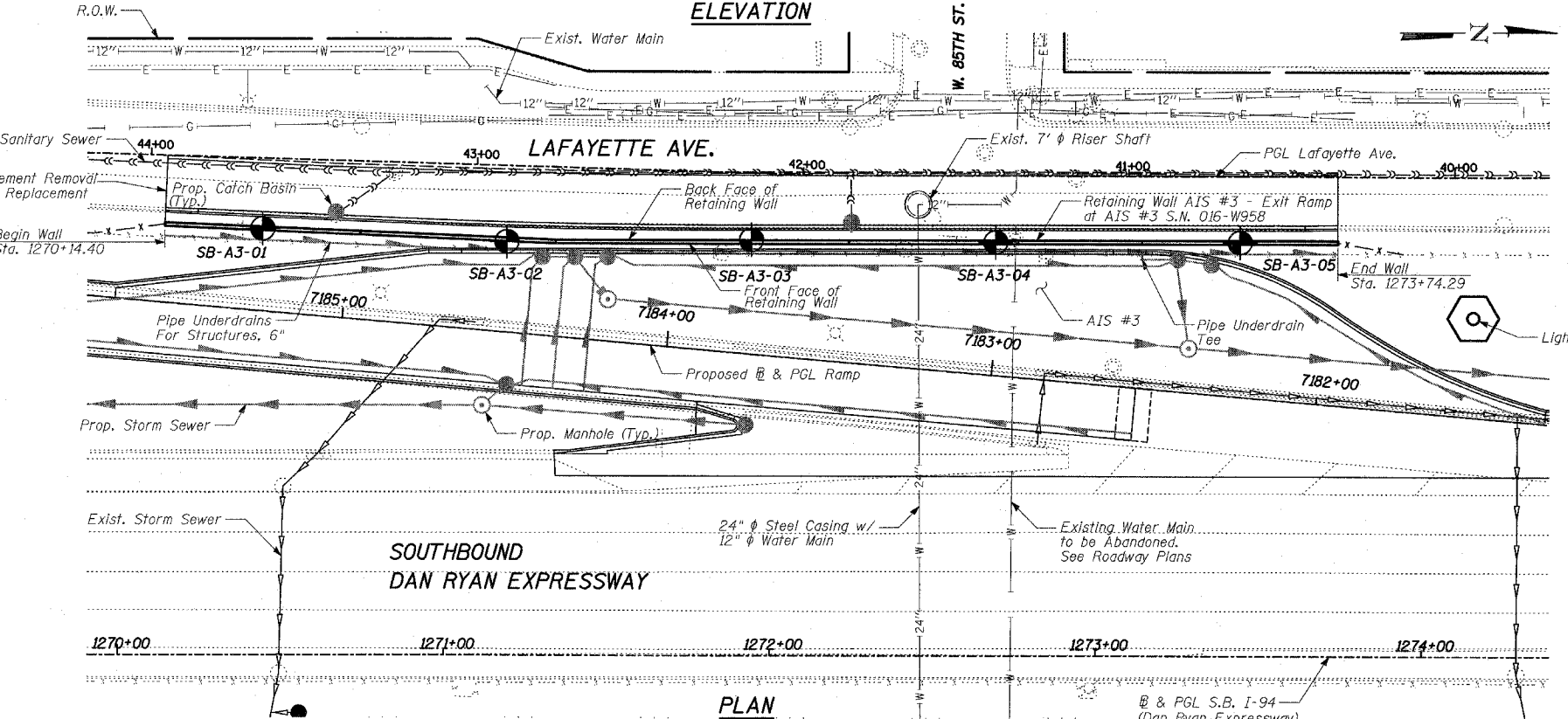
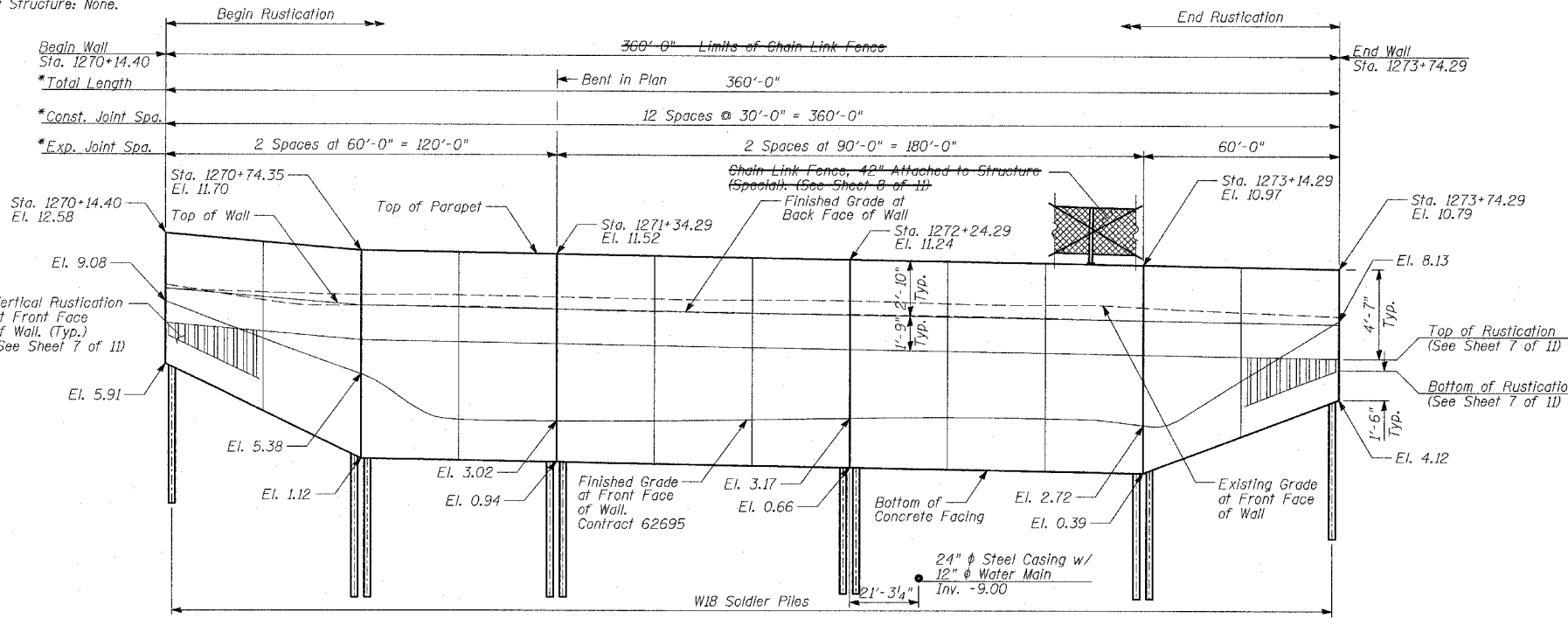

TOTAL BILL OF MATERIAL

ITEM	UNIT	TOTAL
Structure Excavation	CU YD	320
Concrete Structures	CU YD	157
Protective Coat	SQ YD	481
Rustication Finish	SQ FT	2,039
Stud Shear Connectors	EACH	444
Untreated Timber Lagging	SQ FT	2,076
Furnishing Soldier Piles (W Section)	FOOT	1,608
Reinforcement Bars, Epoxy Coated	POUND	19,350
Geocomposite Wall Drain	SQ YD	251
Pipe Underdrains For Structures, 6"	FOOT	360
Drilling and Setting Soldier Piles (in Soil)	CU FT	8,340
Chain Link Fence, 42" Attached to Structure (Special)	FOOT	360

DESIGN SPECIFICATION
AASHTO 2002 Standard Specifications
for Highway Bridges

DESIGN STRESSES
FIELD UNITS
f'c = 3,500 psi
fy = 60,000 psi (Reinforcement)
fy = 36,000 psi (M270 Grade 36)
Soldier Piles

INDEX OF SHEETS

- GENERAL PLAN
- PLAN AND ELEVATION STA. 1270+14.40 TO STA. 1271+34.29
- PLAN AND ELEVATION STA. 1271+34.29 TO STA. 1273+14.29
- PLAN AND ELEVATION STA. 1273+14.29 TO STA. 1273+74.29
- PILE LAYOUT, DETAILS & BILL OF MATERIAL
- WALL CROSS SECTIONS & DETAILS
- RUSTICATION DETAILS
- CHAIN LINK FENCE, 42" ATTACHED TO STRUCTURE (SPECIAL)
- BORING LOGS SB-A3-01 & SB-A3-02
- BORING LOGS SB-A3-03 & SB-A3-04
- BORING LOGS SB-A3-05

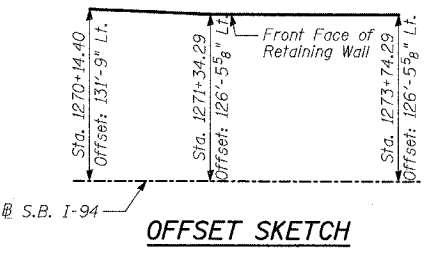

LEGEND

- Boring Location
- * Measured along Front Face of Wall.

- GENERAL NOTES:**
- Reinforcement bars shall conform to the requirements of AASHTO M31 or M322 Grade 60.
 - The Contractor is responsible for the design and performance of the lagging using no less than 3" nominal rough-sawn thickness and the minimum tabulated unit stress in bending (fb), used in the design of timber lagging shall be 1000 psi.
 - The soldier piles shall be cleaned and given one shop coat of Inorganic Zinc-Rich primer.
 - All exposed concrete edges shall be chamfered 3/4" except as noted.
 - Protective Coat shall be applied to exposed surfaces of the concrete facing.
 - Existing utilities in conflict with soldier pile wall construction shall be abandoned or relocated according to directions given on the roadway plans.
 - All construction joints shall be bonded.
 - All elevations shown are based on the Chicago City Datum of 0.00, which is 579.19 feet above mean tide New York. (NAVD 88)
 - The wall shall be backfilled (where applicable) prior to placing the concrete facing.
 - Riser Shaft and Jacking Pit to have been constructed by others in Contract 24B.
 - The Contractor is responsible to coordinate all electrical crossings with this Contract and with Contract 62583.

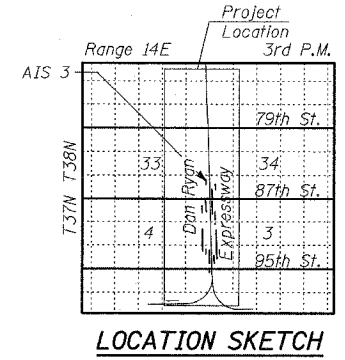

Signed: Phillip D. Frey
Date: 3/25/05
For drawings 1 thru 11 of 11

REVISIONS	NAME	DATE
REVISED		04/15/05

ILLINOIS DEPARTMENT OF TRANSPORTATION
F.A.I. 94 (DAN RYAN EXPRESSWAY)
RETAINING WALL ALONG LAFAYETTE AVE.
EXIT RAMP AT AIS #3
AIS 3 - GENERAL PLAN
STA. 1270+14.40 TO STA. 1273+74.29
S.N. 016-W958
SCALE: N.T.S.
DATE: MARCH 25, 2005

DESIGNED BY: MI, DJR
DRAWN BY: DJR, TB
CHECKED BY: TD, MI