

GENERAL NOTES:

Fasteners shall be high strength bolts. Bolts $\frac{1}{2}$ " ϕ , open holes $\frac{1}{8}$ " ϕ , unless otherwise noted.

Calculated weight of Structural Steel = 658,683 lb. M 270 Grade 50.
 Calculated weight of Structural Steel = 52,485 lb. M 270 Grade 36.

Field welding of construction accessories will not be permitted to beams or girders.

Anchor bolts shall be set before bolting diaphragms over supports.

The structural steel bearing plates and fill plates of the Elastomeric Bearing Assembly shall conform to the requirements of AASHTO M270 Grade 50.

The main load carrying member components subject to tensile stress shall conform to the Supplemental Requirements for Notch Toughness Zone 2. These components are the tension flanges, webs and all splice plate material except fill plates.

Reinforcement Bars shall conform to the requirements of AASHTO M 31 or M 322 Grade 60.

The back face of Closed Abutments and their wingwalls shall be waterproofed according to Article 503.18 of the Standard Specifications.

Bearing seat surfaces shall be constructed or adjusted to the designated elevations within a tolerance of $\frac{1}{8}$ ". Adjustments shall be made either by grinding the surface or by shimming the bearing. Two $\frac{1}{8}$ " adjusting shims, of the dimensions of the bottom bearing plate, shall be provided for each bearing in addition to all other plates or shims. For Type I Elastomeric Bearings, two $\frac{1}{8}$ " adjusting shims shall be provided for each bearing and placed as detailed.

Bridge Seat Sealer shall be applied to the seat area of the abutments.

All construction joints shall be bonded.

All exposed edges shall be chamfered $\frac{3}{4}$ " except as noted.

Before any removal work begins, it is the Contractor's responsibility to ensure that all utility attachments are disconnected. The Contractor shall coordinate protection of all utility attachments. Any attached utilities on the bridge shall be removed and the cost included with item "Removal of Existing Structures No. 3".

All structural steel shall receive a thermal sprayed metal coating (metallizing) in the shop. See Special Provisions for Metallizing Structural Steel.

Elevations shown are based on City of Chicago Datum.
 USGS Elevation = City of Chicago Datum + 579.19

TOTAL BILL OF MATERIAL

ITEM	UNIT	SUPER	SUB	TOTAL
Removal Of Existing Structures No. 3	Each			1
Porous Granular Embankment	Cu. Yd.		2828	2828
Structure Excavation	Cu. Yd.		6392	6392
Concrete Structures	Cu. Yd.		1726	1726
Concrete Superstructure	Cu. Yd.	784		784
Bridge Deck Grooving	Sq. Yd.	1943		1943
Protective Coat	Sq. Yd.	2697		2697
Metallizing Structural Steel	L. Sum	1		1
Elastomeric Bearing Assembly, Type I	Each	24		24
Furnishing And Erecting Structural Steel	Pound	711168		711168
Stud Shear Connectors	Each	4932		4932
Reinforcement Bars, Epoxy Coated	Pound	168240	174980	343220
Temporary Sheet Piling	Sq. Ft.		5040	5040
Braced Excavation Spoil	Cu. Yd.		216	216
Name Plates	Each		1	1
Bridge Seat Sealer	Sq. Ft.		422	422
Pipe Underdrains for Structures 6"	Foot		356	356
Drainage Scuppers DS-II	Each	10		10
Drainage System	L. Sum	1		1
Bar Splicers	Each	164		164
Bridge Fence Railing	Foot	546	148	694
Protective Shield	Sq. Yd.	4727		4727
Strip Seal Expansion Joint Assembly	Foot	167		167

F.A.I. RTE.	SECTION	COUNTY	TOTAL SHEETS	SHEET NO.
94	"	COOK	907	612
STA. TO STA.				
FED. ROAD DIST. NO. (ILLINOIS)	FED. AID PROJECT			
(1516.), 1717 & 1818) R-9	62695			

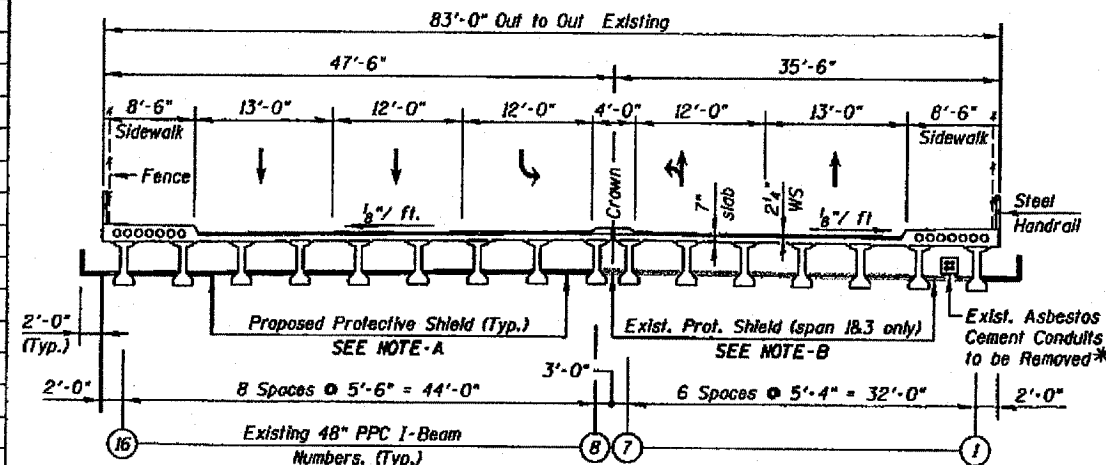

EXISTING DECK CROSS SECTION (Looking East)

NOTE - A

Proposed protective shield shall be provided during removal of the existing superstructure for the entire length and width of the existing bridge. The limits of the protective shield shall be as shown or as approved by the Engineer.

NOTE - B

The entire existing protective shield shall be removed and salvaged. Salvaged material shall be taken to the IDOT Maintenance Yard located at: 1101 Bluestem Road Elk Grove Village, Illinois

Proposed protective shield shall be provided during deck pouring for the entire length and width of the proposed bridge. The limits of the protective shield shall be as shown or as approved by the Engineer.

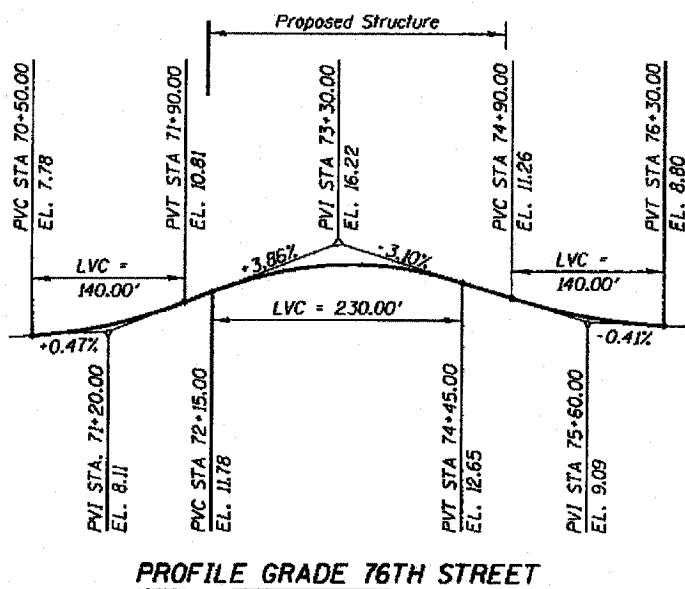

PROFILE GRADE 76TH STREET

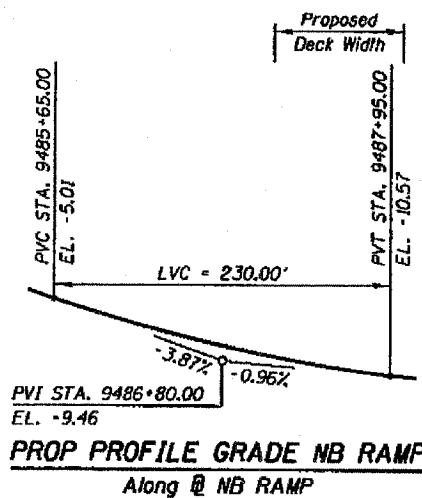

PROP PROFILE GRADE NB RAMP Along @ NB RAMP

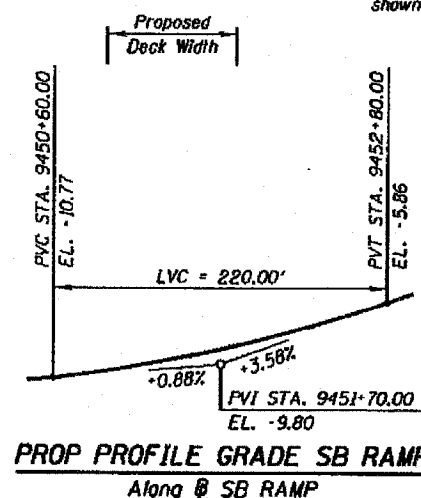

PROP PROFILE GRADE SB RAMP Along @ SB RAMP

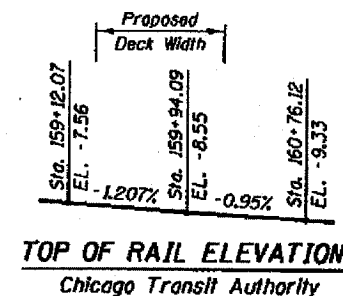

TOP OF RAIL ELEVATIONS Chicago Transit Authority

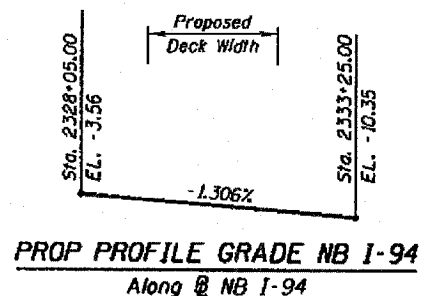

PROP PROFILE GRADE NB I-94 Along @ NB I-94

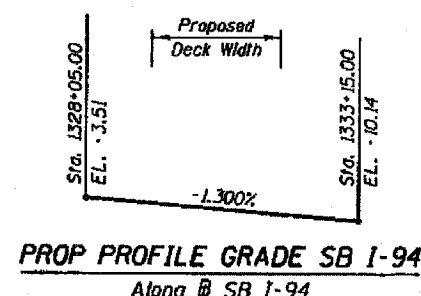

PROP PROFILE GRADE SB I-94 Along @ SB I-94

FILE: L:\6892\02\civil\sheet1\Revised 178\04-15-05\6892-2650-0402 Rev 041505.dgn

KNIGHT
Engineers & Architects

REVISIONS	
NAME	DATE
REVISED	05/26/05
REVISED	04/15/05

DWG. S-02 of 42
 ILLINOIS DEPARTMENT OF TRANSPORTATION
NOTES & TOTAL BILL OF MATERIAL
76TH STREET OVER FAI-94
 FAP ROUTE 1541 SECTION 1818 R-9
 COOK COUNTY
 STATION 73+49.33
 STRUCTURE NUMBER 016-2850

SCALE: NONE
 DATE: March 25, 2005
 DESIGNED BY: WPM
 CHECKED BY: TB