

F. A. NO.	SECTION	COUNTY	TOTAL SHEETS	SHEET NO.
			907	811
STA.		TO STA.		
FED. ROAD DIST. NO.	ILLINOIS	FED. AID PROJECT		

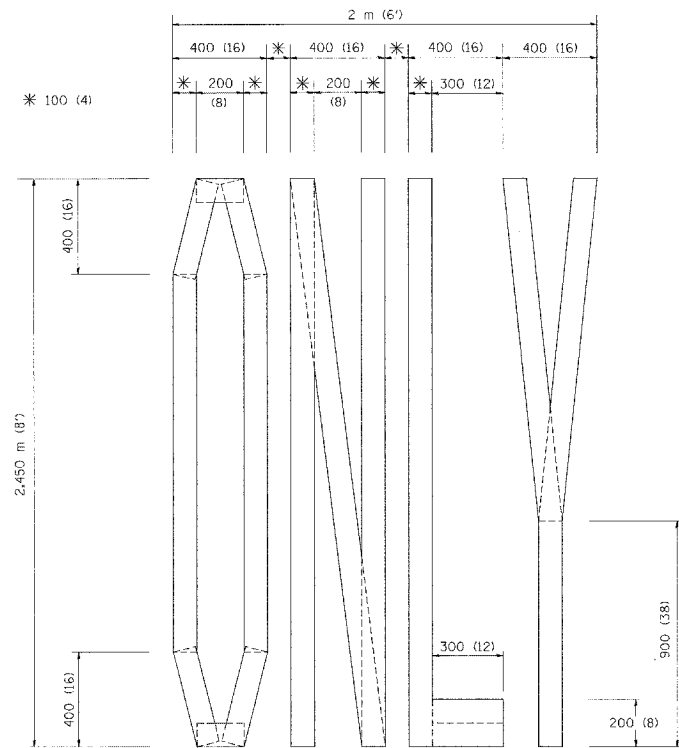

QUANTITY  
 100 (4) LINE = 19.7 m (64.1 ft.)  
 1.97 sq. m (21.1 sq. ft.)

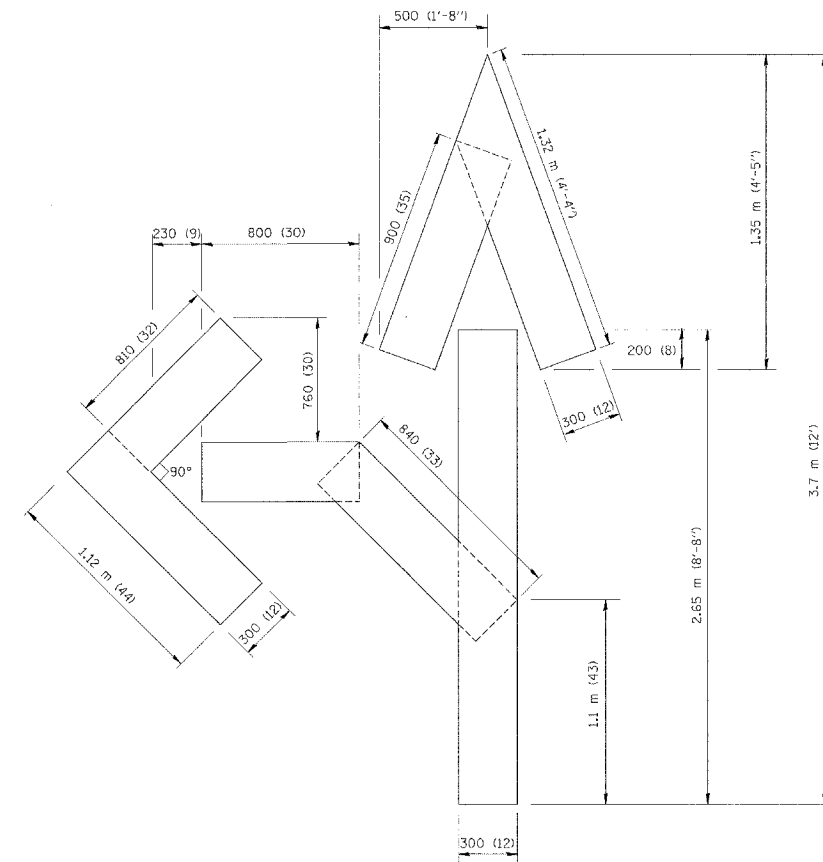

QUANTITY  
 100 (4) LINE = 25.3 m (82.5 ft.)  
 2.53 sq. m (27.5 sq. ft.)

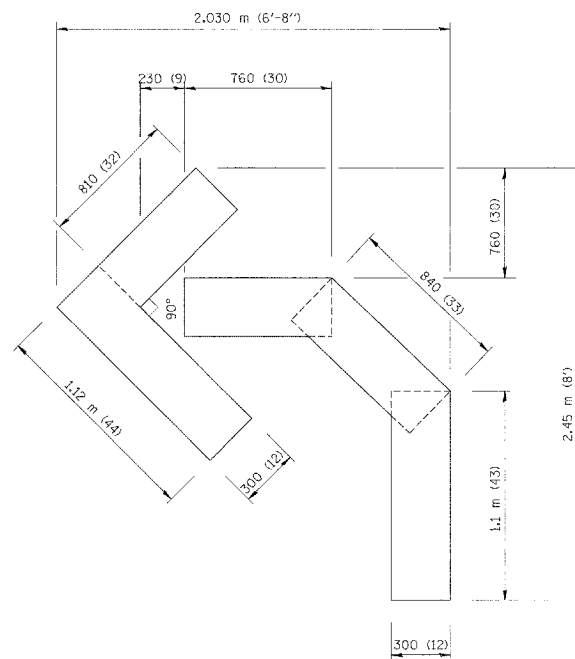

QUANTITY  
 100 (4) LINE = 13.9 m (45.5 ft.)  
 1.39 sq. m (15.2 sq. ft.)

All dimensions are in millimeters (inches) unless otherwise shown.

ILLINOIS DEPARTMENT OF TRANSPORTATION

**PAVEMENT MARKING LETTERS AND SYMBOLS FOR TRAFFIC STAGING**

SCALE: NONE  
 DATE: 10/18/2002

DRAWN BY: CADD  
 CHECKED BY: TC-16  
 REVISION DATE: 08/28/00

REVISIONS		
NAME	DATE	
T. RAMMACHER	09/18/94	
J. OBERLE	06/01/96	
T. RAMMACHER	06/05/96	
T. RAMMACHER	11/04/97	
T. RAMMACHER	03/02/98	
E. GOMEZ	08/28/00	