

PLOTTED  
 GRADES CHECKED  
 STRUCTURE NOTATIONS OK'D  
 NO. \_\_\_\_\_

F.A.I. RTE.	SECTION	COUNTY	TOTAL SHEETS	SHEET NO.
90/94	•	COOK	907	828
STA. 1200+00.00 TO STA. 1365+00				
FED. ROAD DIST. NO.		ILLINOIS FED. AID PROJECT		
• (1516, 1717 & 1818) R-9		62695		

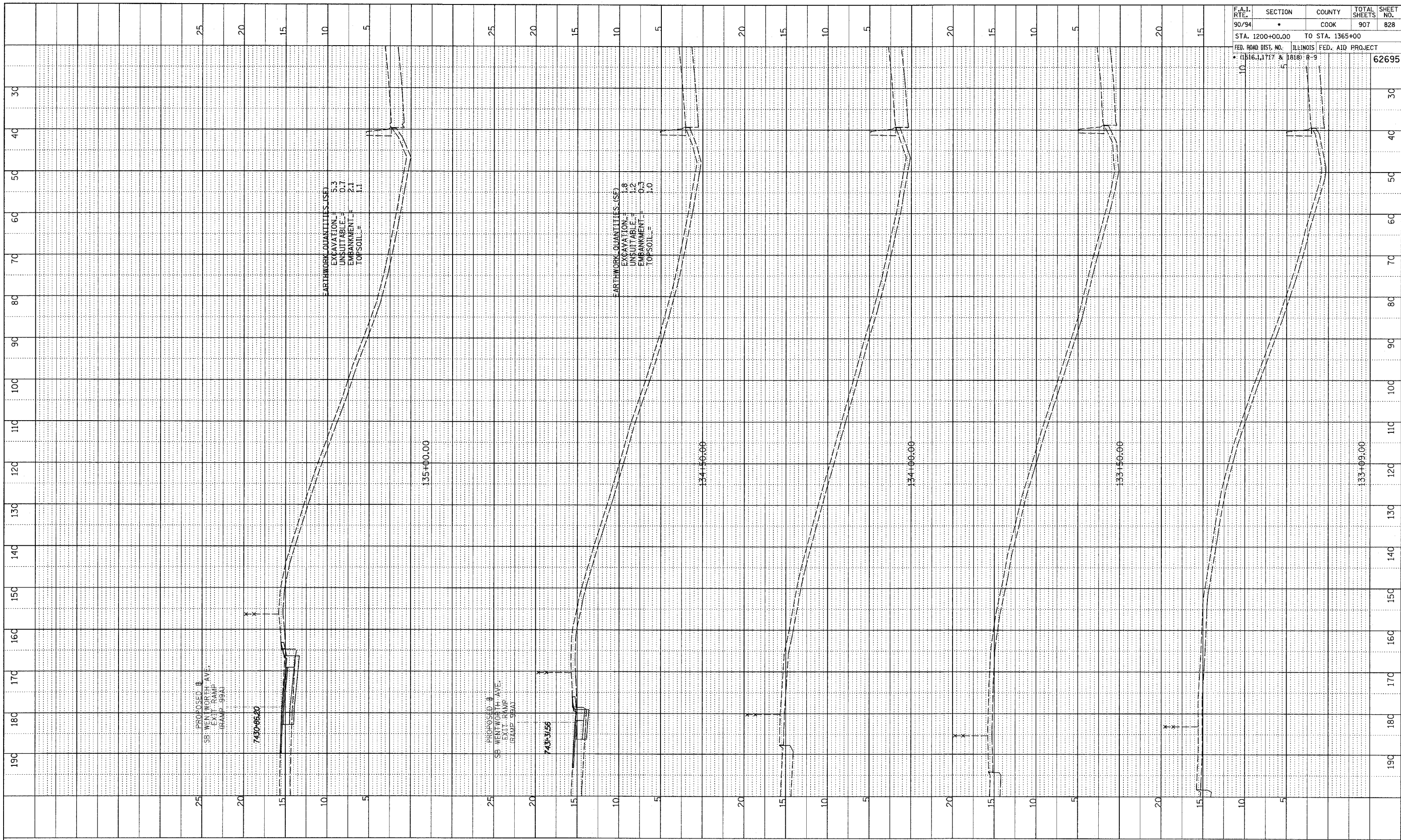

TYLIN INTERNATIONAL

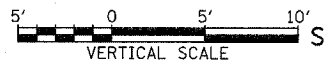

SB WENTWORTH AVENUE EXIT RAMP  
 STA. 133+09 TO STA. 135+00

DWG: 231 (road) / 17 (bridge) / 1 (mass) / 1 (gen)