

NOTE BOOK
 GRADES CHECKED
 STRUCTURE NOTATION CHNG
 NO. _____
 REVISED 05/06/05

F.A.I. RTE.	SECTION	COUNTY	TOTAL SHEETS	SHEET NO.
90/94		COOK	907	832
STA. 1200+00.00 TO STA. 1365+00		ILLINOIS FED. AID PROJECT		
FED. ROAD DIST. NO. (1516, 1, 1, 1, 17 & 1818) R-9		62695		

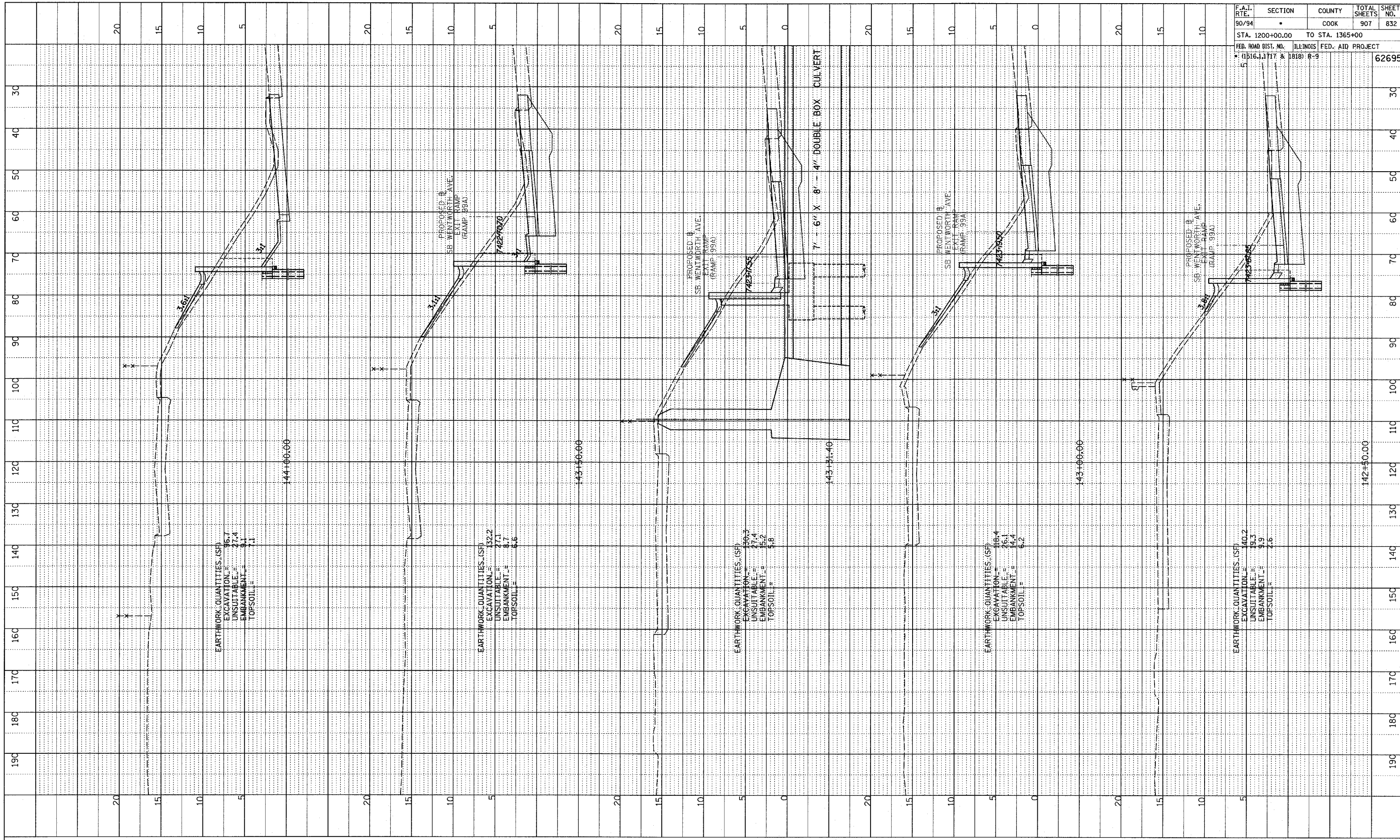

TYLIN INTERNATIONAL

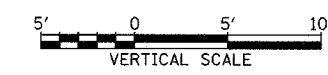
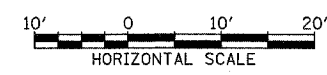

SB WENTWORTH AVENUE EXIT RAMP
 STA. 142+50 TO STA. 144+00

P:\02373\Road\07\Drawn\7\Excess\99A-F.dgn