

SURVEYED  
 GRADES CHECKED  
 ELEV. NOTED  
 STRUCTURE NOTATIONS OK'D  
 NO.

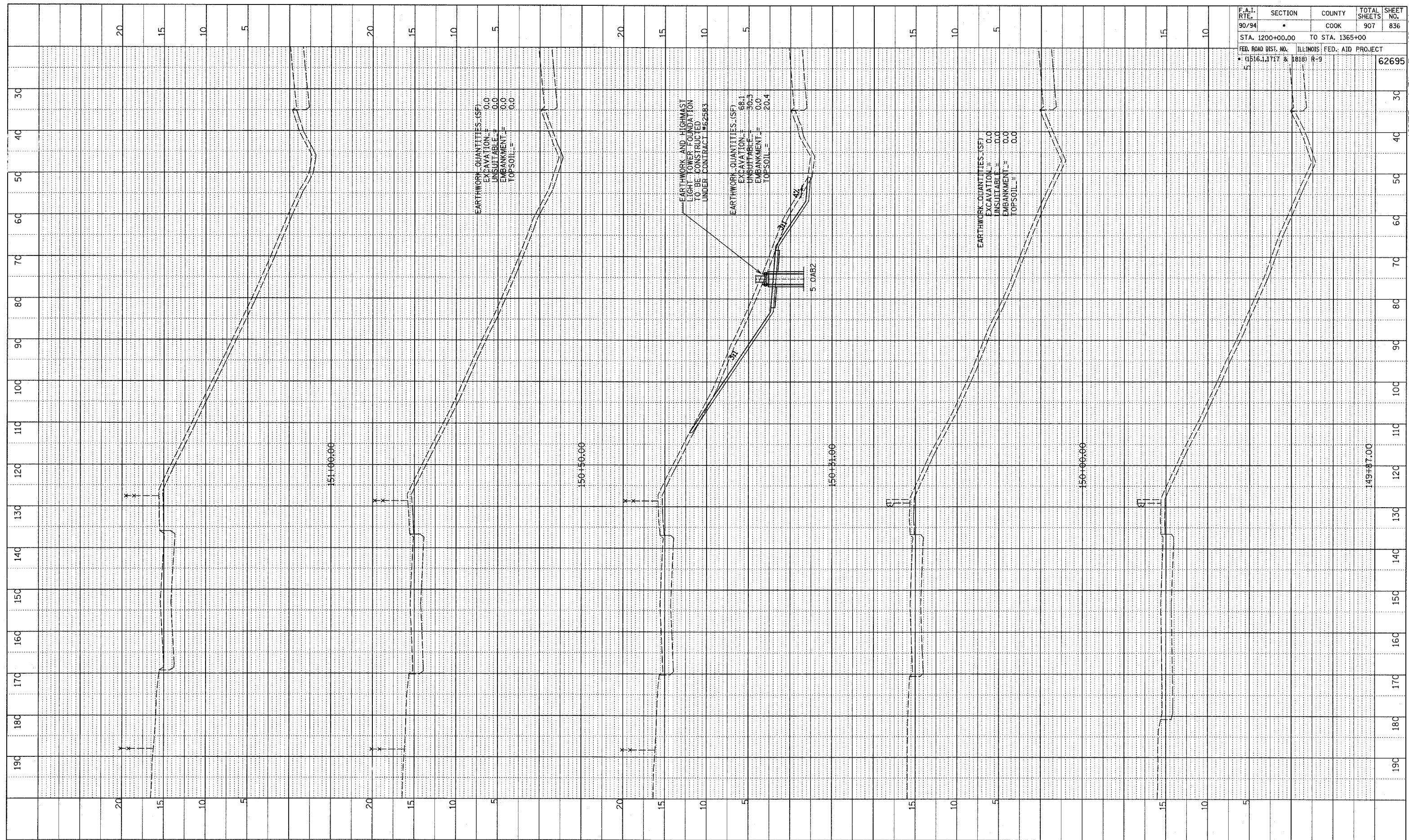

| F.A.I. RTE.                     | SECTION | COUNTY                    | TOTAL SHEETS | SHEET NO. |
|---------------------------------|---------|---------------------------|--------------|-----------|
| 90/94                           | *       | COOK                      | 907          | 836       |
| STA. 1200+00.00 TO STA. 1365+00 |         | ILLINOIS FED. AID PROJECT |              |           |
| * (1516.1, 1717 & 1818) R-9     |         | 62695                     |              |           |

TYLIN INTERNATIONAL

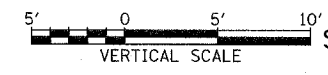
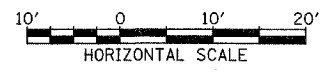

SB WENTWORTH AVENUE EXIT RAMP  
STA. 149+87 TO STA. 151+00

P:\0237\3\road\at\bg\pk\7\basiss99a\_1.dgn