

PROFILE SURVEYED
 PLOTTED
 NOTE BOOK NO. _____
 NO. _____
 STRUCTURE NOTATIONS CHK'D

F.A.I. RTE.	SECTION	COUNTY	TOTAL SHEETS	SHEET NO.
90/94	•	COOK	907	843
STA. 1200+00.00 TO STA. 1365+00		ILLINOIS FED. AID PROJECT		
FEB. ROAD DIST. NO. (1516, 1717 & 1818) R-9		62695		

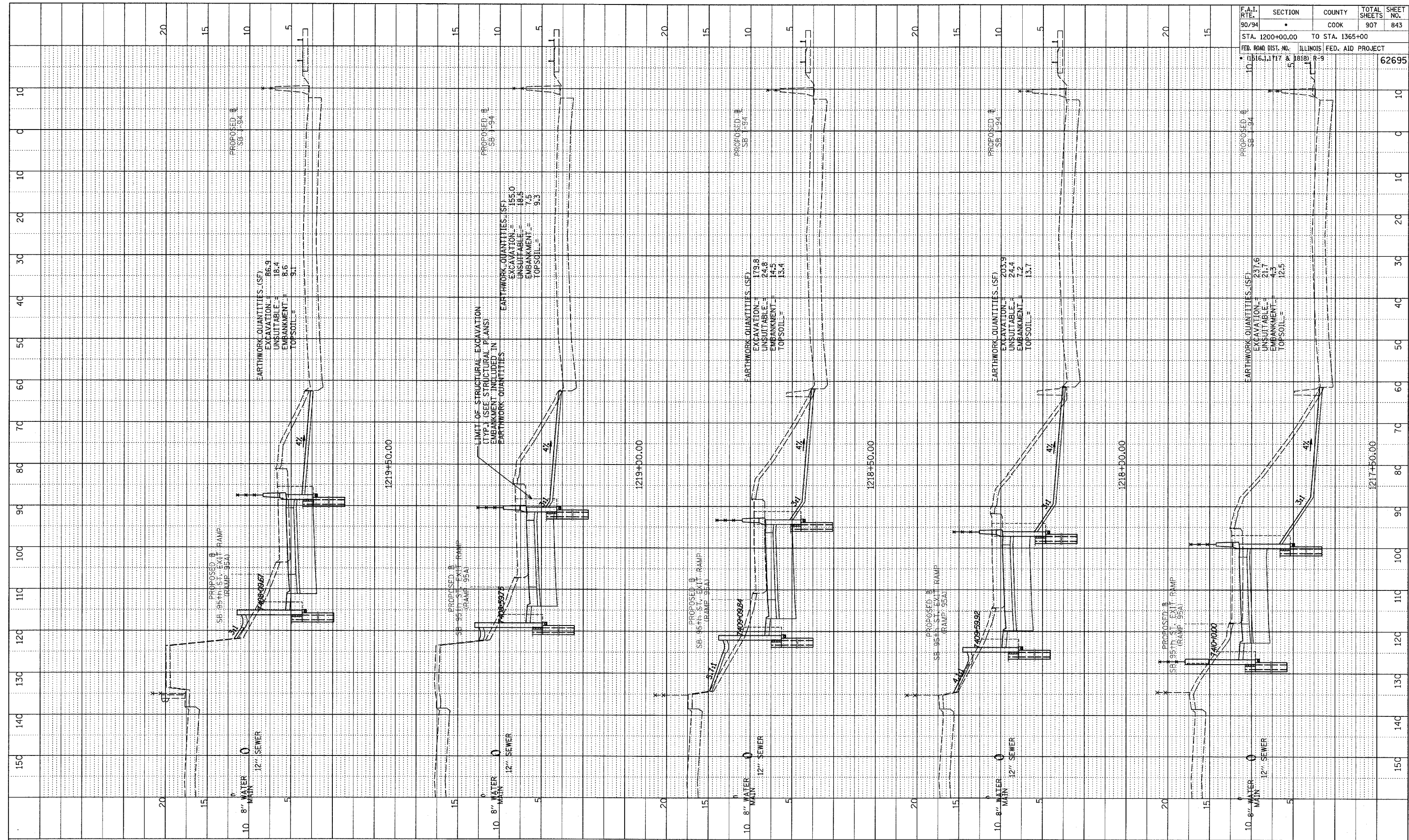

TYLIN INTERNATIONAL

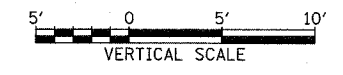
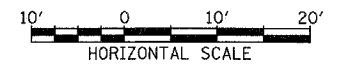

SB 95th ST. EXIT RAMP
 STA. 1217+50 TO STA. 1219+50

P:\0231\road\17\bag\17\bas\95a_1.dgn