

PROFILE SURVEYED  
 PLOTTED & CHECKED  
 NOTE BOOK NO. \_\_\_\_\_  
 DATE \_\_\_\_\_  
 STRUCTURE NOTATION CHFD  
 NO. \_\_\_\_\_

F.A.I. RTE. 90/94	SECTION *	COUNTY COOK	TOTAL SHEETS 907	SHEET NO. 852
STA. 1200+00.00 TO STA. 1365+00		ILLINOIS FED. AID PROJECT		
FED. ROAD DIST. NO. (1516.1, 1717 & 1818) R-9		62695		

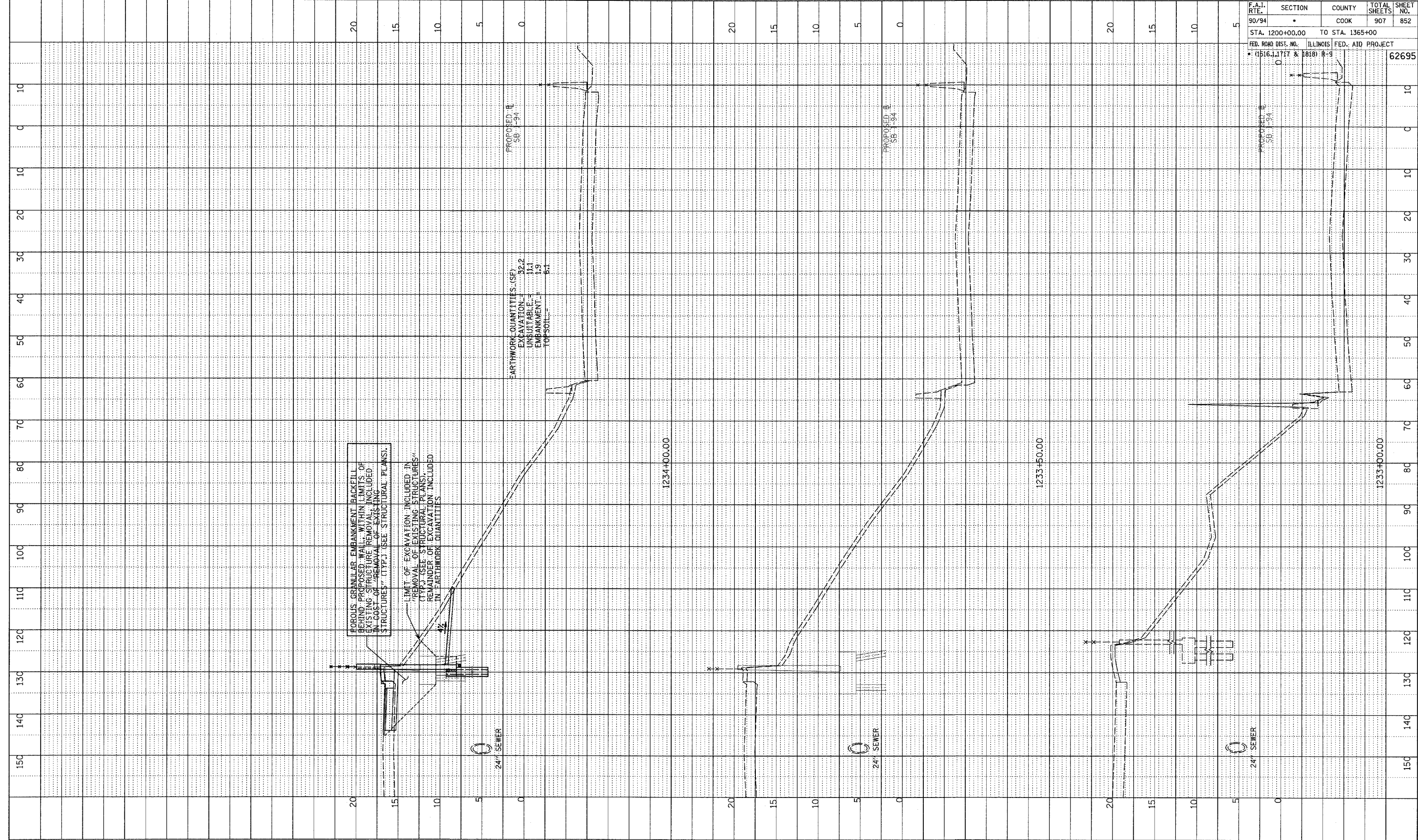

TYLIN INTERNATIONAL

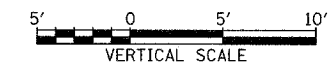
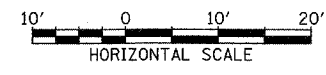

SB 95th ST. EXIT RAMP  
 STA. 1233+00 TO STA. 1234+00

PA02373 road.ctb / bgnk7/buss95a\_f.dgn