

NOTE BOOK
NO. _____
PLOTTED
GRADES CHECKED
STRUCTURE NOTATIONS C/PK0

F.A.I. RTE.	SECTION	COUNTY	TOTAL SHEETS	SHEET NO.
90/94		COOK	907	853
STA. 1200+00.00 TO STA. 1365+00		ILLINOIS FED. AID PROJECT		
• (1516, 1717 & 1818) R-9		62695		

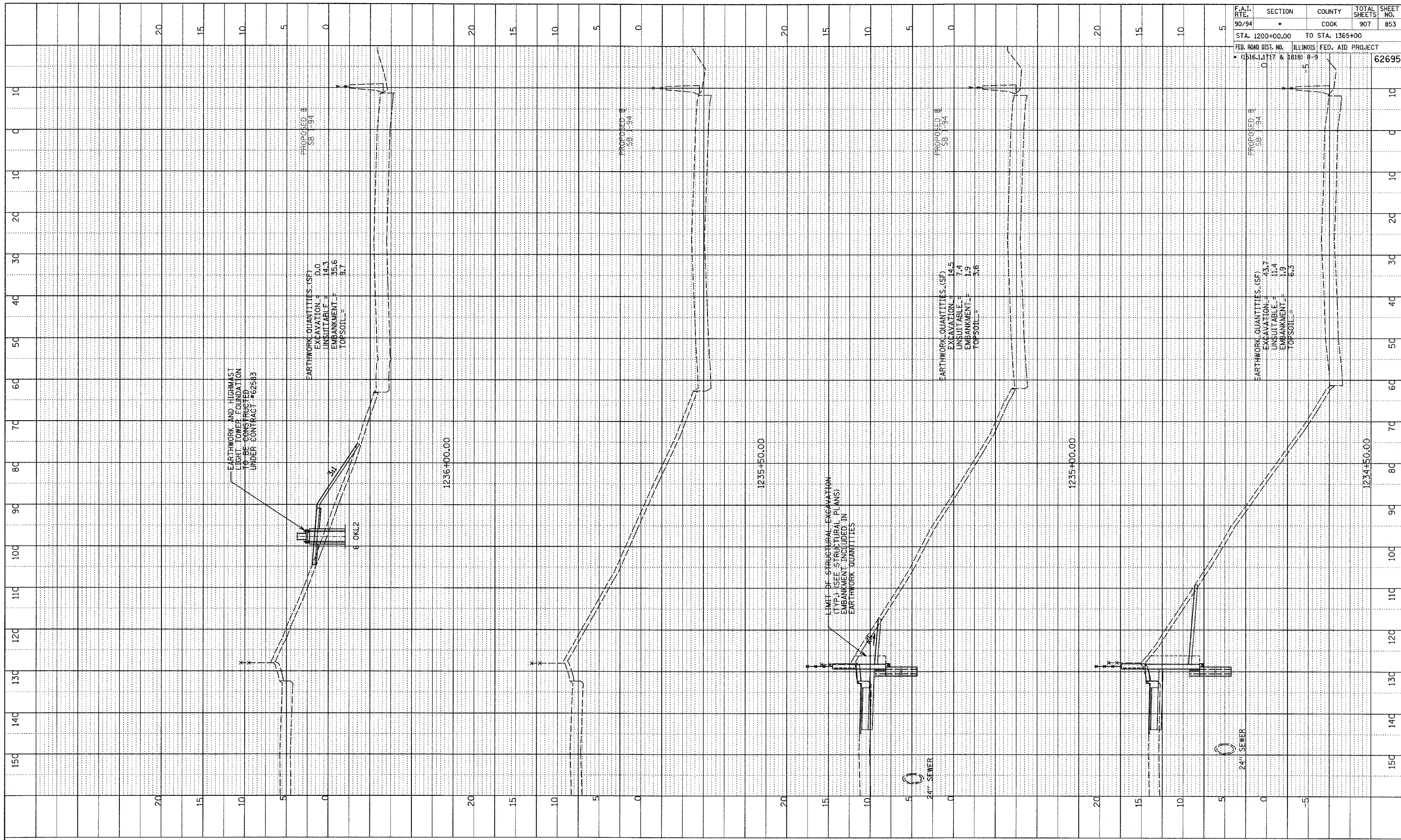

TYLIN INTERNATIONAL

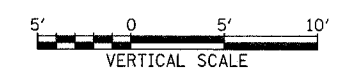
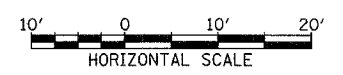

SB 95th ST. EXIT RAMP
STA. 1234+50 TO STA. 1236+00

A:\0231\road\717\717.dwg (1/25/95) 1:40