

PROFILE SHOWN
 GRADES CHECKED
 E.M. NOTED
 NO. DISCREPANCIES NOTATED ON DRAWING

F.A.I. RTE.	SECTION	COUNTY	TOTAL SHEETS	SHEET NO.
90/94	*	COOK	907	860
STA. 1200+00.00 TO STA. 1365+00		ILLINOIS FED. AID PROJECT		
FED. ROAD DIST. NO. (1516.1, 1717 & 1818) R-9		62695		

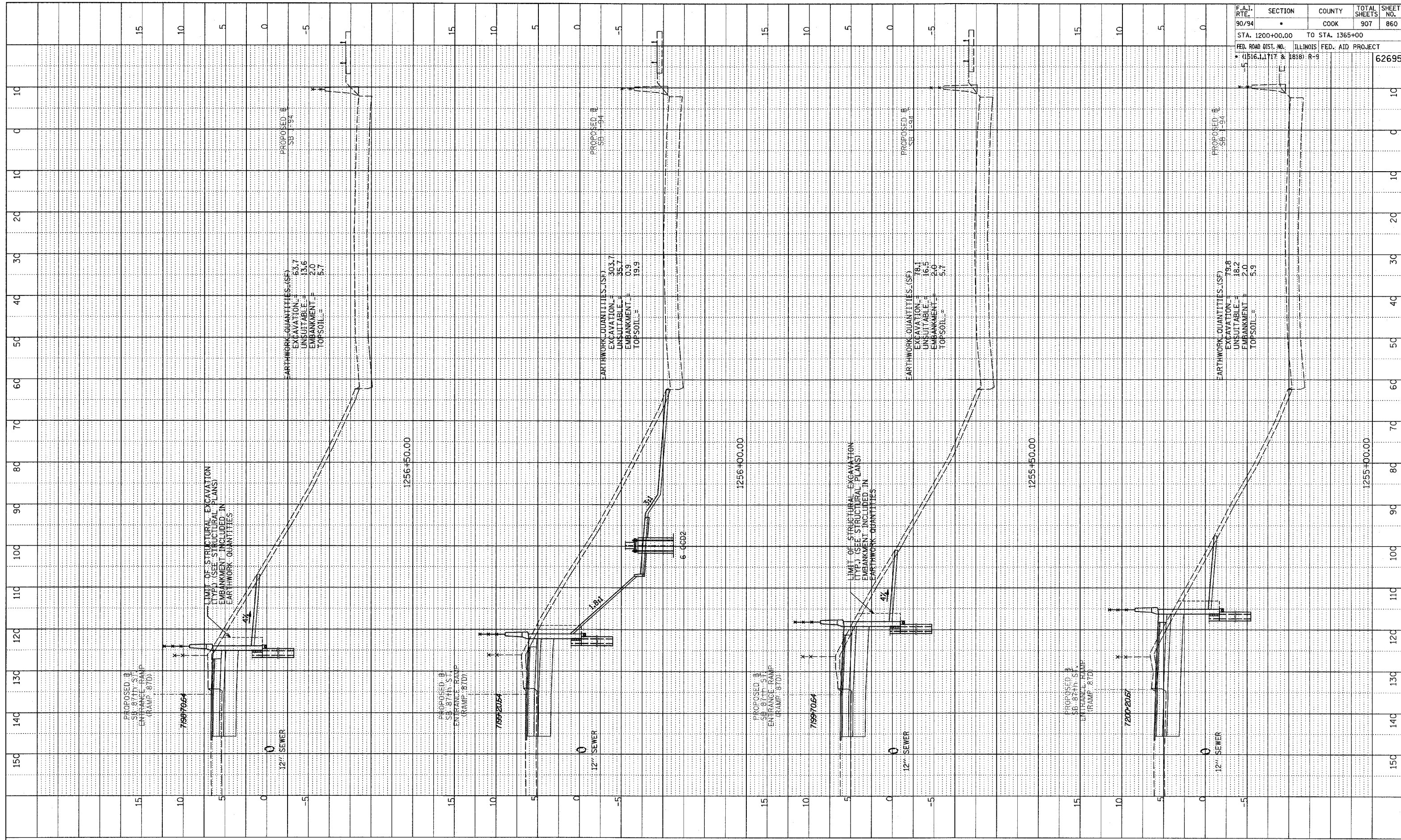

TYLINT INTERNATIONAL

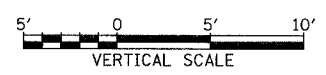
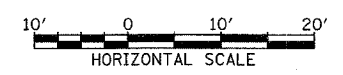

SB 87th ST. ENTRANCE RAMP
 STA. 1255+00 TO STA. 1256+50

P:\02373\road\97\p\97\860\860.dwg