

PROFILE SUBMITTED  
 GRADES CHECKED  
 DATE AND BY  
 NO. 10/11/94 WATKINS EHW

F.A.I. RTE.	SECTION	COUNTY	TOTAL SHEETS	SHEET NO.
90/94	*	COOK	907	861
STA. 1200+00.00		TO STA. 1365+00		
FED. ROAD DIST. NO. ILLINOIS FED. AID PROJECT				62695
* (1516.1, 1117 & 1818) R-9				

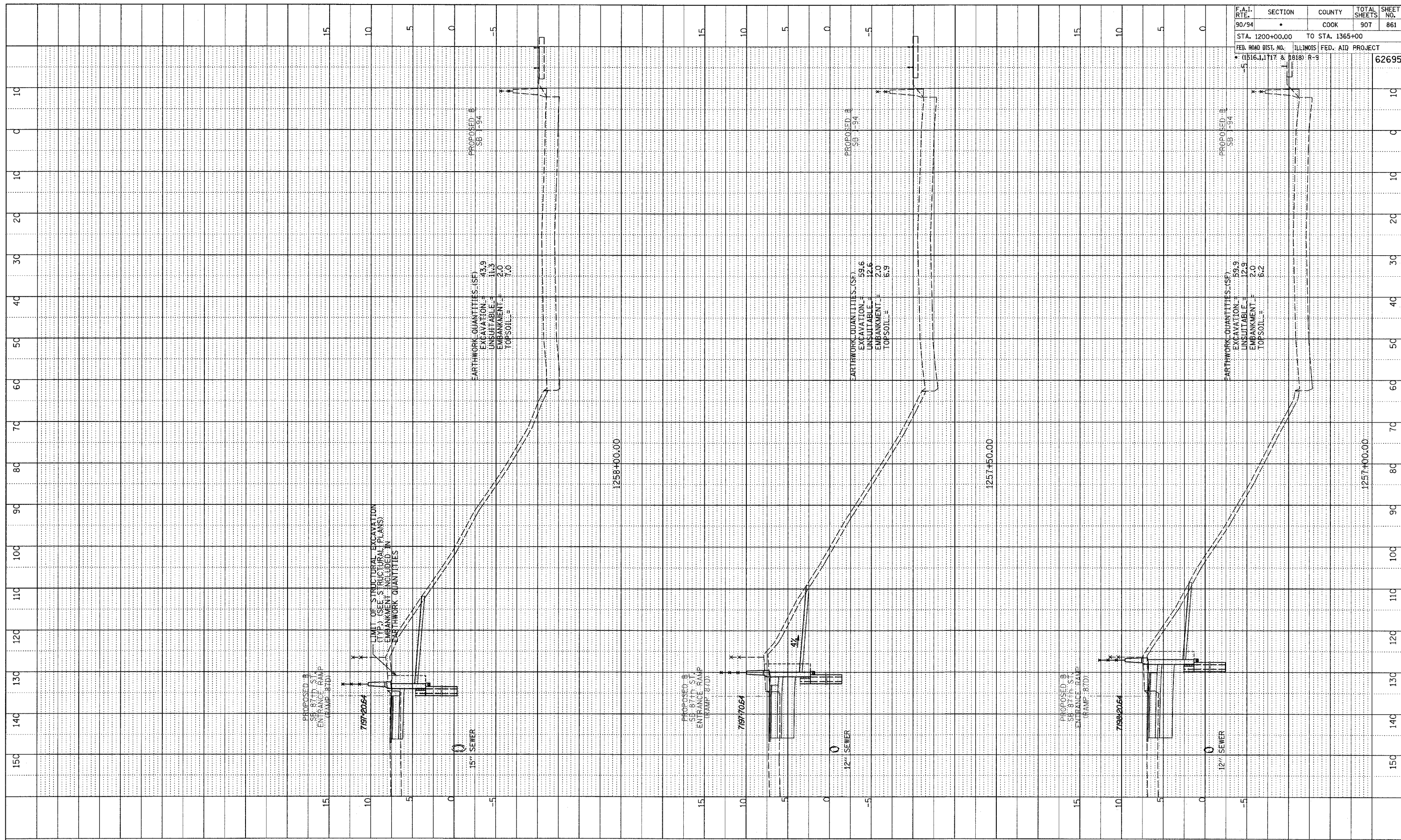

TYLIN INTERNATIONAL

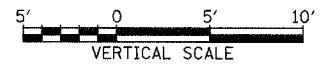

SB 87th ST. ENTRANCE RAMP  
 STA. 1257+00 TO STA. 1258+00