

PROFILE SHOWN  
GRADES CHECKED  
BY: [Signature]  
DATE: [Date]  
NOTE BOOK NO. [Number]  
REVISIONS [Number]

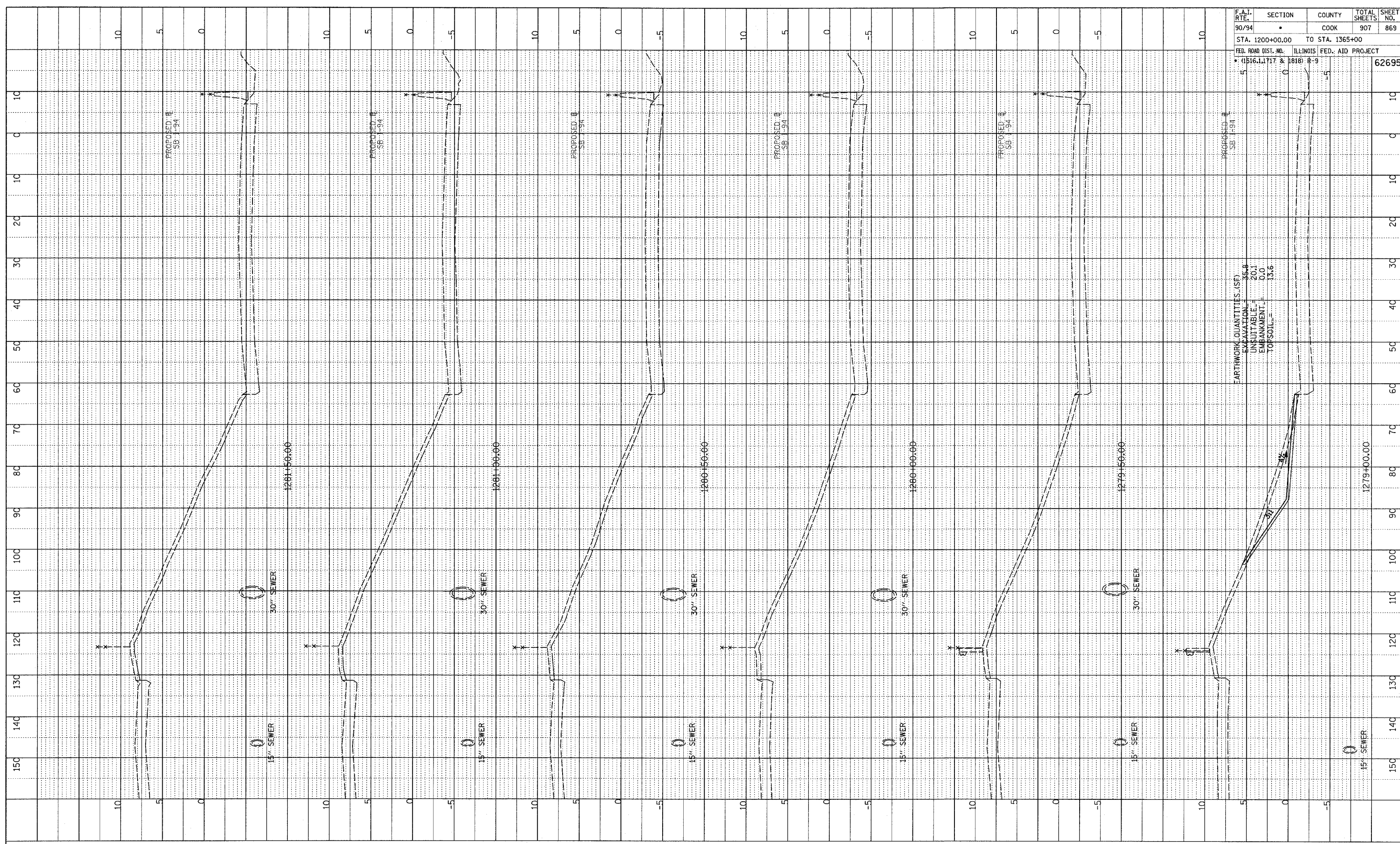

F.A.I. RTE.	SECTION	COUNTY	TOTAL SHEETS	SHEET NO.
90/94		COOK	907	869
STA. 1200+00.00 TO STA. 1365+00				
FED. ROAD DIST. NO. ILLINOIS FED. AID PROJECT				
1516.1, 1717 & 1818 R-9		62695		

TYLIN INTERNATIONAL

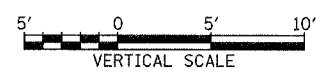
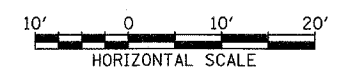

SB 87th ST. EXIT RAMP  
STA. 1279+00 TO STA. 1281+50