

PROFILE SURVEYED
 GRADES CHECKED
 ELEV. NOTED
 NO. STRUCTURE NOTATIONS CHECKED

F.A.I. RTE.	SECTION	COUNTY	TOTAL SHEETS	SHEET NO.
90/94		COOK	907	871
STA. 1200+00.00 TO STA. 1365+00		ILLINOIS FED. AID PROJECT		
FED. ROAD DIST. NO. 1516.1, 1717 & 1818; R-9		62695		

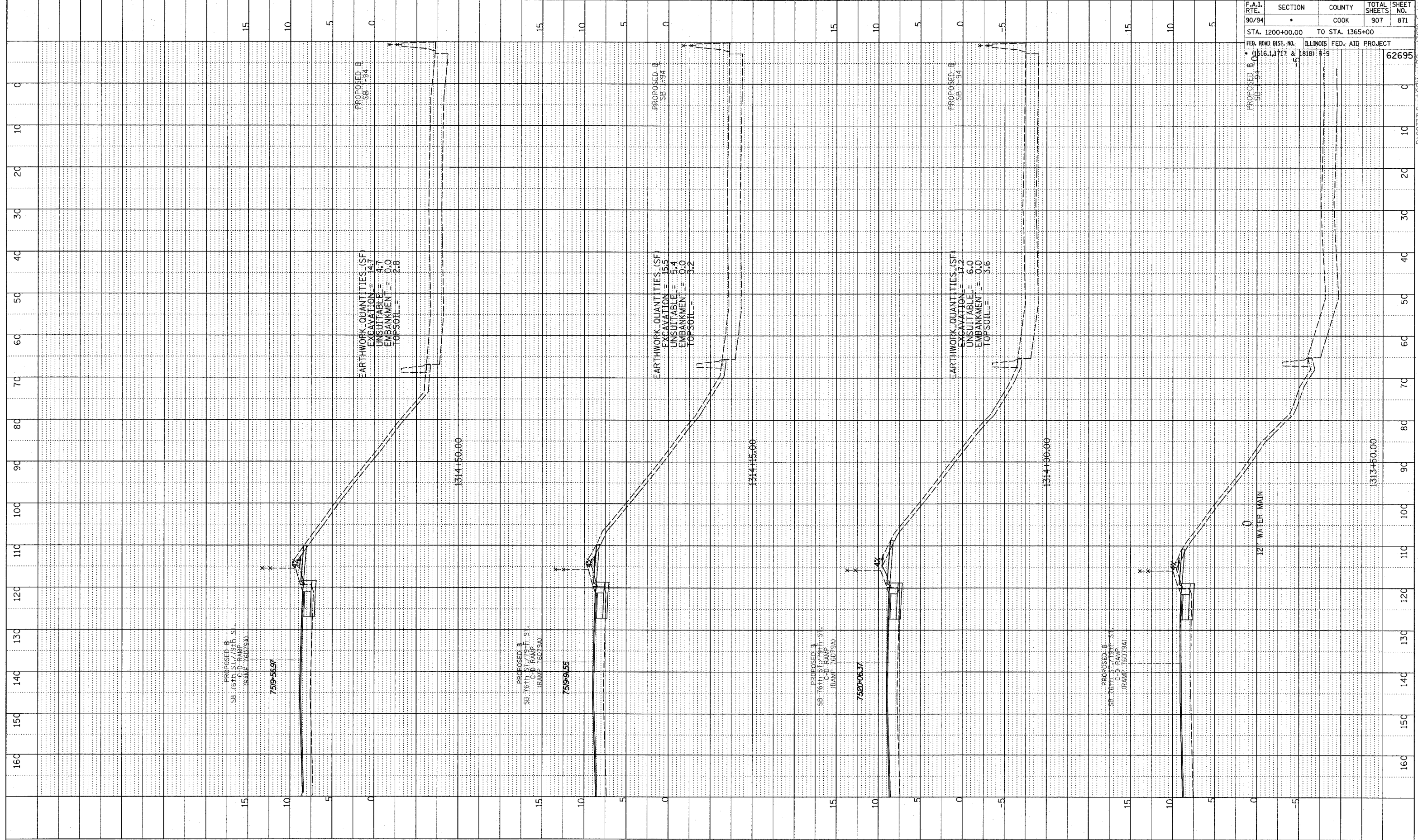

TYLIN INTERNATIONAL

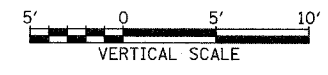
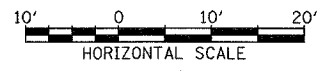

SB 76th to 79th ST. CD RAMP
STA. 1313+50 TO STA. 1314+50

P:\0231\3\Road\CD Ramp\Bresht 6/9/94.dgn