

PROFILE SURVEYED
 GRADES CHECKED
 B.M. NOTED
 STRUCTURE NOTATIONS CIRCLED
 NO.

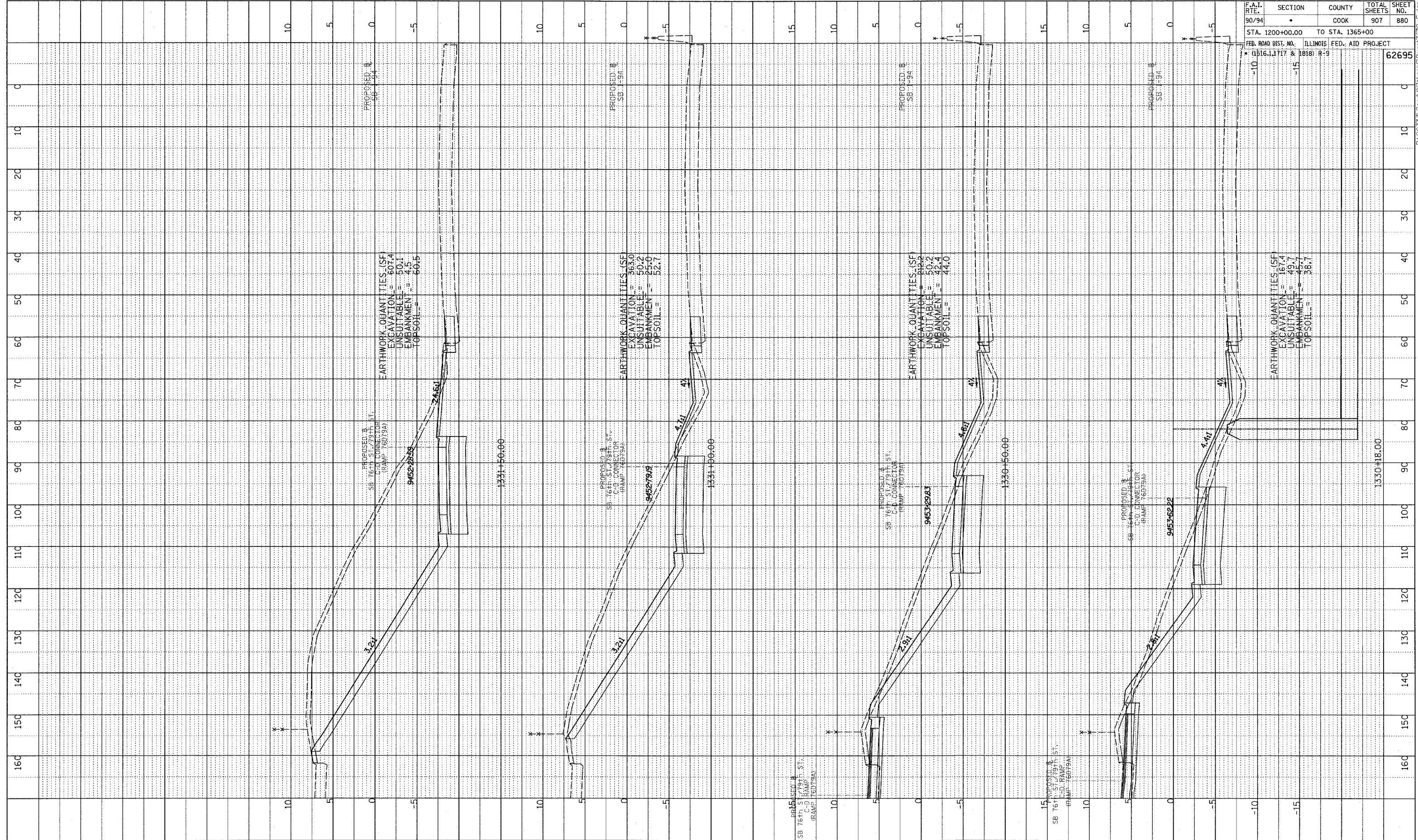

F.A.I. RTE.	SECTION	COUNTY	TOTAL SHEETS	SHEET NO.
90/94		COOK	907	880
STA. 1200+00.00 TO STA. 1365+00				
FED. ROAD DIST. NO. ILLINOIS FED. AID PROJECT				
• (1516.1, 1717 & 1818) R-9		62695		

TYLIN INTERNATIONAL

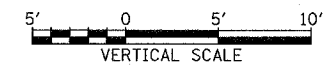
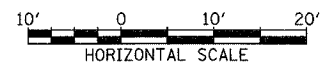

SB 76th TO 79th ST. CD RAMP
STA. 1330+18 TO STA. 1331+50

P:\0231\3\Road\CD Ramp\Bxssht 619.F.dgn