

PROFILL SURVEYED
 GRADES CHECKED
 ELEV. NOTED
 STRUCTURE NOTATIONS OK'D

F.A.I. RTE.	SECTION	COUNTY	TOTAL SHEETS	SHEET NO.
90/94		COOK	907	882
STA. 1200+00.00		TO STA. 1365+00		
FED. ROAD DIST. NO.		ILLINOIS FED. AID PROJECT		62695
1516.1, 1717 & 1818		R-9		

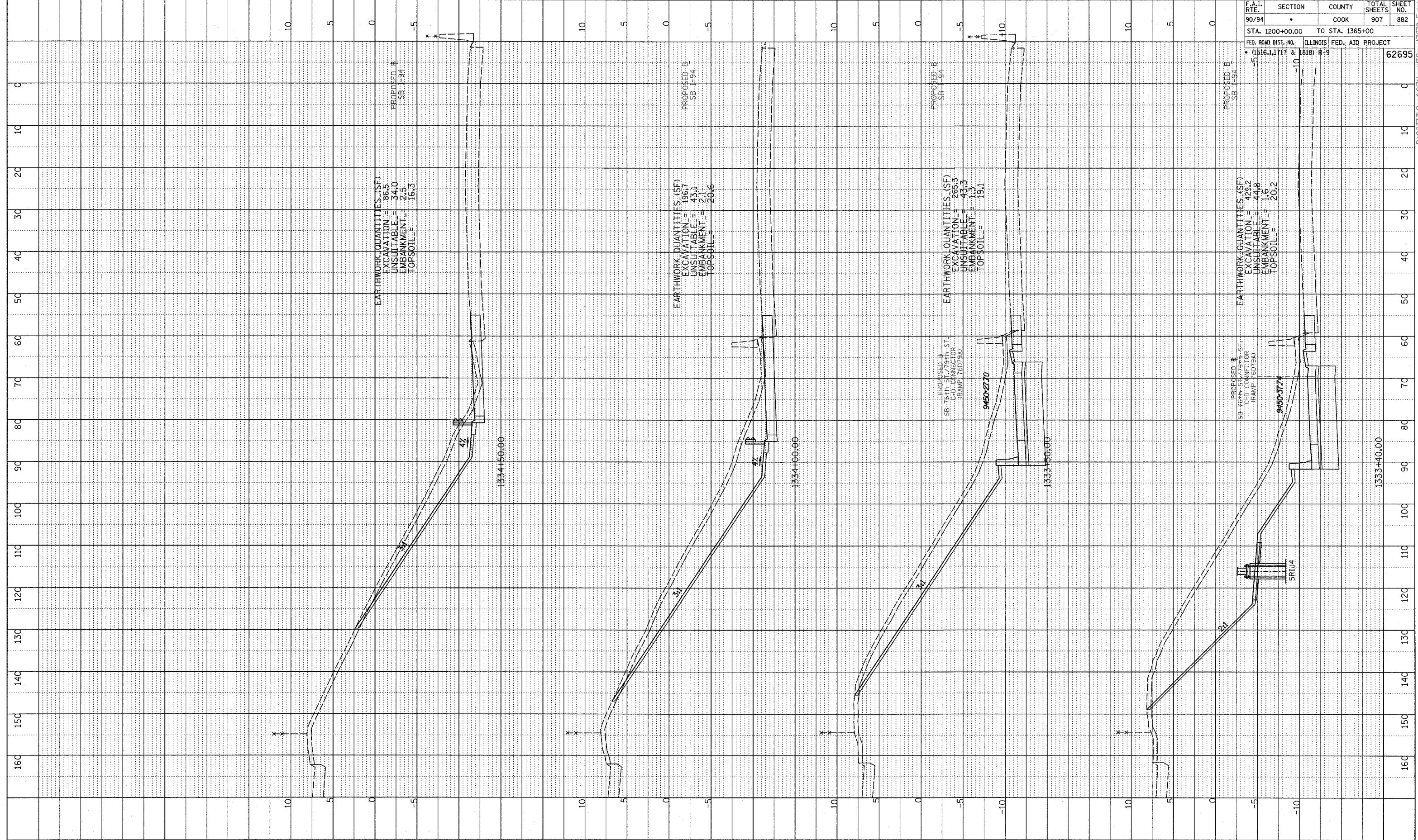

TYLIN INTERNATIONAL

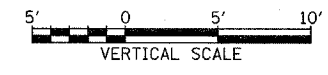
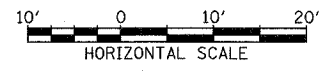

SB 76th TO 79th ST. CD RAMP
 STA. 1333+40 TO STA. 1334+50

P:\0231\3\Road\CD Ramp\Profile\9-F.dgn