

THE FOLLOWING ITEMS SHALL BE REMOVED BY THE CONTRACTOR AND SHALL BE DISPOSED OF BY THEM OUTSIDE THE RIGHT-OF-WAY AT THEIR EXPENSE. THE SALVAGE VALUE OF THE REMOVED EQUIPMENT SHALL BE REFLECTED IN THE CONTRACT BID PRICE.

- 1 EACH SIGNAL HEAD, 1-FACE, 3-SECTION
- 7 EACH SIGNAL HEAD, 1-FACE, 5-SECTION
- 1 EACH SIGNAL HEAD, 2-FACE, 1-3 SECTION, 1-5 SECTION
- 3 EACH SIGNAL HEAD, 2-FACE, 5-SECTION
- 6 EACH PEDESTRIAN SIGNAL HEAD, 1-FACE
- 1 EACH PEDESTRIAN SIGNAL HEAD, 2-FACE
- 7 EACH PEDESTRIAN PUSH-BUTTON
- 1 EACH SERVICE INSTALLATION, POLE MOUNTED

THE FOLLOWING EXISTING TRAFFIC SIGNAL EQUIPMENT SHALL BE REMOVED BY THE CONTRACTOR, SHALL REMAIN THE PROPERTY OF THE STATE AND SHALL BE DELIVERED BY THE CONTRACTOR TO THE STATE'S TRAFFIC SIGNAL MAINTENANCE CONTRACTOR'S MAIN FACILITY AS PER THE TRAFFIC SIGNAL SPECIFICATIONS.

- 1 EACH CONTROLLER AND CABINET, COMPLETE

CONSTRUCTION NOTES:

- 1 REMOVE EXISTING CONTROLLER AND CABINET. INSTALL NEW CONTROLLER AND TYPE IV CABINET, SPECIAL, RE-USE EXISTING FOUNDATION. RELOCATE EXISTING EMERGENCY VEHICLE PRIORITY SYSTEM, PHASING UNIT TO NEW CONTROLLER CABINET. RELOCATION OF THE EXISTING EMERGENCY PRIORITY SYSTEM SHALL BE INCLUDED IN THE CONTROLLER UNIT PRICE.
- 2 REMOVE EXISTING SIGNAL HEAD, 1-FACE, 3-SECTION. INSTALL NEW SIGNAL HEAD, L.E.D. 1-FACE, 3-SECTION, MAST ARM MOUNTED, AND TRAFFIC SIGNAL BACKPLATE.
- 3 REMOVE EXISTING SIGNAL HEAD, 1-FACE, 5-SECTION. INSTALL NEW SIGNAL HEAD, L.E.D. 1-FACE, 5-SECTION, MAST ARM MOUNTED, AND TRAFFIC SIGNAL BACKPLATE.
- 4 REMOVE EXISTING SIGNAL HEAD, 2-FACE, 1-3 SECTION, 1-5 SECTION, BRACKET MOUNTED. INSTALL NEW SIGNAL HEAD, L.E.D., 2-FACE, 1-3 SECTION, 1-5 SECTION BRACKET MOUNTED.
- 5 REMOVE EXISTING SIGNAL HEAD, 2-FACE, 5-SECTION. INSTALL NEW SIGNAL HEAD, L.E.D., 2-FACE, 5-SECTION, BRACKET MOUNTED.
- 6 REMOVE EXISTING PEDESTRIAN SIGNAL HEAD, 1-FACE. INSTALL NEW PEDESTRIAN SIGNAL HEAD, L.E.D., 1-FACE, BRACKET MOUNTED.
- 7 REMOVE EXISTING PEDESTRIAN SIGNAL HEAD, 2-FACE. INSTALL NEW PEDESTRIAN SIGNAL HEAD, L.E.D., 2-FACE, BRACKET MOUNTED.
- 8 REMOVE EXISTING PEDESTRIAN PUSH-BUTTON. INSTALL NEW PEDESTRIAN PUSH-BUTTON.

F.A.U. RTE.	SECTION	COUNTY	TOTAL SHEETS	SHEET NO.
1602	2004-021TS	COOK	25	7

STA. TO STA.  
FED. ROAD DIST. NO. ILLINOIS FED. AID PROJECT

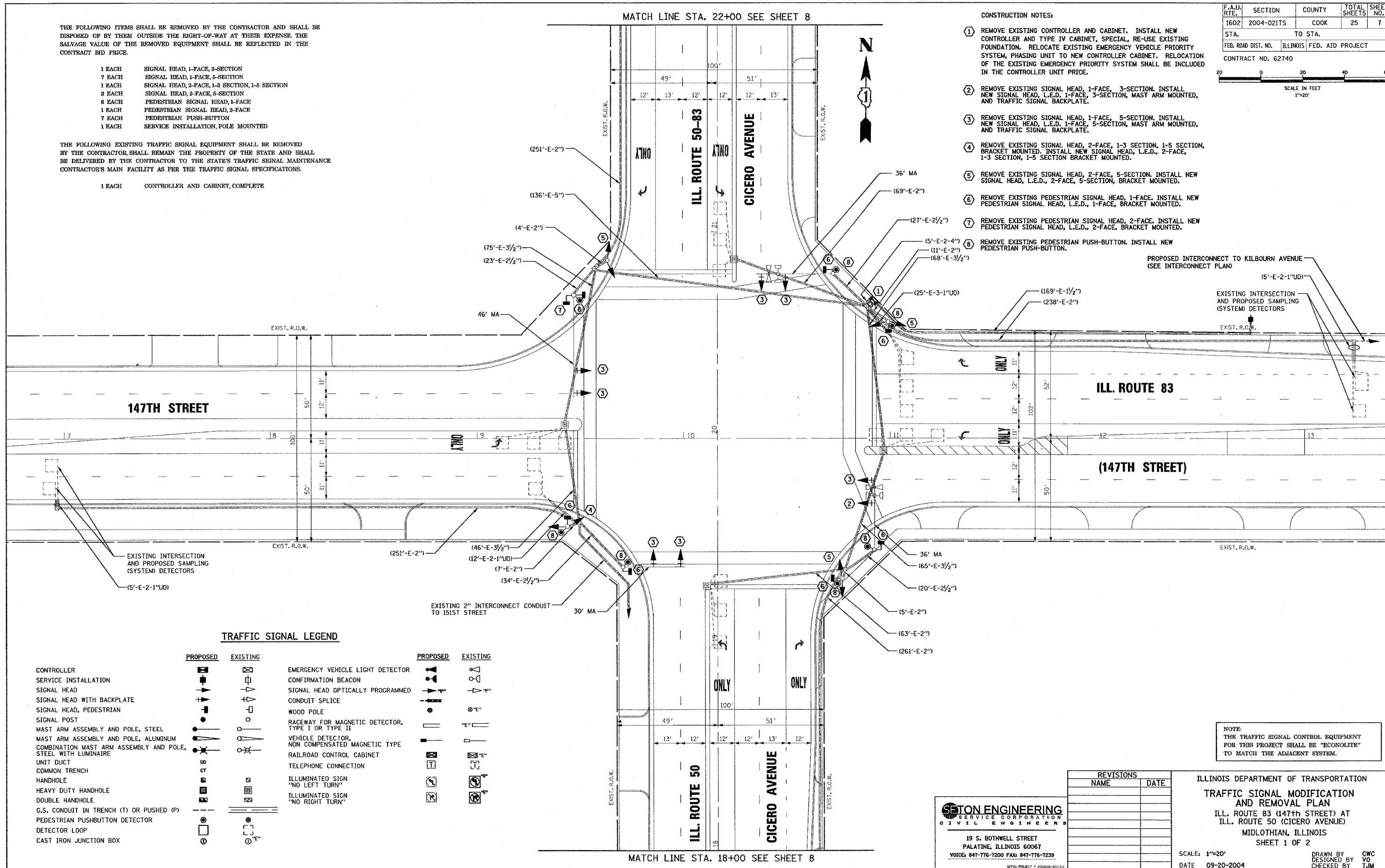
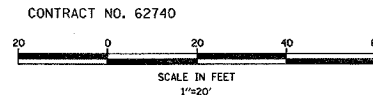

TRAFFIC SIGNAL LEGEND

PROPOSED	EXISTING	PROPOSED	EXISTING
CONTROLLER	[Symbol]	EMERGENCY VEHICLE LIGHT DETECTOR	[Symbol]
SERVICE INSTALLATION	[Symbol]	CONFIRMATION BEACON	[Symbol]
SIGNAL HEAD	[Symbol]	SIGNAL HEAD OPTICALLY PROGRAMMED	[Symbol]
SIGNAL HEAD WITH BACKPLATE	[Symbol]	CONDUIT SPLICE	[Symbol]
SIGNAL HEAD, PEDESTRIAN	[Symbol]	WOOD POLE	[Symbol]
SIGNAL POST	[Symbol]	RACEWAY FOR MAGNETIC DETECTOR, TYPE I OR TYPE II	[Symbol]
MAST ARM ASSEMBLY AND POLE, STEEL	[Symbol]	VEHICLE DETECTOR, NON COMPENSATED MAGNETIC TYPE	[Symbol]
MAST ARM ASSEMBLY AND POLE, ALUMINUM	[Symbol]	RAILROAD CONTROL CABINET	[Symbol]
COMBINATION MAST ARM ASSEMBLY AND POLE, STEEL WITH LUMINAIRE	[Symbol]	TELEPHONE CONNECTION	[Symbol]
UNIT DUCT	[Symbol]	ILLUMINATED SIGN "NO LEFT TURN"	[Symbol]
COMMON TRENCH	[Symbol]	ILLUMINATED SIGN "NO RIGHT TURN"	[Symbol]
HANDHOLE	[Symbol]		
HEAVY DUTY HANDHOLE	[Symbol]		
DOUBLE HANDHOLE	[Symbol]		
G.S. CONDUIT IN TRENCH (T) OR PUSHED (P)	[Symbol]		
PEDESTRIAN PUSHBUTTON DETECTOR	[Symbol]		
DETECTOR LOOP	[Symbol]		
CAST IRON JUNCTION BOX	[Symbol]		

NOTE: THE TRAFFIC SIGNAL CONTROL EQUIPMENT FOR THIS PROJECT SHALL BE "ECONOLITE" TO MATCH THE ADJACENT SYSTEM.

REVISIONS	
NAME	DATE

**SETON ENGINEERING**  
SERVICE CORPORATION  
CIVIL ENGINEERS  
19 S. BOWWELL STREET  
PALATINE, ILLINOIS 60067  
VOICE: 847-776-7200 FAX: 847-776-7239  
SETON PROJECT # 200209-201-211

ILLINOIS DEPARTMENT OF TRANSPORTATION  
**TRAFFIC SIGNAL MODIFICATION AND REMOVAL PLAN**  
ILL. ROUTE 83 (147th STREET) AT ILL. ROUTE 50 (CICERO AVENUE)  
MIDLOTHIAN, ILLINOIS  
SHEET 1 OF 2  
SCALE: 1"=20'  
DATE: 09-20-2004  
DRAWN BY: CWC  
DESIGNED BY: VO  
CHECKED BY: TJM