

F.A.I. RTE.	SECTION	COUNTY	TOTAL SHEETS	SHEET NO.
90		COOK	82	15
STA. 3375+00		TO STA. 3390+00		
FED. ROAD DIST. NO.		ILLINOIS	FED. AID PROJECT	
• (1012, 1214, 1415, & 1517) RS-3				

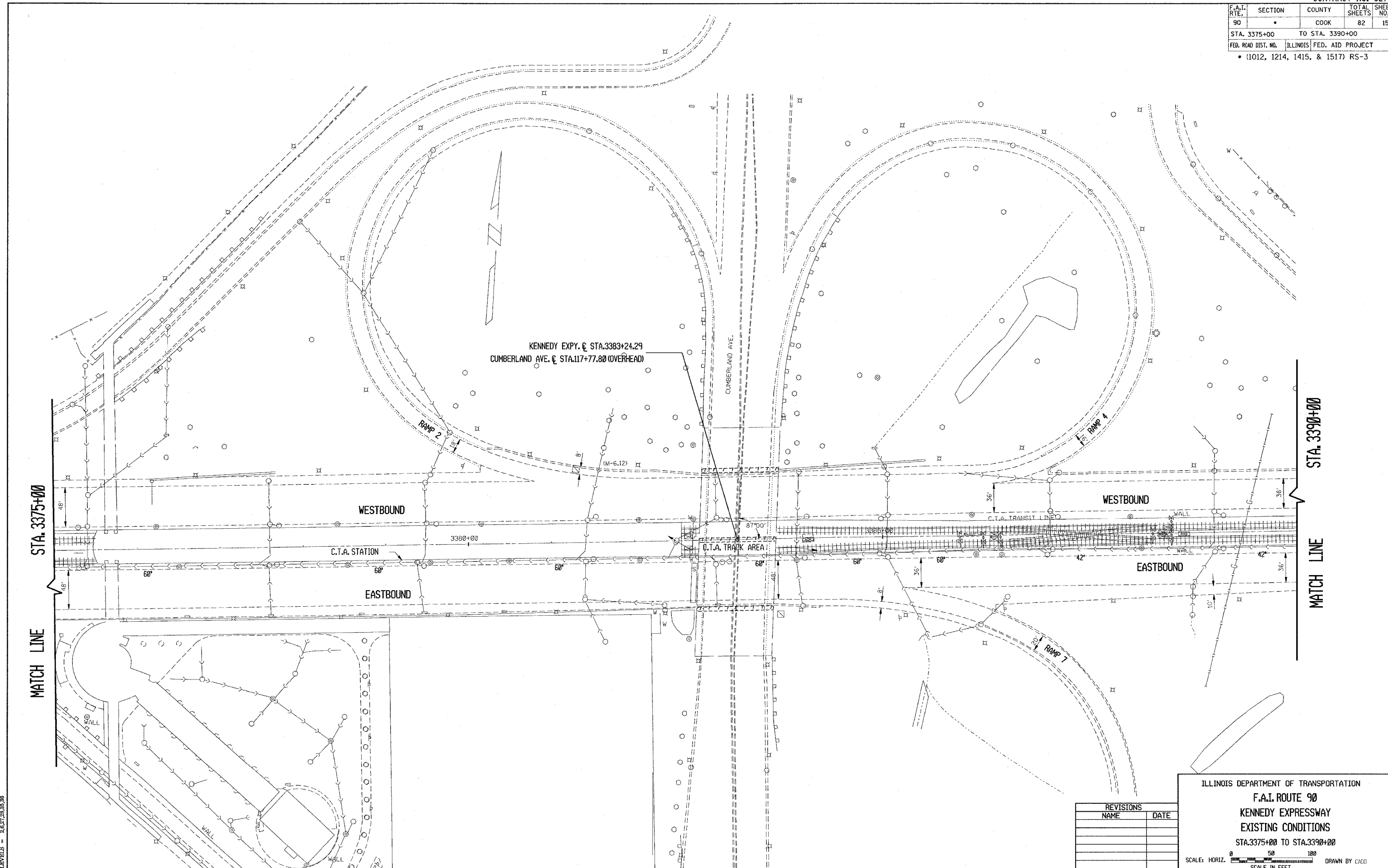

STA. 3375+00

STA. 3390+00

MATCH LINE

MATCH LINE

KENNEDY EXPY. C. STA. 3383+24.29
CUMBERLAND AVE. C. STA. 117+77.80 (OVERHEAD)

WESTBOUND
C.T.A. STATION
EASTBOUND

WESTBOUND
C.T.A. TRANSIT LINES
EASTBOUND

REVISIONS	
NAME	DATE

ILLINOIS DEPARTMENT OF TRANSPORTATION
F.A.I. ROUTE 90
 KENNEDY EXPRESSWAY
 EXISTING CONDITIONS
 STA. 3375+00 TO STA. 3390+00

SCALE: HORIZ. SCALE IN FEET
 DATE 9/10/86 DRAWN BY CADD CHECKED BY

5/2/2005
 ZPS/C1317651/785600.DWG
 LEVELS = 2, 5, 7, 8, 9, 8