

F.A.I. RTE.	SECTION	COUNTY	TOTAL SHEETS	SHEET NO.
90/94	2004-0561	COOK	47	33
STA. 586+50		TO STA. 591+25		
FED. ROAD DIST. NO. 1 ILLINOIS FED. AID PROJECT				

62795

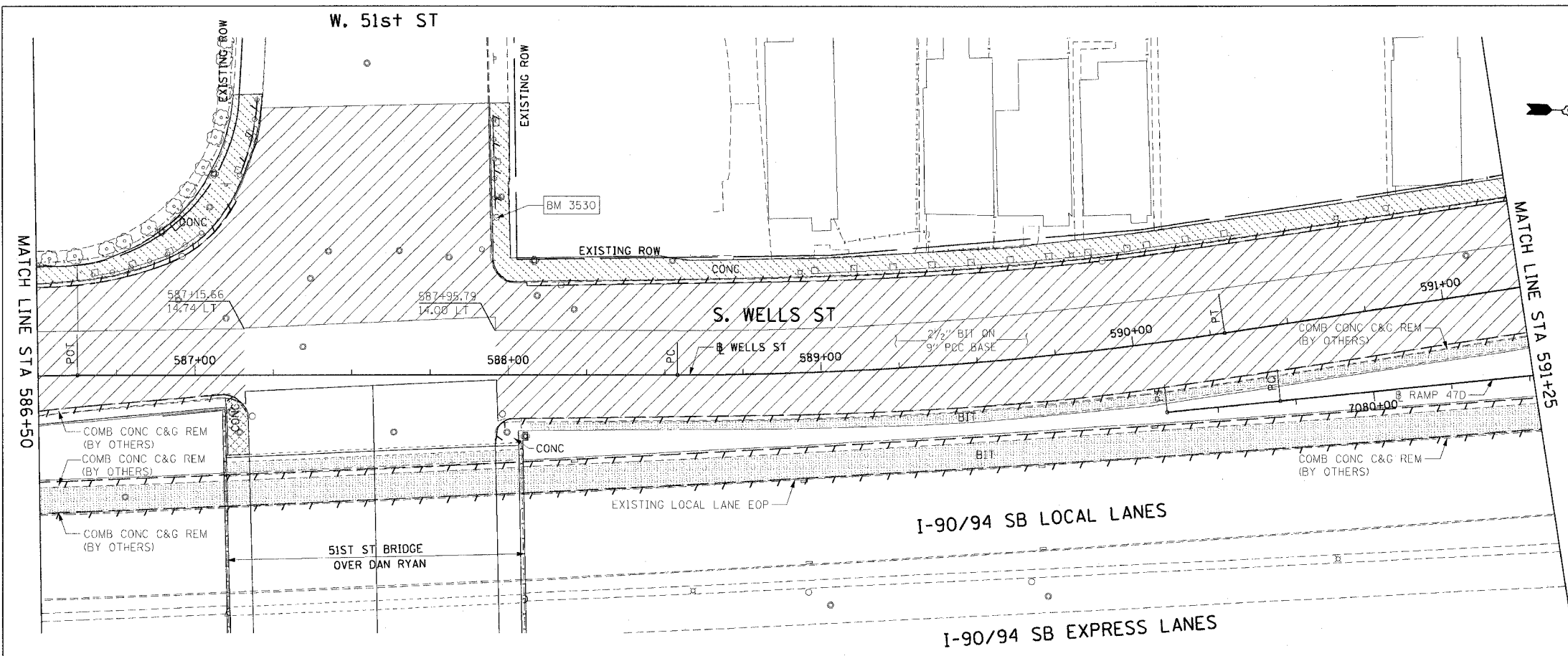

- LEGEND:**
- PAVEMENT REMOVAL (BY OTHERS)
 - MEDIAN REMOVAL (BY OTHERS)
 - LINEAR REMOVALS (BY OTHERS)
 - SIDEWALK REMOVAL (BY OTHERS)
 - APPROACH SLAB REMOVAL (BY OTHERS)
 - DRIVEWAY PAVEMENT REMOVAL (BY OTHERS)
 - PAVED SHOULDER REMOVAL (BY OTHERS)
 - TREE REMOVAL (WITH SIZE) (BY OTHERS)

**EXISTING CONDITIONS AND REMOVAL
PROPOSED IMPROVEMENTS**

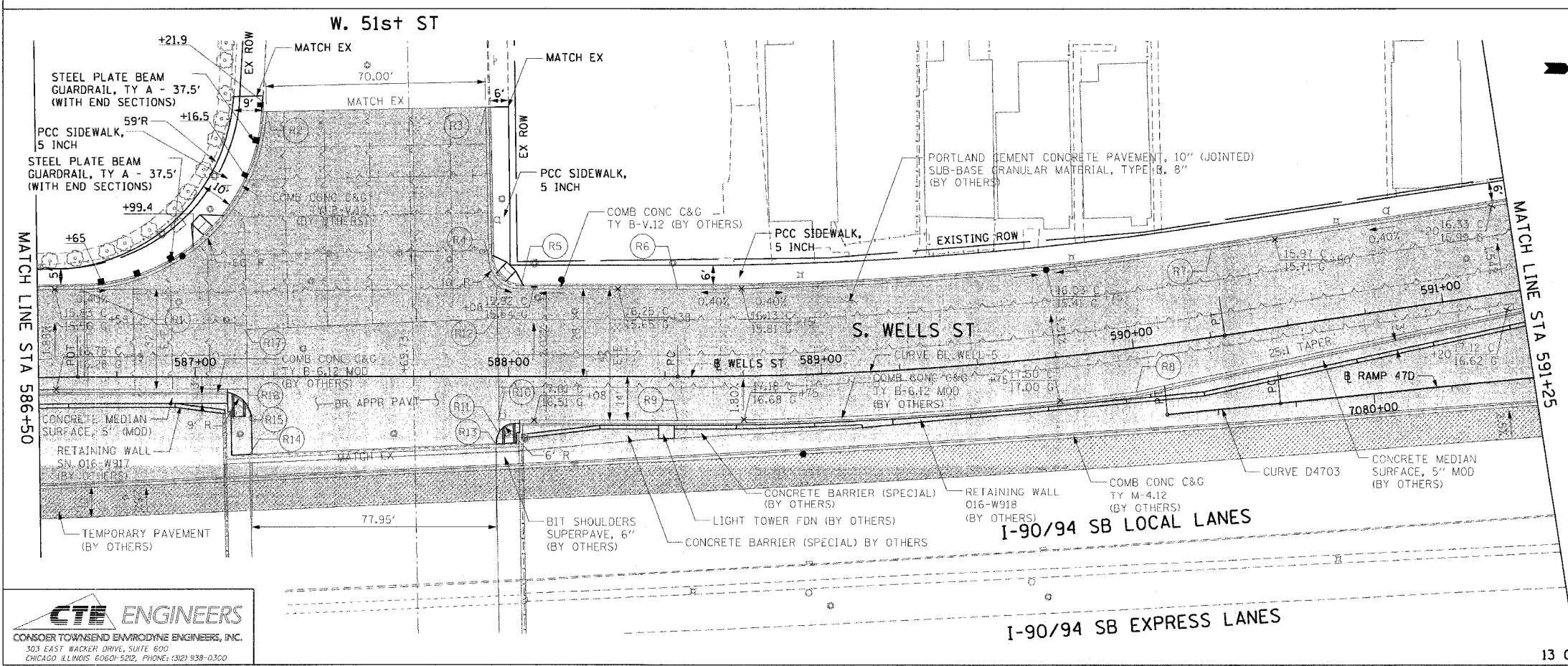

- LEGEND:**
- WORK TO BE DONE BY OTHERS

- NOTES:**
1. SEE SIDEWALK RAMP DETAIL ON SHEET 40.
 2. SEE SIDEWALK DETAIL ON SHEET 41.
 3. SEE GUARDRAIL DETAIL ON SHEET 39.

PT.	STATION	OFFSET	PT.	STATION	OFFSET
R1	586+62.89	28.00' LT	R10	587+96.60	14.00' RT
R2	587+22.80	84.72' LT	R11	587+96.71	17.90' RT
R3	587+92.78	86.12' LT	R12	587+95.68	18.37' LT
R4	587+93.75	37.80' LT	R13	587+95.86	21.66' RT
R5	588+03.75	28.00' LT	R14	587+17.36	24.97' RT
R6	588+54.10	28.00' LT	R15	587+16.17	9.39' RT
R7	590+29.55	28.00' LT	R16	587+16.03	4.00' RT
R8	589+99.14	14.00' RT	R17	587+15.69	15.00' LT
R9	588+54.10	14.00' RT			

REVISIONS	
NAME	DATE

ILLINOIS DEPARTMENT OF TRANSPORTATION
F.A.I. 90/94 (DAN RYAN EXPRESSWAY)
59th ST TO 47th ST (WELLS ST SIDEWALKS)
**EXISTING AND PROPOSED ROADWAY PLANS
WELLS STREET**

SCALE: 1"=20'
DATE: MARCH 4, 2005

DRAWN BY: LC
CHECKED BY: JAL

CTE ENGINEERS
CONSOER TOWNSEND ENVIRONMENTAL ENGINEERS, INC.
303 EAST WACKER DRIVE, SUITE 600
CHICAGO, ILLINOIS 60601-5202, PHONE: (312) 938-0300

02/24/2005 05:21:35 PM