

F.A.I. RTE.	SECTION	COUNTY	TOTAL SHEETS	SHEET NO.
90/94	2004-0571	COOK	47	24
STA. 143+00		TO STA. 148+00		
FED. ROAD DIST. NO. 1 ILLINOIS FED. AID PROJECT				

62796

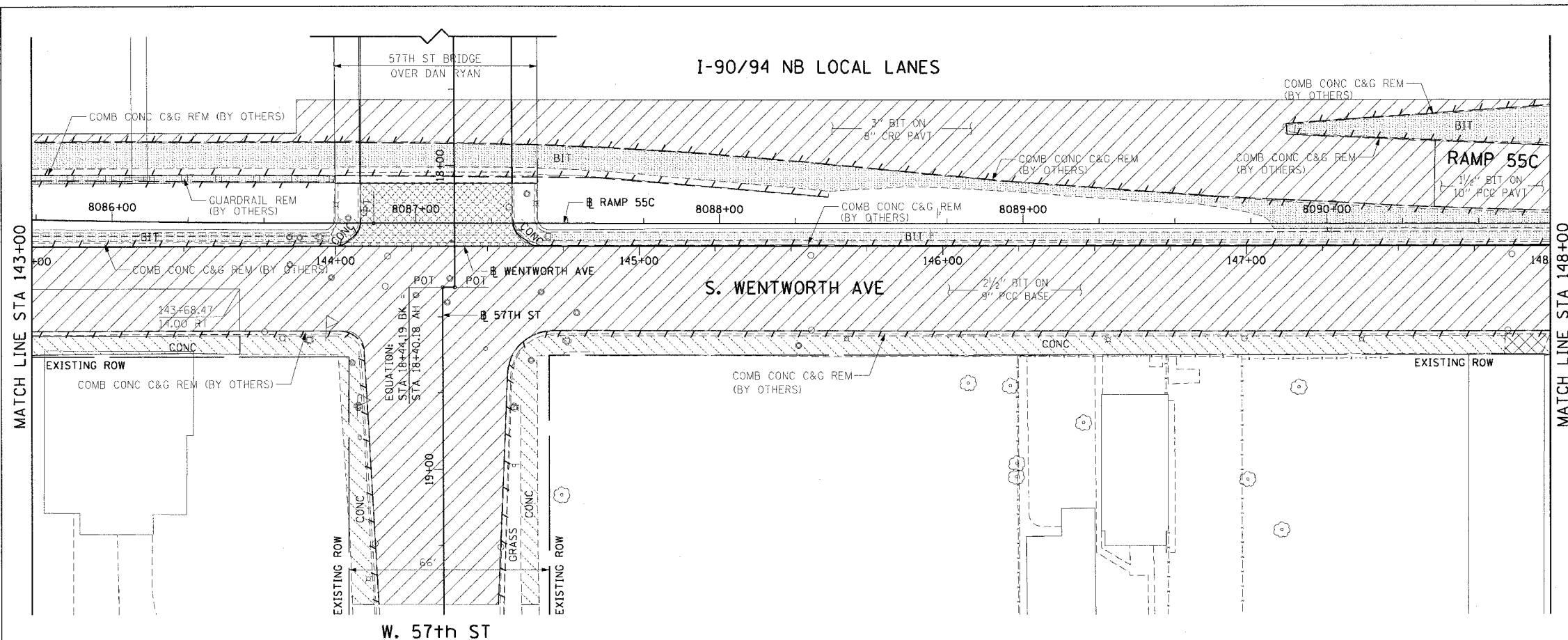

- LEGEND:
- PAVEMENT REMOVAL (BY OTHERS)
 - MEDIAN REMOVAL (BY OTHERS)
 - LINEAR REMOVALS (BY OTHERS)
 - SIDEWALK REMOVAL (BY OTHERS)
 - APPROACH SLAB REMOVAL (BY OTHERS)
 - DRIVEWAY PAVEMENT REMOVAL (BY OTHERS)
 - PAVED SHOULDER REMOVAL (BY OTHERS)
 - TREE REMOVAL (WITH SIZE) (BY OTHERS)

EXISTING CONDITIONS AND REMOVAL

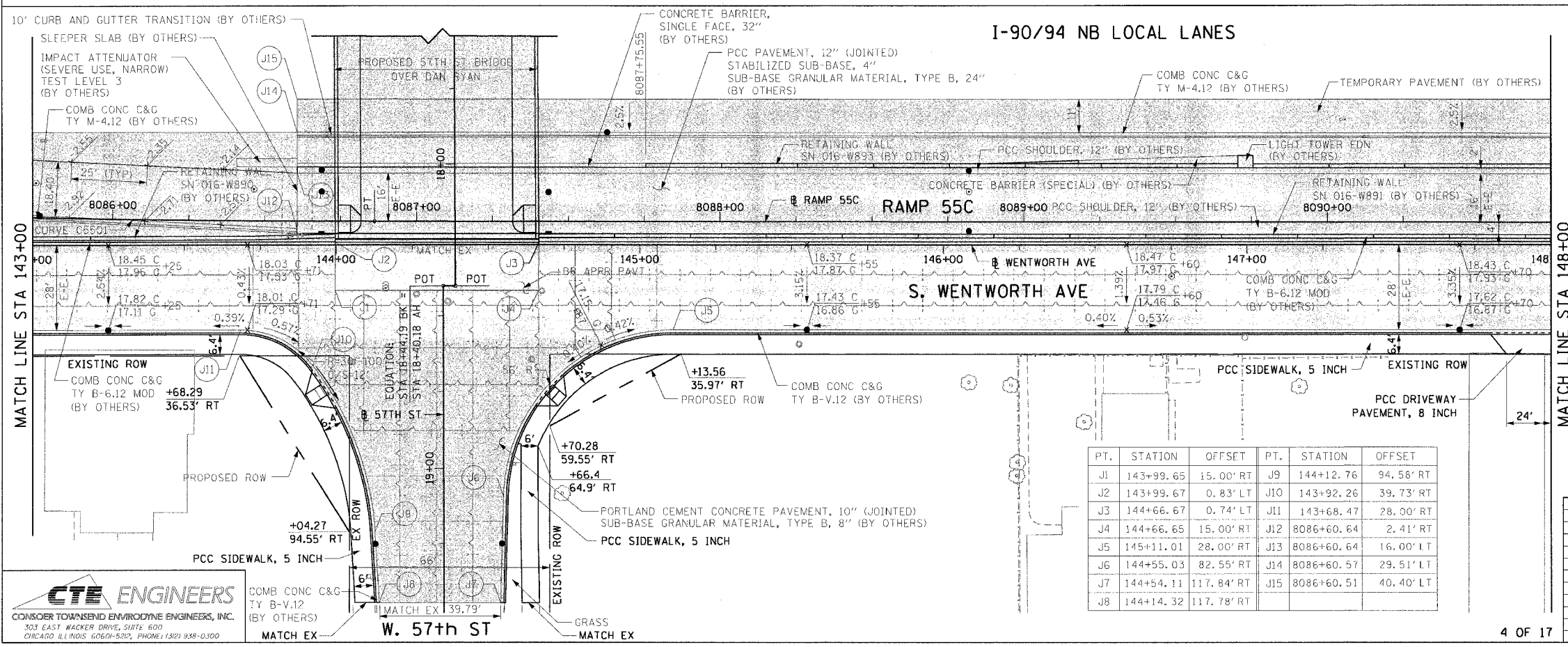

- LEGEND:
- WORK TO BE DONE BY OTHERS

- NOTES:
1. SEE CURB DETAIL ON SHEETS 38 AND 42.
 2. SEE SIDEWALK RAMP DETAIL ON SHEET 39.
 3. SEE SIDEWALK DETAIL ON SHEET 40.
 4. SEE DRIVEWAY DETAIL ON SHEET 41.

PT.	STATION	OFFSET	PT.	STATION	OFFSET
J1	143+99.65	15.00' RT	J9	144+12.76	94.56' RT
J2	143+99.67	0.83' LT	J10	143+92.26	39.73' RT
J3	144+66.67	0.74' LT	J11	143+68.47	28.00' RT
J4	144+66.65	15.00' RT	J12	8086+60.64	2.41' RT
J5	145+11.01	28.00' RT	J13	8086+60.64	16.00' LT
J6	144+55.03	82.55' RT	J14	8086+60.57	29.51' LT
J7	144+54.11	117.84' RT	J15	8086+60.51	40.40' LT
J8	144+14.32	117.78' RT			

REVISIONS	
NAME	DATE

ILLINOIS DEPARTMENT OF TRANSPORTATION
 F.A.I. 90/94 (DAN RYAN EXPRESSWAY)
 59th ST TO 47th ST (WENTWORTH AVE SIDEWALKS)

EXISTING AND PROPOSED ROADWAY PLANS
 WENTWORTH AVENUE

SCALE: 1"=20'
 DATE: MARCH 4, 2005

DRAWN BY: AMM/MRK
 CHECKED BY: JAL

CTE ENGINEERS
 CONROER TOWNSEND ENVIRONMENTAL ENGINEERS, INC.
 303 EAST WACKER DRIVE, SUITE 600
 CHICAGO, ILLINOIS 60601-5202, PHONE: (312) 938-0300